

# MAR 19690074: NORTHERN ALBERTA

Received date: Dec 31, 1969

Public release date: Jan 01, 1971

## **DISCLAIMER**

By accessing and using the Alberta Energy website to download or otherwise obtain a scanned mineral assessment report, you ("User") agree to be bound by the following terms and conditions:

- a) Each scanned mineral assessment report that is downloaded or otherwise obtained from Alberta Energy is provided "AS IS", with no warranties or representations of any kind whatsoever from Her Majesty the Queen in Right of Alberta, as represented by the Minister of Energy ("Minister"), expressed or implied, including, but not limited to, no warranties or other representations from the Minister, regarding the content, accuracy, reliability, use or results from the use of or the integrity, completeness, quality or legibility of each such scanned mineral assessment report;
- b) To the fullest extent permitted by applicable laws, the Minister hereby expressly disclaims, and is released from, liability and responsibility for all warranties and conditions, expressed or implied, in relation to each scanned mineral assessment report shown or displayed on the Alberta Energy website including but not limited to warranties as to the satisfactory quality of or the fitness of the scanned mineral assessment report for a particular purpose and warranties as to the non-infringement or other non-violation of the proprietary rights held by any third party in respect of the scanned mineral assessment report;
- c) To the fullest extent permitted by applicable law, the Minister, and the Minister's employees and agents, exclude and disclaim liability to the User for losses and damages of whatsoever nature and howsoever arising including, without limitation, any direct, indirect, special, consequential, punitive or incidental damages, loss of use, loss of data, loss caused by a virus, loss of income or profit, claims of third parties, even if Alberta Energy have been advised of the possibility of such damages or losses, arising out of or in connection with the use of the Alberta Energy website, including the accessing or downloading of the scanned mineral assessment report and the use for any purpose of the scanned mineral assessment report so downloaded or retrieved.
- d) User agrees to indemnify and hold harmless the Minister, and the Minister's employees and agents against and from any and all third party claims, losses, liabilities, demands, actions or proceedings related to the downloading, distribution, transmissions, storage, redistribution, reproduction or exploitation of each scanned mineral assessment report obtained by the User from Alberta Energy.

ECONOMIC MINERALS  
FILE REPORT No.  
S-AF-193(1)

FINAL REPORT ON SULPHUR EXPLORATION  
SULPHUR PROSPECTING PERMIT NO.193  
TWP. 111, 112, RGE. 9, 10 W5M

---

Sulphur Prospecting Permit No. 193 (39,680 acres) was acquired by Texaco Exploration on August 29, 1968. The sulphur potential was subsequently evaluated by testing of samples from 601 seismic shot holes drilled on the Permit. The shot holes varied in depth from 40 to 60 feet, were spaced along the seismic lines at intervals of 330 feet, and were sampled at ten foot intervals for a total of approximately 3,000 samples. Sulphur was detected in samples from two holes only - shot holes 96 and 106 on Line 6. As indicated on the accompanying map sulphur content ranged up to a maximum of only 0.46% which is too slight to be of significance. In view of the almost total lack of sulphur found it has been decided to surrender Permit No. 193.

TEXACO EXPLORATION COMPANY



W. H. Rimmer, Chief Geologist

TD/dl  
Attch.

Calgary, Alberta,  
April 29, 1969.

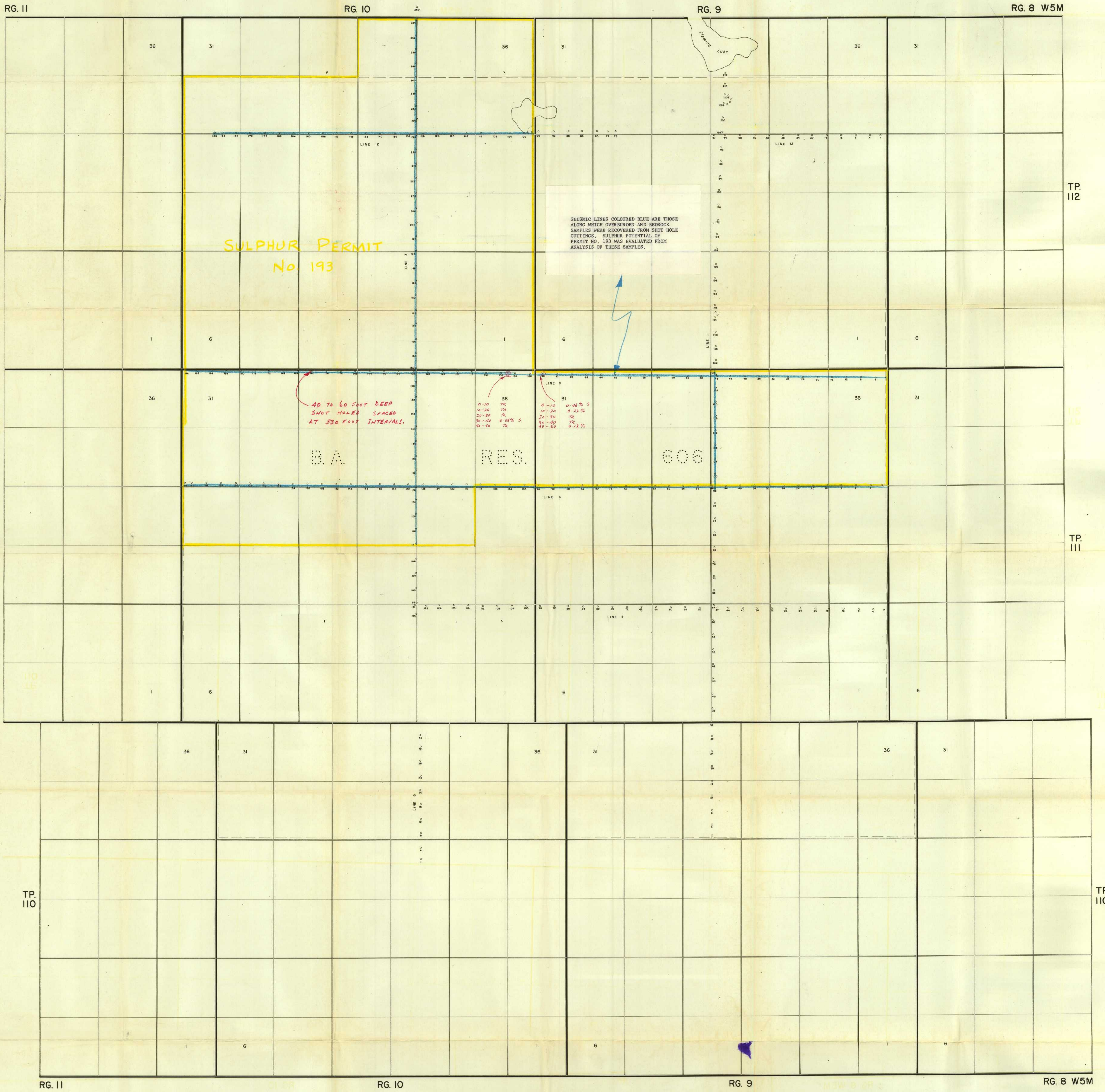

**SULPHUR EXPLORATION**  
**SULPHUR PROSPECTING PERMIT**  
 No. 193

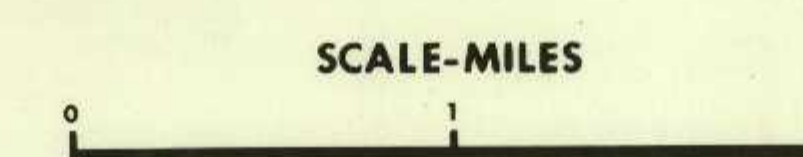

SEISMIC REFERENCE DATUM  
 SEISMIC REFERENCE METHOD

April 29, 1969.

TEXACO EXPLORATION COMPANY  
 DALLAS - HOUSTON - GULFPORT

# SULPHUR PROSPECTING PERMIT No. 193

TEXACO EXPLORATION COMPANY  
600 - 6th. AVENUE S.W.,  
CALGARY, ALBERTA.

DATE OF ISSUE - AUGUST 29, 1968  
AREA - 39,680 ACRES.

TP. II2

TP. III

TP. IIO

R. 10

R. 9

R. 8 W. 5 M.

845/  
11, 12+13  
NW