

MAR 19680067: NORTHERN ALBERTA

Received date: Dec 31, 1968

Public release date: Jan 01, 1970

DISCLAIMER

By accessing and using the Alberta Energy website to download or otherwise obtain a scanned mineral assessment report, you ("User") agree to be bound by the following terms and conditions:

- a) Each scanned mineral assessment report that is downloaded or otherwise obtained from Alberta Energy is provided "AS IS", with no warranties or representations of any kind whatsoever from Her Majesty the Queen in Right of Alberta, as represented by the Minister of Energy ("Minister"), expressed or implied, including, but not limited to, no warranties or other representations from the Minister, regarding the content, accuracy, reliability, use or results from the use of or the integrity, completeness, quality or legibility of each such scanned mineral assessment report;
- b) To the fullest extent permitted by applicable laws, the Minister hereby expressly disclaims, and is released from, liability and responsibility for all warranties and conditions, expressed or implied, in relation to each scanned mineral assessment report shown or displayed on the Alberta Energy website including but not limited to warranties as to the satisfactory quality of or the fitness of the scanned mineral assessment report for a particular purpose and warranties as to the non-infringement or other non-violation of the proprietary rights held by any third party in respect of the scanned mineral assessment report;
- c) To the fullest extent permitted by applicable law, the Minister, and the Minister's employees and agents, exclude and disclaim liability to the User for losses and damages of whatsoever nature and howsoever arising including, without limitation, any direct, indirect, special, consequential, punitive or incidental damages, loss of use, loss of data, loss caused by a virus, loss of income or profit, claims of third parties, even if Alberta Energy have been advised of the possibility of such damages or losses, arising out of or in connection with the use of the Alberta Energy website, including the accessing or downloading of the scanned mineral assessment report and the use for any purpose of the scanned mineral assessment report so downloaded or retrieved.
- d) User agrees to indemnify and hold harmless the Minister, and the Minister's employees and agents against and from any and all third party claims, losses, liabilities, demands, actions or proceedings related to the downloading, distribution, transmissions, storage, redistribution, reproduction or exploitation of each scanned mineral assessment report obtained by the User from Alberta Energy.

XERO COPY XERO COPY XERO COPY XERO COPY

REPORT ON FIELD EXAMINATION

NATIVE MINES LIMITED ^{ex}

SULPHUR PROSPECTING PERMIT NO. 72

NORTHERN ALBERTA

THIS REPORT HAS BEEN PREPARED
FOR THE EXCLUSIVE USE OF:

Native Mines Limited

COPY NO: 4

ECONOMIC MINERALS
FILE REPORT No.
S-AF-072(1)

REPORT ON FIELD EXAMINATION
NATIVE MINES LIMITED
SULPHUR PROSPECTING PERMIT NO. 72
NORTHERN ALBERTA

Prepared For
Native Mines Limited
November, 1968

J. C. SPROULE AND ASSOCIATES LTD.
OIL AND GAS ENGINEERING AND GEOLOGICAL CONSULTANTS

REPORT ON FIELD EXAMINATION

NATIVE MINES LIMITED

SULPHUR PROSPECTING PERMIT NO. 72

NORTHERN ALBERTA

The field work on this Permit has been carried out at the request of Mr. A.D. Houston acting for Native Mines Limited. The work was authorized under our letter agreement of May 30, 1968 and the request made was that J.C. Sproule & Associates Ltd. should collect representative near-surface samples as described in the pertinent paragraph of our May 30th letter. We quote:

"The field party would, upon arrival in the field, immediately check points of indicated interest that had become evident from the photogeological study. More specifically, we think that the preliminary study will give us a good idea of all those areas that are likely to contain sulphur. All points where sulphur is likely to occur will be checked by the helicopter reconnaissance crew and hand specimens and/or auger samples taken to determine the presence or absence of sulphur. We might call this preliminary part of the field program Step 1 of Phase II. The total cost of Step 1 would be about \$800."

The field work has been conducted by Mr. N. Soul. The field notes describing the samples taken are as follows. We quote:

"Permit No. 72

Area No. 1

Hole No. 1 - S.E. 16-108-1 W. 5 M. Depth, 8 feet.

<u>Sample No.</u>	<u>Depth</u> Ft.	<u>Sulphur</u> %	<u>Sample</u>
72-1-1	4	Trace	Bluish grey clay, <u>sulphurous odour.</u>
72-1-1	8	Trace	Bluish grey clay, <u>sulphurous odour.</u>

Area No. 2

Hole No. 1 - S.E. 30-108-1 W. 5 M. Depth, 8 feet.

<u>Sample No.</u>	<u>Depth</u> Ft.	<u>Sulphur</u> %	<u>Sample</u>
72-2-1	4	25.15	Black muck, <u>slight</u> <u>sulphurous odour.</u>
72-2-1	8	23.00	Bluish grey clay.

Area No. 3

Hole No. 1 - S.W. 32-108-1 W. 5 M. Depth, 8 feet.

<u>Sample No.</u>	<u>Depth</u> Ft.	<u>Sulphur</u> %	<u>Sample</u>
72-3-1	4	33.46	Black muck
72-3-1	8	77.13	Bluish grey clay.

Area No. 4

Hole No. 1 - S.E. 2-109-2 W. 5 M. Depth, 8 feet.

<u>Sample No.</u>	<u>Depth</u> Ft.	<u>Sulphur</u> %	<u>Sample</u>
72-4-1	4	20.74	Muskeg and lacustrine
72-4-1	8	Trace	Muskeg and lacustrine

Area No. 4 (Continued)

Hole No. 2 - S.W. 10-109-2 W. 5 M. Depth, 8 feet.

<u>Sample No.</u>	<u>Depth</u> Ft.	<u>Sulphur</u> %	<u>Sample</u>
72-4-2	4	Trace	Muskeg and lacustrine
72-4-2	8	100.00	Muskeg and lacustrine

Hole No. 3 - N.W. 15-109-2 W. 5 M. Depth, 8 feet.

<u>Sample No.</u>	<u>Depth</u> Ft.	<u>Sulphur</u> %	<u>Sample</u>
72-4-3	4	Trace	Grey sandy clay
72-4-3	8	Trace	Grey sandy clay

Hole No. 4 - S.W. 13-109-2 W. 5 M. Depth, 7 feet.

<u>Sample No.</u>	<u>Depth</u> Ft.	<u>Sulphur</u> %	<u>Sample</u>
72-4-4	4	Trace	Greyish brown clay
72-4-4	7	Trace	Greyish brown clay

Hole No. 5 - S.W. 23-109-2 W. 5 M. Depth, 8 feet.

<u>Sample No.</u>	<u>Depth</u> Ft.	<u>Sulphur</u> %	<u>Sample</u>
72-4-5	4	24.14	Grey clay
72-4-5	8	Trace	Grey clay

Area No. 5

Hole No. 1 - N.E. 28-109-2 W. 5 M. Depth, 8 feet.

<u>Sample No.</u>	<u>Depth</u> Ft.	<u>Sulphur</u> %	<u>Sample</u>
72-5-1	4	0.05	Brown sandy clay
72-5-1	8	Trace	Brown sandy clay"

The sample locations are given on the accompanying Figure 1 and the related analyses by Chemical and Geological Laboratories Ltd. constitutes Appendix I attached hereto.

Of the nine auger holes drilled on the subject Permit, five show sulphur percentages in excess of 20 percent from samples taken at four feet and eight feet. The material penetrated was black muck, clay and muskeg debris. With reference to these results, it should be noted that the auger holes were located within individual areas of interest which are distributed over the entire Permit.

Under the circumstances, we recommend that Sulphur Prospecting Permit No. 72 be renewed in its entirety and that additional geological evaluation be carried out as described in Step 2 of Phase II of our letter agreement of May 30, 1968.

We will be pleased to submit an estimate of the cost of conducting an adequate exploration sampling program over the area recommended for retention at such time as a complete analysis of costs and performance of the past season's operations have been completed.

V.A. Farley.

J.C. Sproule, R. Geol.

1009 Fourth Avenue S.W.,
Calgary 2, Alberta.
VAF:JCS:ldl

CHEMICAL & GEOLOGICAL LABORATORIES LTD.



OPERATOR: J. C. SPROULE AND ASSOCIATES LTD.

REPORT NUMBER: C68-4065

DATE SAMPLED: ---

DATE RECEIVED September 18, 1968

DATE REPORTED September 27, 1968

Kind of Sample: Soil for Sulphur Analysis.

LABORATORY NUMBER	SAMPLE NUMBER	DEPTH (Feet)	SULPHUR	
			(% by Weight) Dry Sample	(% by Weight) Wet Sample
C68-4065-1	72-1-1	8	Trace	Trace
C68-4065-2	72-2-1	8	23.00	3.97
C68-4065-3	72-3-1	8	77.13	7.67
C68-4065-4	72-4a-5	8	Trace	Trace
C68-4065-5	72-4c-4	7	Trace	Trace
C68-4065-6	72-4d-1	8	Trace	Trace
C68-4065-7	72-4e-2	8	100.00	13.53
C68-4065-8	72-4f-3	8	Trace	Trace
C68-4065-9	72-5-1	8	Trace	Trace

CHEMICAL & GEOLOGICAL LABORATORIES LTD.

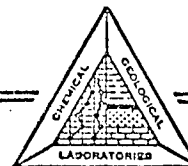

14240-118 AVENUE, EDMONTON, ALBERTA

Date Reported: October 29, 1968 Laboratory Report Number: C68-4213-8J. C. SPROULE & ASSOCIATES LTD.

Kind of Sample: Soil

Date Received: October 18, 1968

<u>SAMPLE NUMBER</u>	<u>DEPTH IN FEET</u>	<u>ELEMENTAL SULFUR (% by Weight on Dry Sample)</u>
72-1-1	4	Trace
72-2-1	4	25.15
72-3-1	4	33.46
72-4a-5	4	24.14
72-4c-4	4	Trace
72-4d-1	4	20.74
72-4E-2	4	Trace
72-4F-3	4	Trace
72-5-1	4	0.05

19680067

SULPHUR PROSPECTING PERMIT NO. 72

CANCELLED

LORNE ANDREW PEARCE,
501 — STERLING BLDG.,
REGINA, SASKATCHEWAN.

DATE OF ISSUE — JANUARY 2, 1968
AREA — 19,840 ACRES.

NO LEASES SELECTED

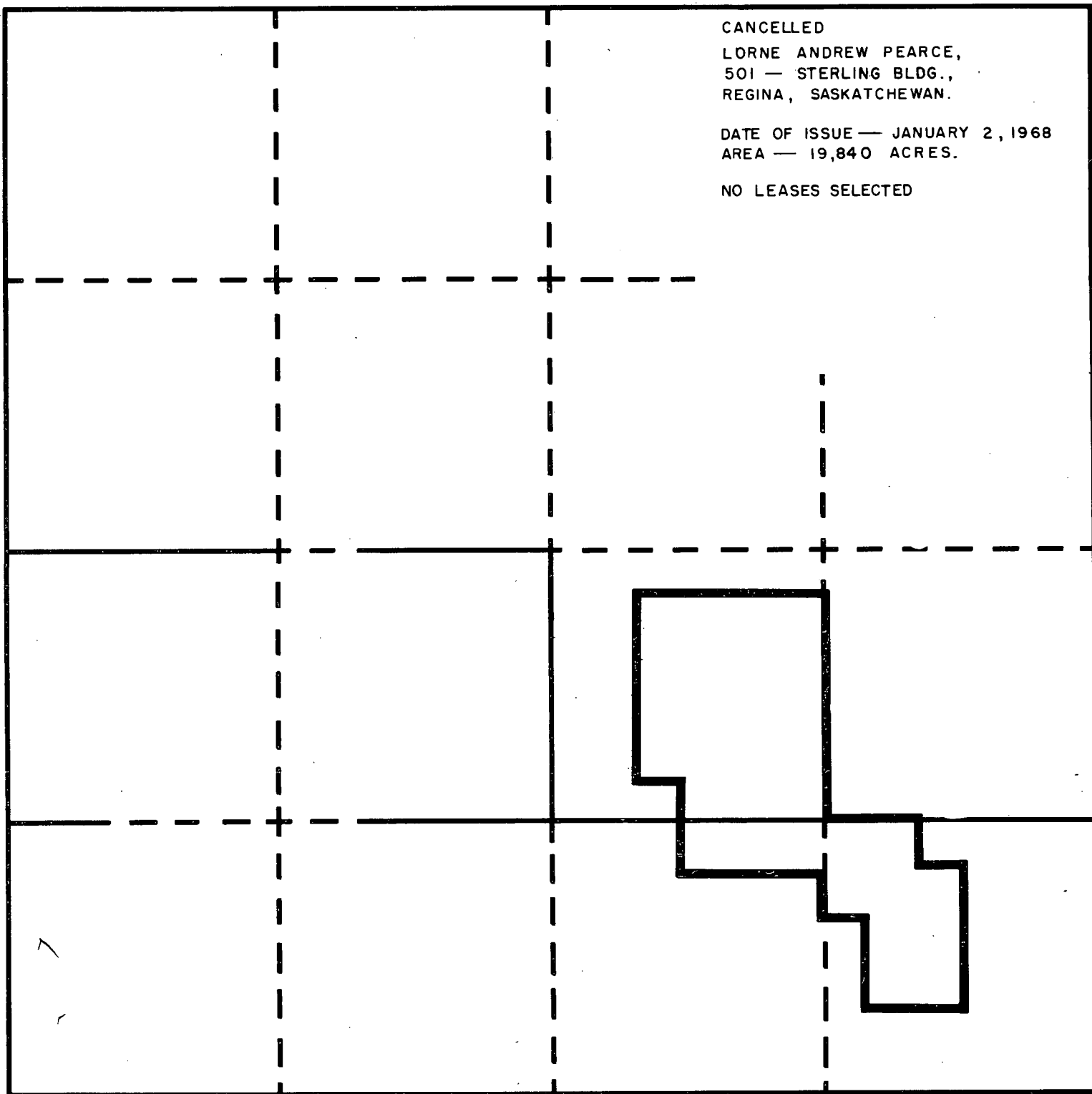

TP.109

845/8

TP.108

R. 2

R. 1 W. 5 M.