

MAR 19680033: NORTHERN ALBERTA

Received date: Dec 31, 1968

Public release date: Jan 01, 1970

DISCLAIMER

By accessing and using the Alberta Energy website to download or otherwise obtain a scanned mineral assessment report, you ("User") agree to be bound by the following terms and conditions:

- a) Each scanned mineral assessment report that is downloaded or otherwise obtained from Alberta Energy is provided "AS IS", with no warranties or representations of any kind whatsoever from Her Majesty the Queen in Right of Alberta, as represented by the Minister of Energy ("Minister"), expressed or implied, including, but not limited to, no warranties or other representations from the Minister, regarding the content, accuracy, reliability, use or results from the use of or the integrity, completeness, quality or legibility of each such scanned mineral assessment report;
- b) To the fullest extent permitted by applicable laws, the Minister hereby expressly disclaims, and is released from, liability and responsibility for all warranties and conditions, expressed or implied, in relation to each scanned mineral assessment report shown or displayed on the Alberta Energy website including but not limited to warranties as to the satisfactory quality of or the fitness of the scanned mineral assessment report for a particular purpose and warranties as to the non-infringement or other non-violation of the proprietary rights held by any third party in respect of the scanned mineral assessment report;
- c) To the fullest extent permitted by applicable law, the Minister, and the Minister's employees and agents, exclude and disclaim liability to the User for losses and damages of whatsoever nature and howsoever arising including, without limitation, any direct, indirect, special, consequential, punitive or incidental damages, loss of use, loss of data, loss caused by a virus, loss of income or profit, claims of third parties, even if Alberta Energy have been advised of the possibility of such damages or losses, arising out of or in connection with the use of the Alberta Energy website, including the accessing or downloading of the scanned mineral assessment report and the use for any purpose of the scanned mineral assessment report so downloaded or retrieved.
- d) User agrees to indemnify and hold harmless the Minister, and the Minister's employees and agents against and from any and all third party claims, losses, liabilities, demands, actions or proceedings related to the downloading, distribution, transmissions, storage, redistribution, reproduction or exploitation of each scanned mineral assessment report obtained by the User from Alberta Energy.

ECONOMIC MINERALS
FILE REPORT No.
S-AF-018(1)

PRELIMINARY GEOLOGICAL REPORT
SULPHUR PROSPECTING PERMIT NO. 18
NORTHERN ALBERTA

Prepared For
Alaska Canadian Corporation
January, 1968

J. C. SPROULE AND ASSOCIATES LTD.
OIL AND GAS ENGINEERING AND GEOLOGICAL CONSULTANTS

1009 FOURTH AVENUE WEST
CALGARY - ALBERTA

TELEPHONE
269-7951

INDEXING DOCUMENT NO. 700315

TABLE OF CONTENTS

	<u>Page</u>
INTRODUCTION	1
DESCRIPTION OF PROPERTY	2
LOCATION, ACCESS AND TOPOGRAPHY	2
MODE OF OCCURRENCE OF SULPHUR IN RELATIONSHIP TO GENERAL GEOLOGY	2
SUMMARY AND CONCLUSIONS	3

ILLUSTRATION

Figure 1 - Map of North-Central Alberta showing Alaska
Canadian Corporation Sulphur Permit. with
reference to Regional Surface Geology and
Permits held by others

After p. 4

PRELIMINARY GEOLOGICAL REPORT

SULPHUR PROSPECTING PERMIT NO. 18

NORTHERN ALBERTA

INTRODUCTION

This report has been prepared at the request of Mr. P.A. Schwerdt, acting for Alaska Canadian Corporation, hereinafter referred to as the "Company."

Sulphur occurrences have been reported from many points in northern Alberta and the adjacent Northwest Territories over a period of at least a century. Such sulphur shows have taken various forms including small deposits around springs and gas seeps (also "smoke" or "steam" escapes), thin stringers, beds and cavity infillings in various types of strata. Finely disseminated sulphur is also present as an appreciable minor constituent in many shale deposits and in the well-known Athabasca Oil Sands. Until recently, it had been assumed that such sulphur deposits were uneconomic. The current world-wide shortage of this mineral, however, plus the vastly increased sulphur prices over the last decade, has helped to change the Industry's attitude toward such deposits. It is also pertinent that Industry, in general, had not previously known of the existence of these deposits.

Under the present conditions, the earlier scattered reports of sulphur shows in northern Alberta have suddenly become significant. During recent months, mainly as the result of a show of sulphur encountered on what is now Sulphur Prospecting Permit No. 8, many Sulphur Prospecting Permits have been issued to a number of persons and companies and many other Permit applications are presently being processed by the Alberta authorities. Several major oil and chemical companies have taken up Sulphur Prospecting Permits in the play and others are rumoured to be making deals with smaller companies, or individuals, now holding Permits.

The present report presents the results of an investigation of publicly available information relating to the Company's Permit No. 18 and surrounding areas. Sulphur Prospecting Permit No. 18 was examined in the field by senior geologists of J. C. Sproule and Associates Ltd. who also confirmed the occurrence of sulphur on the adjoining "discovery" Permit, which is Sulphur Prospecting Permit No. 8.

DESCRIPTION OF PROPERTY

The holdings under consideration, as presented to us, are as follows:

<u>Permit No.</u>	<u>Location</u>	<u>Total Acreage</u>
18	Township 109, Ranges 4 and 5, W. 5 M.	19,840

The above Permit is 100 percent owned by the Company and is subject only to normal Government Royalty.

Although the information on this property, as given to us by the Company, has been accepted as correct, we have made no investigation of our own as to the legal title or the interests held.

LOCATION, ACCESS AND TOPOGRAPHY

Permit No. 18 is in the general Fort Vermilion region. The town of Fort Vermilion is located approximately 350 miles north-northwest of Edmonton and is about 45 miles by road east of the town of High Level, which is served by both the Mackenzie Highway and the Great Slave Lake Railway. The location and outline of the Company Permit is shown on the accompanying map, Figure 1.

Sulphur Prospecting Permit No. 18 is located 42 miles due east of Fort Vermilion and 6 miles south of Highway No. 58. It is of particular significance that this Permit is adjacent to the "discovery" Permit (No. 8) and lies between the latter and the Peace River. Permit No. 18 lies between the Peace River and the south side of the Caribou Mountains, and has a relatively flat terrain and, although it has drainage from all parts, the prevalence of muskeg bears witness to its imperfect drainage. There are scattered patches of black spruce and other evergreen and deciduous trees between muskeg areas. Summer travel will be difficult.

MODE OF OCCURRENCE OF SULPHUR IN RELATIONSHIP TO GENERAL GEOLOGY

Within the general area of interest the principal outcropping bedrock is of Cretaceous age, but, in the northeast portion, particularly in the valleys of the Peace River and Mikkwa River, erosion has stripped off the Cretaceous beds, exposing the older Devonian. The Devonian, as well as the overlying Cretaceous rocks, are generally inclined gently westward into the Alberta syncline so that progressively younger rocks of both Paleozoic and Mesozoic ages are at the surface in that direction. Surface outcrops of both Paleozoic and Cretaceous ages are widespread but not numerous. Very little has been published on them, doubtless because they have not previously appeared to have economic significance.

The bedrock, whether of Devonian or Cretaceous age, is overlain by a variable thickness of glacial and related sediments. The thickness of the glacial beds varies from zero to several hundred feet. The thickness is naturally least in those areas where river valleys are deeply incised.

It is, at this time, not clear to what extent the sulphur is developed in superficial deposits and to what extent it is present with the stratified deposits of the Cretaceous and/or Devonian, but it is believed that both types of occurrence may exist.

With direct reference to the lands under consideration, the sulphur occurrence of most immediate interest is located in Sulphur Prospecting Permit No. 8 (the "discovery" Permit), which is adjacent to the Company's Permit No. 18.

The known deposit on Sulphur Prospecting Permit No. 8 appears to be mainly superficial, in the form of lacustrine sediments. It is reported that several pits have been dug and approximately 160 shallow power-auger holes have been drilled, defining a sulphur body measuring 1,400 feet by 1,400 feet. The full thickness and outline of this deposit has yet to be determined. Samples from one of the pits were collected in the field by J. W. Bakhoven, P. Geol., of J. C. Sproule and Associates Ltd. Sulphur assays of these samples range between 62 percent to 70 percent.

At the present time, Bow Valley Industries, the Operator of Sulphur Prospecting Permit No. 8, is undertaking an evaluation of this deposit but the information from such investigations is confidential.

In the above comments on mode of occurrence, we have avoided discussion of theories of origin because of the large number of presently uncertain factors in this new area. Studies in the area are, however, likely to yield substantial information over the coming field season. Meanwhile, theories of origin from Paleozoic connate waters, or from bedded Devonian and other gypsum and anhydrite deposits, are of principal interest. The origin and manner of occurrence of sulphur deposits are of prime importance since these factors will determine whether or not sulphur can be mined at the surface or by stripping, or must be taken from deeper strata by the Frasch process.

SUMMARY AND CONCLUSIONS

Alaska Canadian Corporation has acquired Sulphur Prospecting Permit No. 18. This Permit, totalling 19,840 acres, is 100 percent Company owned, subject only to normal Crown Royalty.

The Permit is in an area where active interest has been shown by a number of companies, including large sulphur producers and users.

The initial discovery of sulphur in this area was made on Sulphur Prospecting Permit No. 8. The occurrence of sulphur in this Permit has been confirmed by senior geologists of J. C. Sproule and Associates Ltd. It is significant that Permit No. 8 lies adjacent to Company Permit No. 18.

The origin, or origins, of the sulphur occurrences in the general Fort Vermilion area is not known at this time. On the basis of our general knowledge of sulphur occurrence and our specific knowledge of the area, we believe, however, that the best prospects are in areas where Devonian beds are at or near the surface. From this point of view, Permit No. 18 is particularly favourably located.

Access to Sulphur Prospecting Permit No. 18 is by way of Highway No. 58. From the standpoint of local terrain, Permit No. 18 is relatively poorly drained with substantial percentages of muskeg and fair prospects for certain types of sulphur occurrence.

It is recommended that a detailed photogeological study of the Permit and adjacent areas be undertaken. Every effort should be made to acquire and analyze pertinent information on sulphur occurrences in Alberta. Subsurface data, including logs and samples from wells in the vicinity of the Permits, should be studied. The cost of the preliminary work should be a maximum of \$600.

These photogeological and related preliminary studies will provide a useful background for the field geological studies that should cost a maximum of \$3,500. Such work would include the field operations of a geological party operating on and around the Permit concerned during the summer field season. The field operations would involve a ground check of the observations made during the photogeological study as well as of rock outcrops and related geological indications. A certain amount of surface and auger test sampling would also be involved. The party concerned would move into the area by truck and conduct work within the area by helicopter and ground traverse.

Assuming further work is then justified on a basis of the geological operations described above, it is estimated that a field drilling program, using a portable drill, would cost an approximate \$6,000 for Permit No. 18.

This report has been prepared for the exclusive use of Alaska Canadian Corporation and is not to be reproduced in whole or in part without the written permission of J. C. Sproule and Associates Ltd.

V. A. Farley

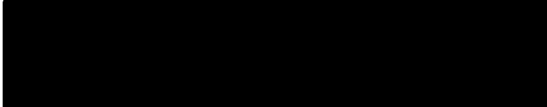

J. C. Sproule, P. Geol.

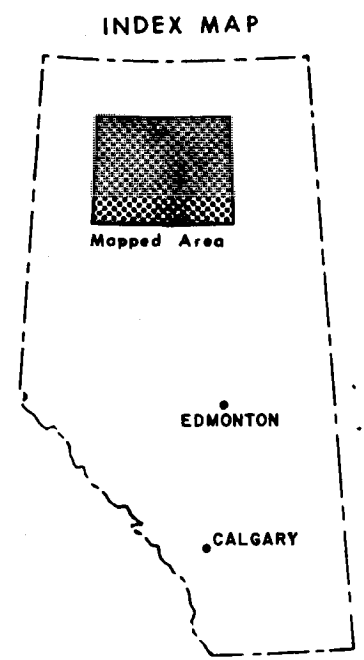
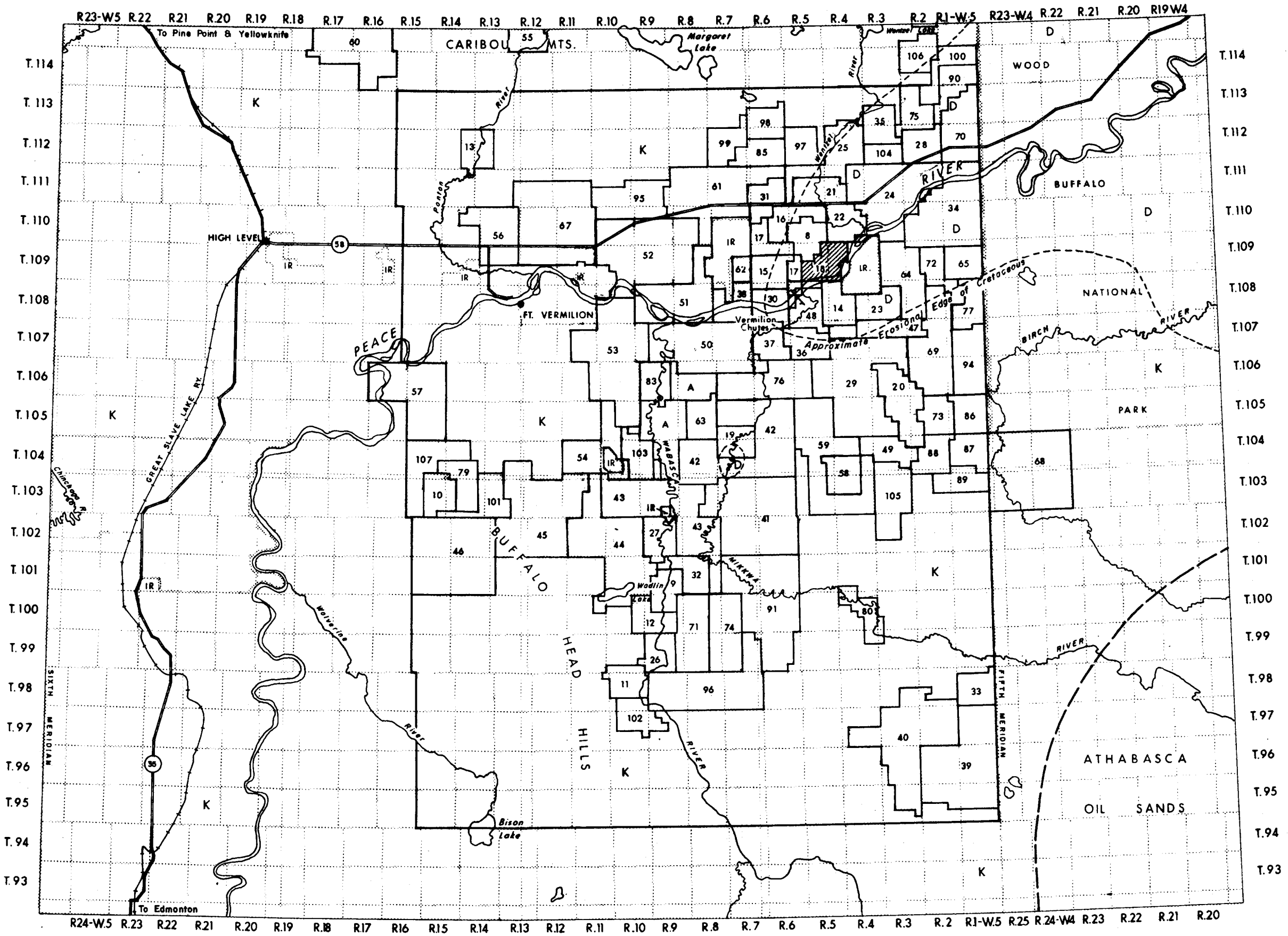
1009 Fourth Avenue S.W.,
Calgary, Alberta.
January 26, 1968.
JCS/VAF/fc

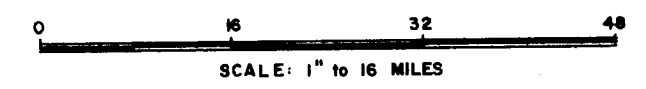

- LEGEND**
- K Cretaceous Formations
 - D Devonian Formations
 - 17 Sulphur Prospecting Permit
 - A Permit Applied For
 - Alaska Canadian Corporation Permit
 - Outline of Area of Major Current Interest

NORTH - CENTRAL ALBERTA
 showing
ALASKA CANADIAN CORPORATION SULPHUR PERMITS
 with reference to
REGIONAL SURFACE GEOLOGY AND PERMITS HELD BY OTHERS



Permits as Published to January 22, 1968

19680033

SULPHUR PROSPECTING PERMIT No. 18

CABLE BOVILLE CLARK,
% BECKER, WEEKS, PETERSON, CLARK
FRASER & ROUT,
3rd FLOOR, GUARANTY TRUST BLDG.,
100th STREET and JASPER AVENUE
EDMONTON, ALBERTA

DATE OF ISSUE — NOVEMBER 10, 1967
AREA — 19,840 ACRES

[84J/7]

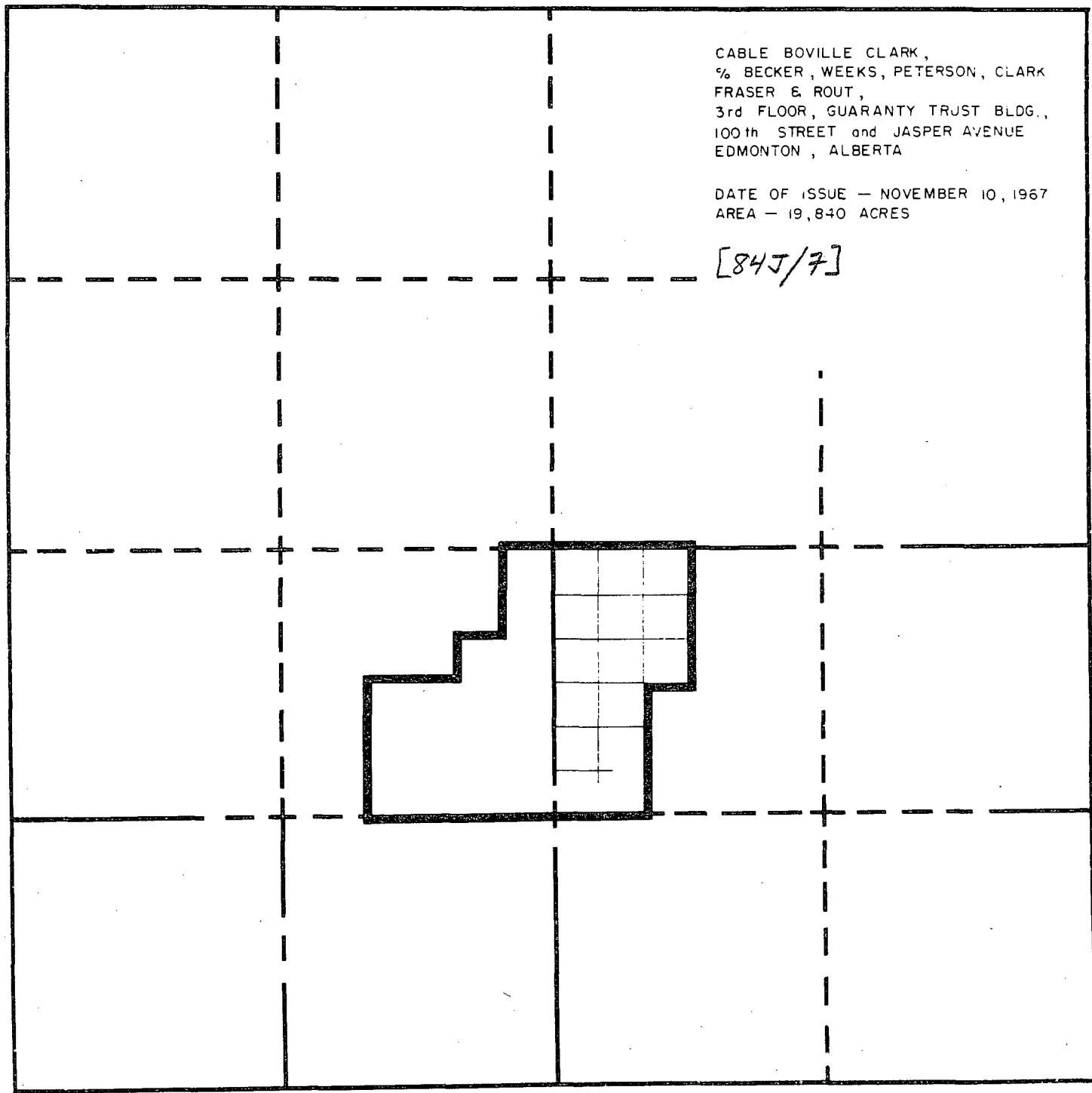

TP. 109

TP. 108

R. 5

R. 4

R. 3 W. 5 M.