

MAR 19600003: CENTRAL ALBERTA

Received date: Dec 31, 1960

Public release date: Jan 01, 1962

DISCLAIMER

By accessing and using the Alberta Energy website to download or otherwise obtain a scanned mineral assessment report, you ("User") agree to be bound by the following terms and conditions:

- a) Each scanned mineral assessment report that is downloaded or otherwise obtained from Alberta Energy is provided "AS IS", with no warranties or representations of any kind whatsoever from Her Majesty the Queen in Right of Alberta, as represented by the Minister of Energy ("Minister"), expressed or implied, including, but not limited to, no warranties or other representations from the Minister, regarding the content, accuracy, reliability, use or results from the use of or the integrity, completeness, quality or legibility of each such scanned mineral assessment report;
- b) To the fullest extent permitted by applicable laws, the Minister hereby expressly disclaims, and is released from, liability and responsibility for all warranties and conditions, expressed or implied, in relation to each scanned mineral assessment report shown or displayed on the Alberta Energy website including but not limited to warranties as to the satisfactory quality of or the fitness of the scanned mineral assessment report for a particular purpose and warranties as to the non-infringement or other non-violation of the proprietary rights held by any third party in respect of the scanned mineral assessment report;
- c) To the fullest extent permitted by applicable law, the Minister, and the Minister's employees and agents, exclude and disclaim liability to the User for losses and damages of whatsoever nature and howsoever arising including, without limitation, any direct, indirect, special, consequential, punitive or incidental damages, loss of use, loss of data, loss caused by a virus, loss of income or profit, claims of third parties, even if Alberta Energy have been advised of the possibility of such damages or losses, arising out of or in connection with the use of the Alberta Energy website, including the accessing or downloading of the scanned mineral assessment report and the use for any purpose of the scanned mineral assessment report so downloaded or retrieved.
- d) User agrees to indemnify and hold harmless the Minister, and the Minister's employees and agents against and from any and all third party claims, losses, liabilities, demands, actions or proceedings related to the downloading, distribution, transmissions, storage, redistribution, reproduction or exploitation of each scanned mineral assessment report obtained by the User from Alberta Energy.

FINAL REPORT

LETTER OF PRIVILEGE TO EXPLORE FOR

BENTONITE

ISSUED TO

BAROID OF CANADA, LTD.

OPERATING UNDER

PERMIT NO. 198

LICENSE NO. 2334

March 20, 1961

Thomas A. Studer

19600003

Final Report

In accordance with the terms and conditions set out by the department of Mines and Minerals covering Expiration of Letter of Privilege, I herewith submit the following report. The lands held under the Letter of Privilege are described as follows:

Section 32, NW & SE Quarters of Section 33, Section 34 in Township 55, Range 2, West 5th.

South $\frac{1}{2}$ & NW $\frac{1}{4}$ of Section 4, South $\frac{1}{2}$ & NW $\frac{1}{4}$ of Section 5, Sections 6, 9, 16, South Section 17, SE $\frac{1}{4}$ of Section 18 & Section 19 & 20 in Township 56, Range 2, West 5th.

The lands drilled under this Letter of Privilege, drill hole maps of which are enclosed, are described as follows:

#1 NE 34, Tp 55, R 2, W 5.	NW 33, Tp 55, R 2, W 5. #13
#2 LSD 11, 14, Sec. 32, Tp 55, R 2, W 5.	SE 32, Tp 55, R 2, W 5. #14
#3 SW 32, Tp 55, R 2, W 5.	SE 32, Tp 55, R 2, W 5. #15
#4 SE 6, Tp 56, R 2, W 5.	SW 6, Tp 56, R 2, W 5. #16
#5 NE 6, Tp 56, R 2, W 5.	NW 19, Tp 56, R 2, W 5. #17
#6 SW 19, Tp 56, R 2, W 5.	SE 19, Tp 56, R 2, W 5. #18
#7 NW 9, Tp 56, R 2, W 5.	NW 4, Tp 56, R 2, W 5. #19
#8 SW 9, Tp 56, R 2, W 5.	SE 9, Tp 56, R 2, W 5. #20
#9 SE 17, Tp 56, R 2, W 5.	SW 16, Tp 56, R 2, W 5. #21
#10 NW 16, Tp 56, R 2, W 5.	NE 20, Tp 56, R 2, W 5. #22
#11 SE 20, Tp 56, R 2, W 5.	SW 20, Tp 56, R 2, W 5. #23
#12 SE 18, Tp 56, R 2, W 5.	

missing!!!

The remaining lands were not drilled due such reasons as lands being under cultivation, permission to enter not obtainable from land owners, weather and soil conditions. Much of the land not drilled was covered by muskeg and extremely dense tree and underbrush growth.

Bentonite in this area was deposited as a delta deposition of varying amounts and lamination thicknesses, all of which occurred in the Edmonton Formation, Upper Cretaceous Period of the Mesozoic Era during periods of volcanic and glacier activity.

No standard exploratory procedures could be employed in the search for bentonite in these lands. All drilling was done to depths of twenty or more feet with interval spacing generally fifty feet or more, depending on conditions at the site. Numerous small traces of

bentonite were found but none was over twelve inches in thickness and these were not extended to the next drill hole.

Test work on the samples taken indicated a very low quality bentonite due mainly to co-mingling of the outer surface of the lenses with sedimentary top soil and forest decay. This condition also prevails on larger and thicker lenses but is removed during mining operation.

Exploratory drilling was conducted the year round with the use of a Parmanco drill. A fairly successful attempt was made to drill out the cultivated lands during the winter months thus preventing any damage to the top soil.

No discovery of a commercial quantity of bentonite was found on any of the lands drilled.

The accompanying maps of all lands drilled under this reservation have been marked to show the following information :

1. Drill hole location to scale.
2. Drill hole identification number.
3. Drill hole depth and thickness of bentonite when located.

Respectfully submitted.

Thomas A. Studer.

○ 4182

○ 4178

○ 4179

○ 4158

○ 4161

Δ L

○ 4167

○ 4159

○ 4162

* K Δ 4171

○ 4180

○ 4176

○ 4163

Δ C

Δ J

○ 4175

○ 4173

○ 4174

○ 4164

Δ I

Δ D

○ 4172

○ 4171

○ 4165

Δ E

* H Δ 4170

○ 4166

Δ F

○ 4168

Δ G

○ 4167

○ 4169

BAROID OF CANADA LTD.

DRILL HOLE MAP

PERMIT NO. 198.
LICENCE NO. 2 2 4 9

N.E. 1/4 SEC. 34, T. 55, R. 2, W. 5TH.
ALBERTA, CANADA.

SCALE - 1" = 100' JANUARY, 1960.

locations only 19570015

19600003 #1

△A

○4227
△F"

○4228

○4230
△E

○4231

○4232

○4233

D'△4234

○4235

○4239

○4238

○4237

○4236

△C"

○4240

B'△4241

○4242

○4243

BAROID OF CANADA LTD.

PERMIT NO. 198.
LICENCE NO. 2249.

DRILL HOLE MAP

L.S.D. 11-14; N.W. 1/4 SEC. 32, T.55, R.2, W.5TH.

ALBERTA, CANADA.

SCALE - 1" = 100' JANUARY, 1960.

locations only

135700-15

17600003 #2

△A

○4260

○4261

○4262

○4267

○4263

○4266

○4264

○4259

○4265

△B

○4258

○4257

○4256

○4255

"C" △4254

○4253

○4268

○4272

○4271

○4270

○4269

BAROID OF CANADA LTD.

PERMIT NO. 198
LICENCE NO. 2249

DRILL HOLE MAP
S.W. 1/4 SEC. 32, T. 55, R. 2, W. 5TH.
ALBERTA, CANADA.
SCALE - 1" = 100', FEBRUARY 1960.

located only

1520015

18600003 #3

Q4420
T-12

Q4421

Q4422

Q4423

Q4424

Q4425

Q4426

Q4427

Q4428

Q4429
T-12

PERMIT NO. 198
LICENCE NO. 2334

BAROID OF CANADA LTD.
DRILL HOLE MAP

N.E. 1/4 SEC. 6, T. 56, R. 2, W. 5TH.

ALBERTA, CANADA.

SCALE - 1" = 100' MAY, 1960.

19600003 #5
4570015

PERMIT NO. 198.
LICENCE NO. 2334.

BAROID OF CANADA LTD.
DRILL HOLE MAP
SW. 1/4 SEC 19, T. 56, R. 2, W. 5TH
ALBERTA, CANADA
SCALE: 1" = 100' JUNE, 1960

locations only

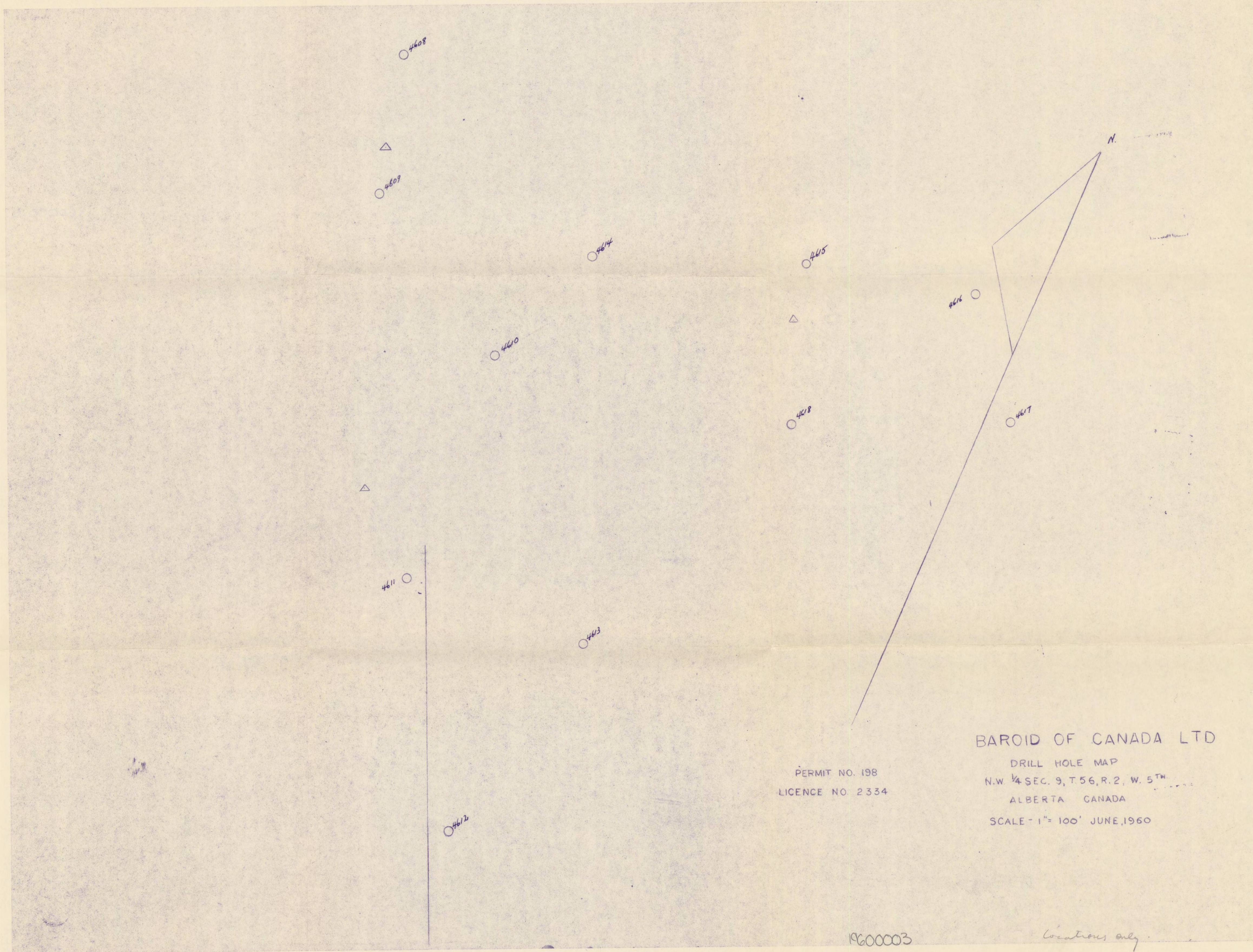

PERMIT NO. 198
LICENCE NO. 2334

BAROID OF CANADA LTD

DRILL HOLE MAP
N.W. 1/4 SEC. 9, T.56, R.2, W. 5TH
ALBERTA CANADA
SCALE - 1" = 100' JUNE, 1960

19600003

#7

Locations only.

START

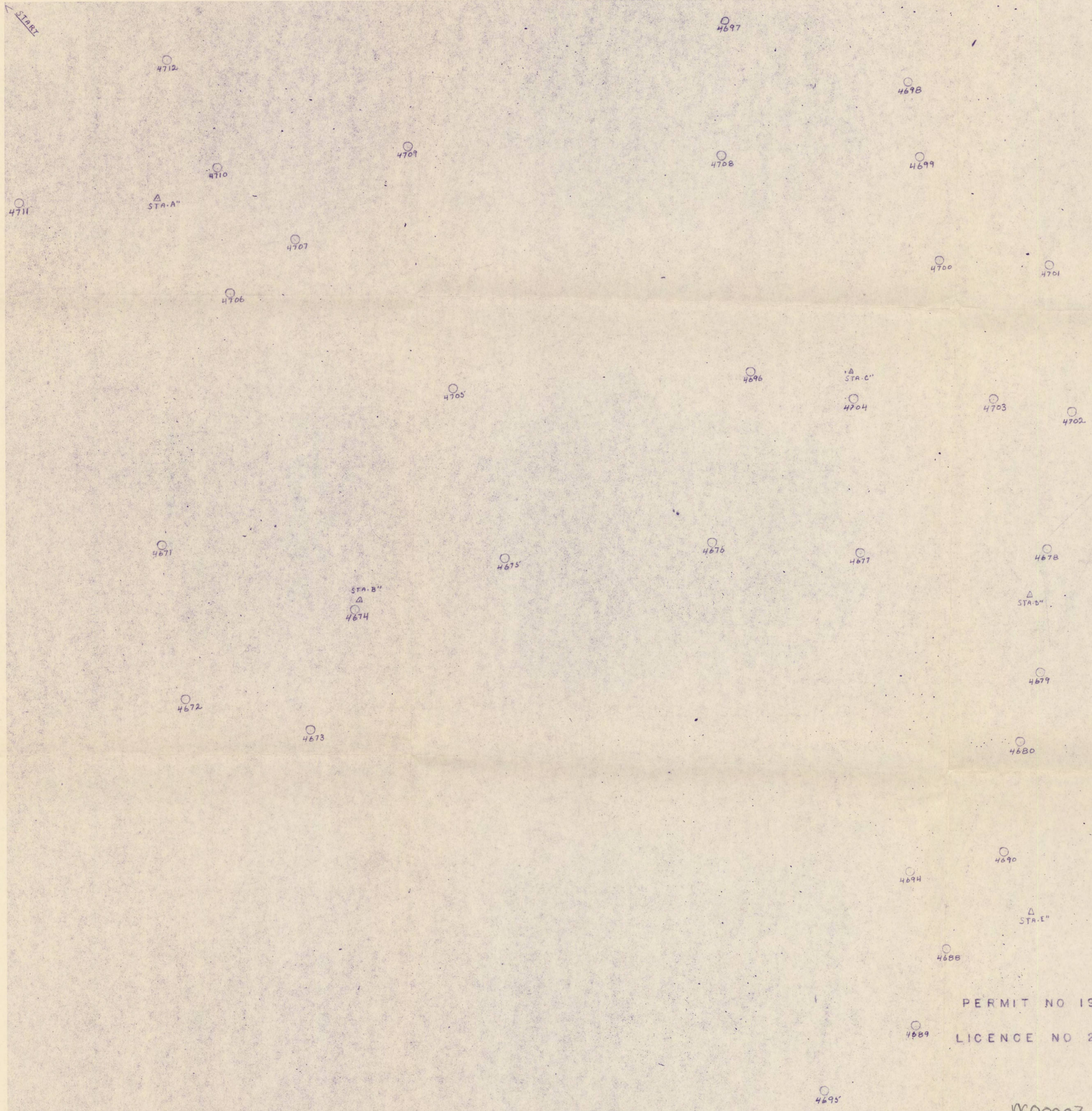

BAROID OF CANADA LTD.

DRILL HOLE MAP

SW 1/4 SEC 9 T56 R2 W5

ALBERTA CANADA

SCALE - 1" = 150', NOVEMBER 1960

PERMIT NO 198

LICENCE NO 2334

16000003 #8

drill hole locations only

PERMIT NO 198.
LICENCE NO 2334.

BAROID OF CANADA, LTD
"DRILL HOLE MAP"
S.E. 1/4 SEC. 17, T. 56, R. 2, W. 5.TH
ALBERTA, CANADA
SCALE 1" = 150', NOVEMBER, 1960.

19600003 #9

locations only

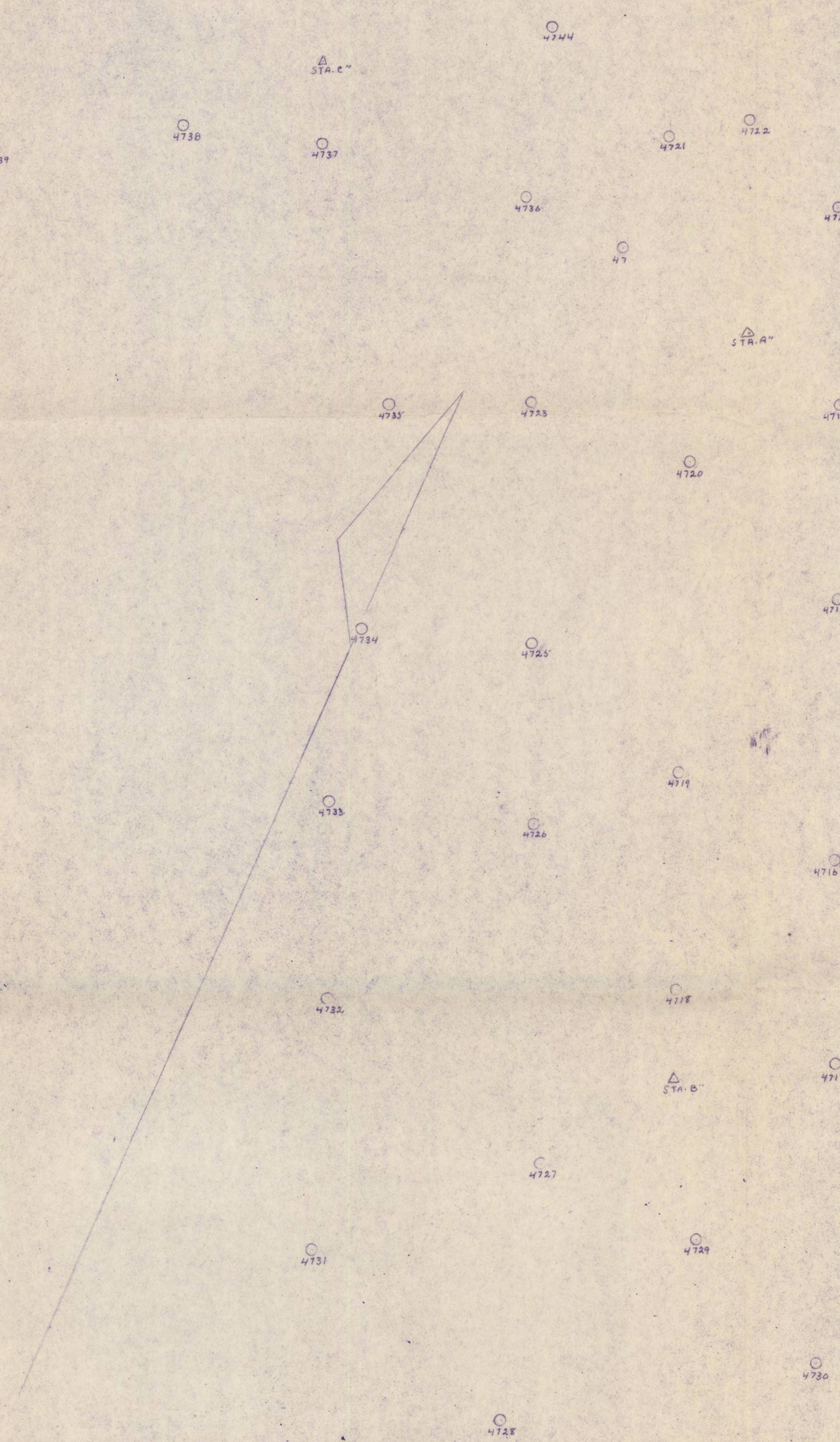

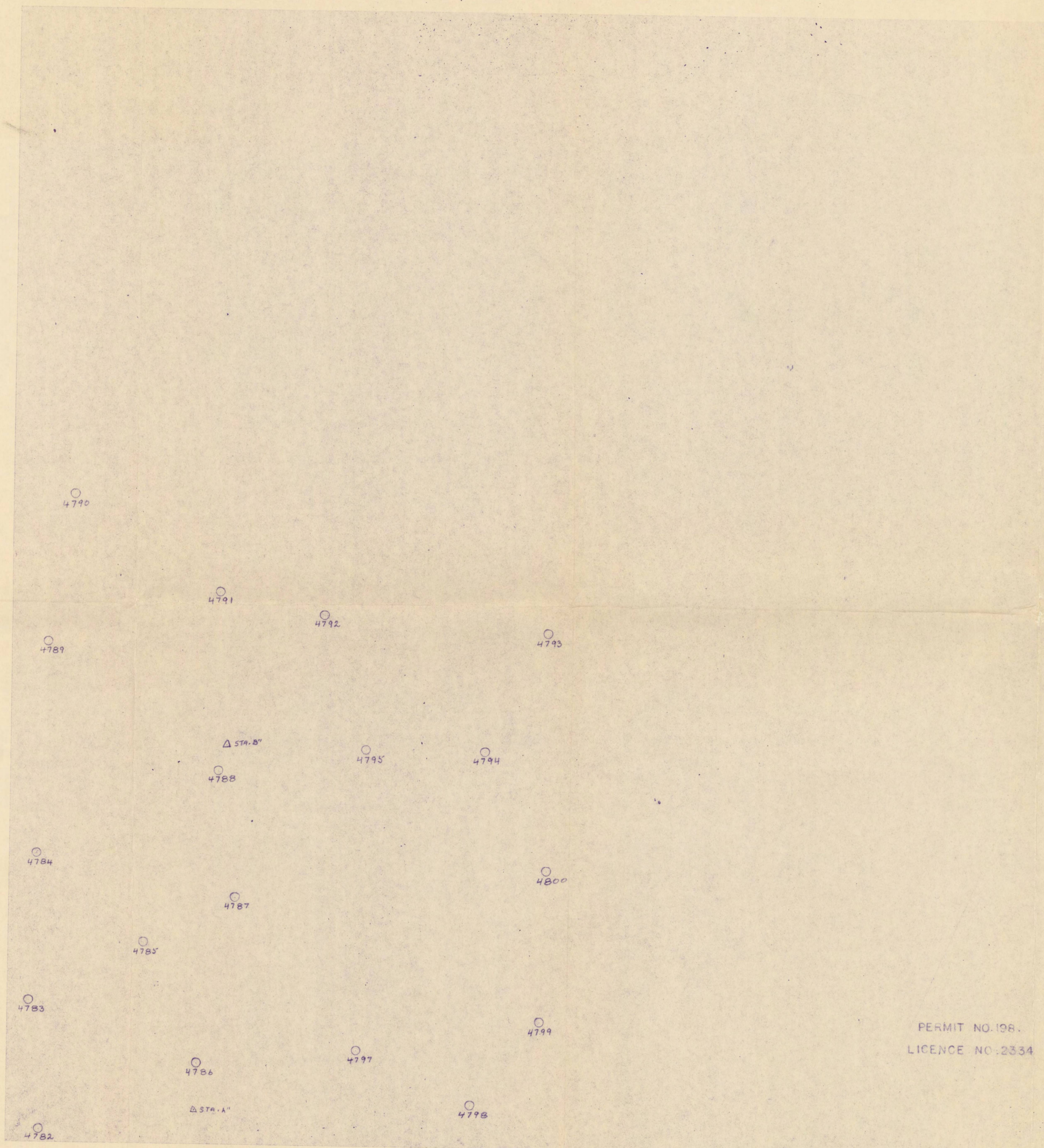

BAROID OF CANADA LTD.

DRILL HOLE MAP.

N.W. 1/4 SEC. 16, T. 56, R. 2, W. 5TH.

ALBERTA, CANADA.

SCALE - 1" = 150', NOVEMBER, 1960.

PERMIT NO. 198.

LICENCE NO. 2334

16000003

drill hole locations only

#10

BAROID OF CANADA LTD.

DRILL HOLE MAP

S.E. 1/4 SEC. 20, T. 56, R. 2, W. 5TH.

ALBERTA, CANADA.

SCALE - 1" = 150' JANUARY, 1961.

PERMIT NO. 198

LICENCE NO. 2334

19600003

11

drill hole locations only

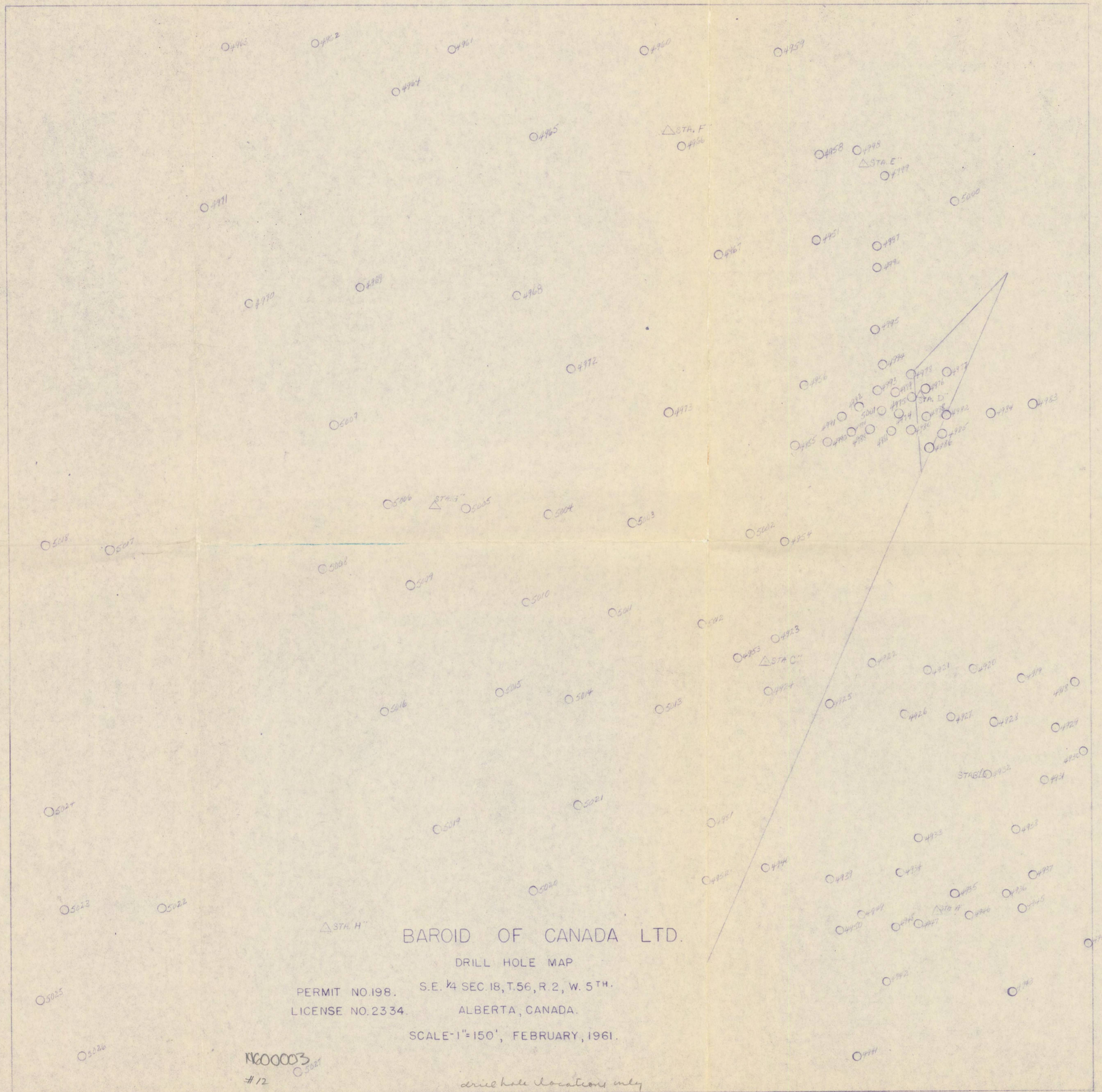

4187

4184

4155

4154

4123

"D" Δ

4202

4201

4186

4185

4180

4204

4210

4203

4200

4211

"B" Δ 4209

4199

4205

4225

4226

4197

4192

4227

4206

4208

4212

4224

4213

4198

4193

4214

4223

4207

4194

4197

4220

4221

4195

4215

4196

"C" Δ 4222

4219

4216

4218

4217

BAROID OF CANADA LTD.

DRILL HOLE MAP

PERMIT NO. 198.
LICENCE NO. 2249.

N.W. 1/4 SEC. 33, T. 55, R. 2, W. 5TH.

ALBERTA, CANADA.

SCALE - 1" = 100' JANUARY, 1960.

Location only

1570015

170003 #13

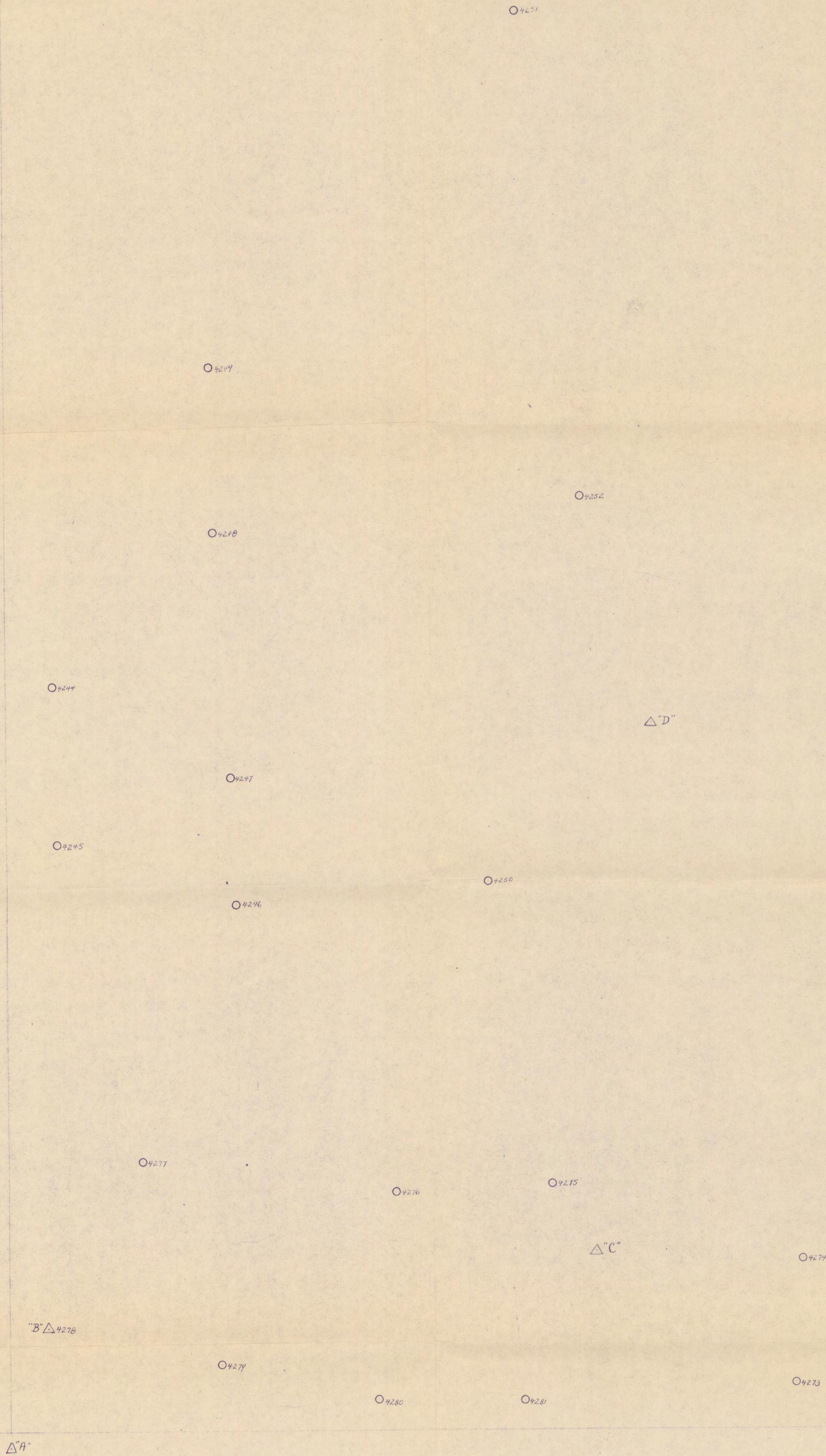

A

B

C

BAROID OF CANADA LTD.

PERMIT NO. 198.
LICENCE NO. 2249.

DRILL HOLE MAP
S.E. 1/4 SEC. 32, T. 55, R. 2, W. 5TH.
ALBERTA, CANADA.

SCALE - 1" = 100' FEBRUARY, 1960.

Location only

17600003 #15

FORCED ROAD

04440

04465

04466

04467

04472

04473

04468

04471

04441

04464

04469

04459

04458

04457

04456

04442

04460

04449

04450

04457

04445

04446

04447

04451

04452

04453

04454

04455

04456

04443

04461

04456

TRACE - 16'

04454

36" BLUE GENT - 16" 8"

W. SAMPLE

04446

04448

04451

04462

04463

04462

04461

04460

04452

04453

04454

04457

04450

04444

04447

04445

04446

PERMIT NO. 198.
LICENCE NO. 2334.

BAROID OF CANADA LTD.

DRILL HOLE MAP

SW. 1/4 SEC. 6, T. 56, R. 2, W. 5TH.

ALBERTA, CANADA.

SCALE - 1" = 100' MAY, 1960.

PERMIT NO. 198
LICENCE NO. 2334

BAROID OF CANADA, LTD.
DRILL HOLE MAP
N.W. 1/4 SEC. 19, T. 56, R. 2, W. 5TH
ALBERTA, CANADA
SCALE - 1" = 100', JUNE, 1960.

locations only

10600003 #117

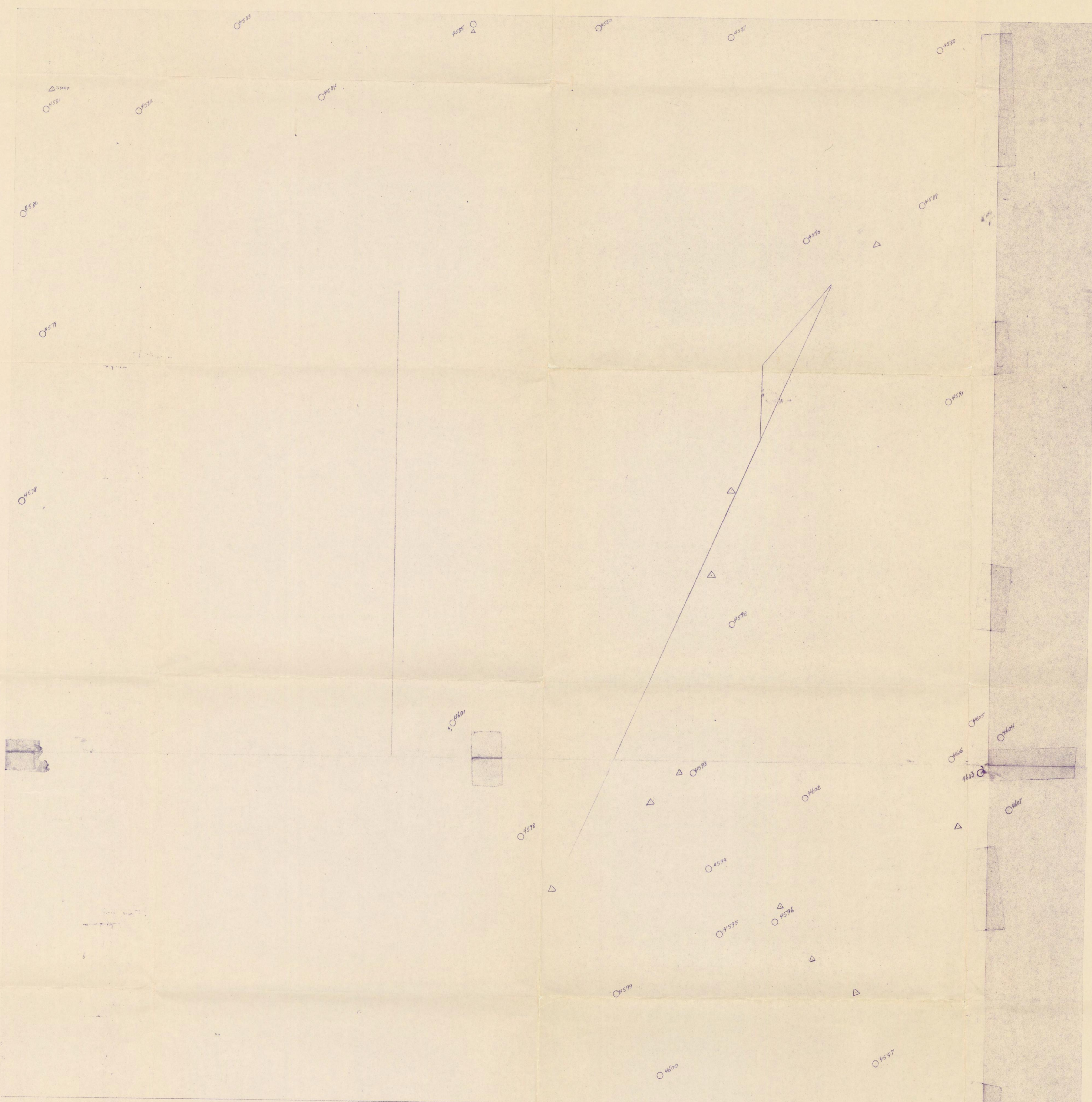

PERMIT NO. 196.
LICENCE NO. 2334.

BAROID OF CANADA LTD.
DRILL HOLE MAP
O.E. 4 SEC 19, T. 56, R. 2, W. 5
ALBERTA, CANADA.
SCALE - 1" = 100', JUNE, 1960.

locations by

19000003 #18

BAROID OF CANADA LTD.

DRILL HOLE MAP

N.W. 1/4 SEC. 4, T.56, R.2, W.5TH.

ALBERTA, CANADA.

SCALE-1"=150', OCTOBER, 1960.

PERMIT NO. 198
LICENCE NO. 2334.

19600003 #19

locations only

4632 4633

4636 4635 4634

4637 4638 4639

4642 4641 4640

4645 4644 4670

4646 4645

4647

4648

4649

4650

4651

4652

4653

4654

4655

4656

4657

4658

4659

4660

4661

4662

4663

4664

4665

4666

4667

4692

4691

4693

4681

STA. B

4682

4683

STA. A

4687

4684

4685

START

4686

PERMIT NO. 198.
LICENCE NO. 2334.

BAROID OF CANADA, LTD.
DRILL HOLE MAP
S.E. 1/4 SEC. 9, T. 56, R. 2, W. 5TH
ALBERTA, CANADA.
SCALE 1" = 150', NOVEMBER, 1960.

19600003

drill hole locations only

20

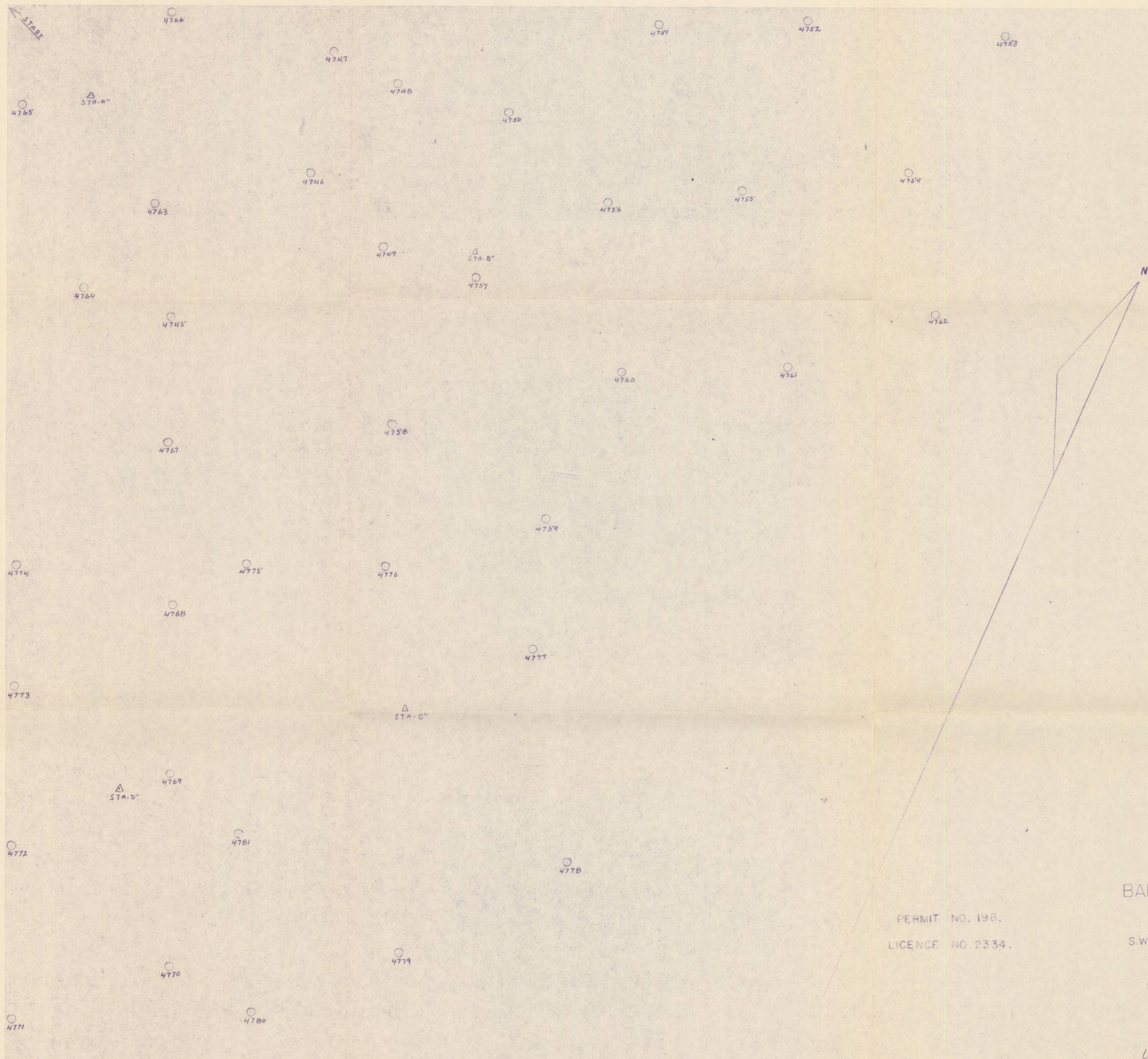

PERMIT NO. 198.
LICENCE NO. 2334.

BAROID OF CANADA LTD.
DRILL HOLE MAP
S.W. 1/4 SEC 16, T. 56, R. 2, W. 5TH.
ALBERTA, CANADA.
SCALE - 1" = 150', NOVEMBER, 1960.

locations only

19600003

#21

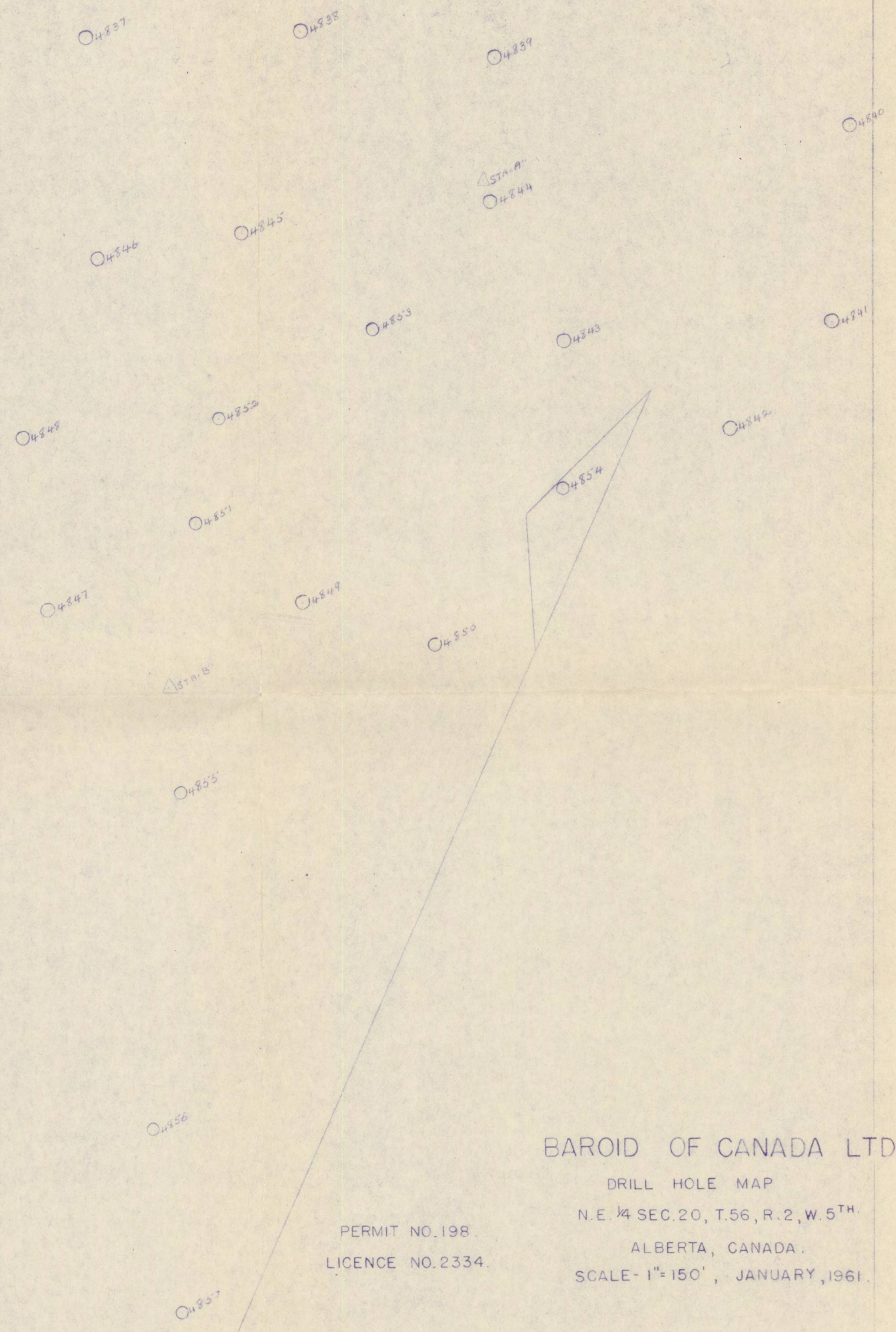

BAROID OF CANADA LTD.

DRILL HOLE MAP

N.E. 1/4 SEC. 20, T. 56, R. 2, W. 5TH.

ALBERTA, CANADA.

SCALE - 1" = 150', JANUARY, 1961.

PERMIT NO. 198

LICENCE NO. 2334.

19600003 #22

drill hole locations only

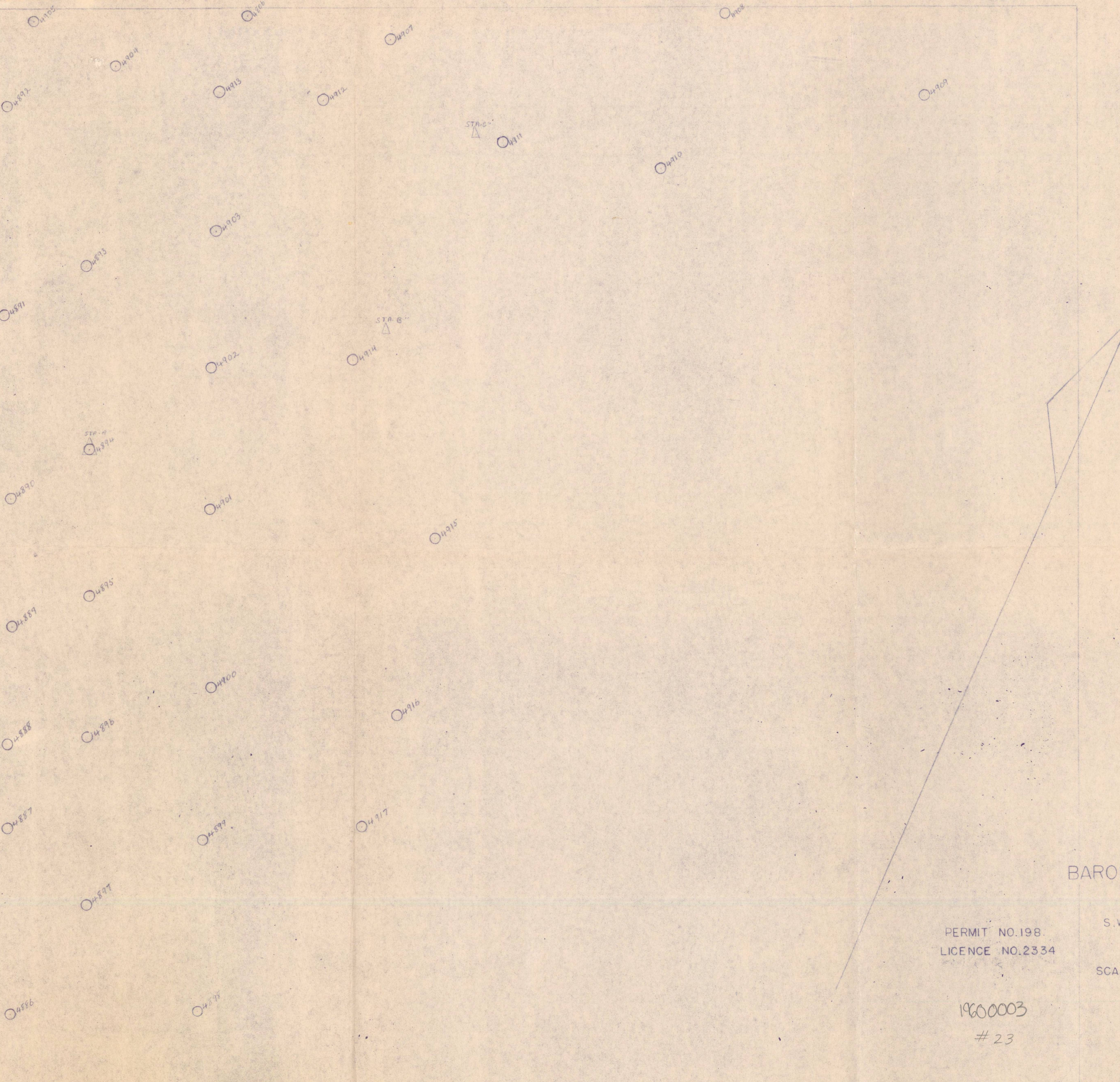

BAROID OF CANADA LTD.

DRILL HOLE MAP

S.W. 1/4 SEC. 20, T.56, R.2, W.5TH.

ALBERTA, CANADA

SCALE - 1" = 150', JANUARY, 1961.

PERMIT NO. 198.
LICENCE NO. 2334

19600003

23

drill hole locations only