

# MAR 20110009: PANNY RIVER

Panny River - A report on exploration in northeast Alberta.

Received date: Apr 18, 2011

Public release date: Apr 18, 2012

## **DISCLAIMER**

By accessing and using the Alberta Energy website to download or otherwise obtain a scanned mineral assessment report, you ("User") agree to be bound by the following terms and conditions:

- a) Each scanned mineral assessment report that is downloaded or otherwise obtained from Alberta Energy is provided "AS IS", with no warranties or representations of any kind whatsoever from Her Majesty the Queen in Right of Alberta, as represented by the Minister of Energy ("Minister"), expressed or implied, including, but not limited to, no warranties or other representations from the Minister, regarding the content, accuracy, reliability, use or results from the use of or the integrity, completeness, quality or legibility of each such scanned mineral assessment report;
- b) To the fullest extent permitted by applicable laws, the Minister hereby expressly disclaims, and is released from, liability and responsibility for all warranties and conditions, expressed or implied, in relation to each scanned mineral assessment report shown or displayed on the Alberta Energy website including but not limited to warranties as to the satisfactory quality of or the fitness of the scanned mineral assessment report for a particular purpose and warranties as to the non-infringement or other non-violation of the proprietary rights held by any third party in respect of the scanned mineral assessment report;
- c) To the fullest extent permitted by applicable law, the Minister, and the Minister's employees and agents, exclude and disclaim liability to the User for losses and damages of whatsoever nature and howsoever arising including, without limitation, any direct, indirect, special, consequential, punitive or incidental damages, loss of use, loss of data, loss caused by a virus, loss of income or profit, claims of third parties, even if Alberta Energy have been advised of the possibility of such damages or losses, arising out of or in connection with the use of the Alberta Energy website, including the accessing or downloading of the scanned mineral assessment report and the use for any purpose of the scanned mineral assessment report so downloaded or retrieved.
- d) User agrees to indemnify and hold harmless the Minister, and the Minister's employees and agents against and from any and all third party claims, losses, liabilities, demands, actions or proceedings related to the downloading, distribution, transmissions, storage, redistribution, reproduction or exploitation of each scanned mineral assessment report obtained by the User from Alberta Energy.

**Part B**  
**Technical Report**

**And**

**Part C**  
**Appendices**

Roland & David Calahasen (CREEgold Inc)

Permit #'s:     **9309030452**  
                  **9309030453**  
                  **9309030454**  
                  **9309030455**

Prepared for the Department of Coal and Mineral Development , Department of Energy by:

Roland Calahasen  
CREEgold Inc.  
April 18 2011

## Table of Contents

### **PART B – TECHNICAL REPORT**

Statement of Project work to date.....	2
Map 1- Sample Locations.....	3
Map 2- Sample Locations.....	4
SGS Certificate of Analysis.....	5 -11
Loring Laboratory Analysis .....	12

### **PART C - APPENDICES**

Title Page of Part C .....	13
Sample Site Map .....	14 -15

Roland & David Calahasen (CREEgold Inc), Part B and Part C  
Roland Calahasen  
April 18, 2011

April 18, 2011

## STATEMENT OF PROJECT WORK TO DATE

### Jan 2009

Applied for Metallic and Industrial Permits:

9309030452

9309030453

9309030454

9309030455

### July – August 2009

Spent 10 Days at site

Transporting equipment , camping Gear , and crew to site

Setting up base camp for crew of 7 men

Exploring Site

GPS coordinates Located and logged

Collecting Topical samples only

Load Out equipment samples and crew from site

Restoring camping site to original condition/

### May 2010

Sent Topical Samples to Assay Laboratories for Testing

### June –July 2010

Consultant Hired to Plan next phases of Exploration and Prepare for Project work to move forward

### September 2010

Labour Crew went back to site to collect more topical Samples(5 Days)

If you require any further Assistance please contact me at 780-999-6110

Yours Sincerely,

  
Roland Calahasen

[rscal@live.ca](mailto:rscal@live.ca)

CREEgold Inc.

17 elbow Place

St. Albert, Alberta

T8N 6X3

# Metallic and Industrial Minerals

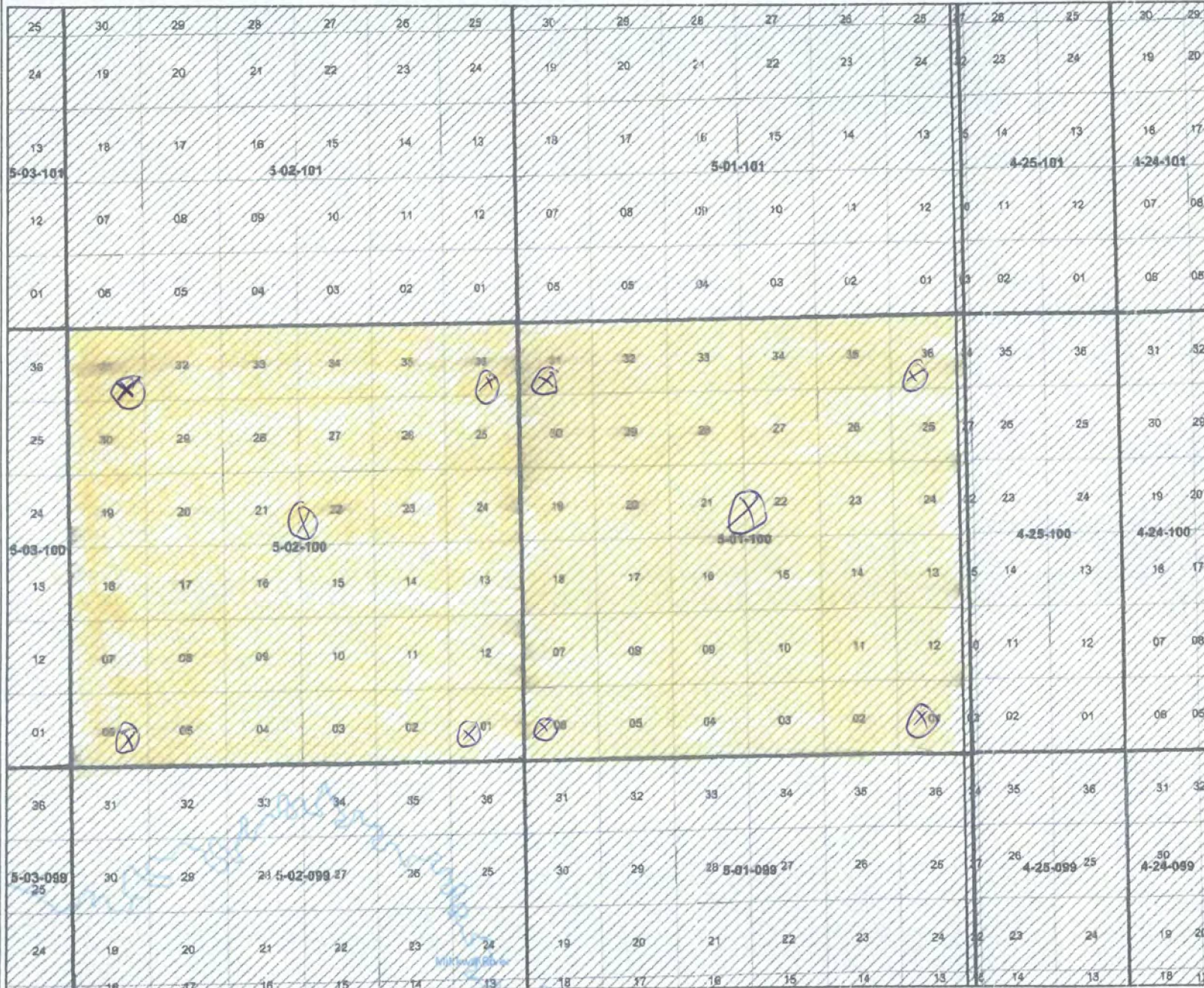

**Legend**

- Alberta Boundary
- Meridian
- Township
- Section
- Major River
- Major Lake
- Major Road
- 30 Day Pending
- Reserved/Withdrawn - Restrictions
- No Surface Access - Restrictions
- Subject To - Restrictions
- Other - Restrictions
- Municipality
- Special Lease - 037
- Phosphate Exploration - 069
- Permit - 093
- Other - 042
- Natural Gas Storage - 036
- Lease - 094
- Application Special Lease - A37
- Application Phosphate Exploration - A69
- Application Permit - A93
- Application Other - A42
- Application Natural Gas Storage - A36
- Application Lease - A94
- Mineral Ownership Undetermined
- Minerals Not Owned by the Alberta Crown**
- Parks and Protected Areas
- National Park

*Handwritten:* SAMPLE TAKEN FROM SITE

January 26, 2009

Map center: 57°41' N, 114°7' W

DISCLAIMER: Information presented on this map originates from various sources and is for general use only. Please be advised that some information may have been added, amended and deleted since this map was created.

Base Data Provided by Spatial Data Warehouse Ltd. Copyright of Government of Alberta.

# Metallic and Industrial Minerals

## Legend

- Alberta Boundary
- Meridian
- Township
- Section
- Major River
- Major Lake
- Major Road
- 30 Day Pending
- Reserved/Withdrawn - Restrictions
- No Surface Access - Restrictions
- Subject To - Restrictions
- Other - Restrictions
- Municipality
- Special Lease - 037
- Phosphate Exploration - 069
- Permit - 093
- Other - 042
- Natural Gas Storage - 036
- Lease - 094
- Application Special Lease - A37
- Application Phosphate Exploration - A69
- Application Permit - A93
- Application Other - A42
- Application Natural Gas Storage - A36
- Application Lease - A94
- Mineral Ownership Undetermined
- Minerals Not Owned by the Alberta Crown
- Parks and Protected Areas
- National Park

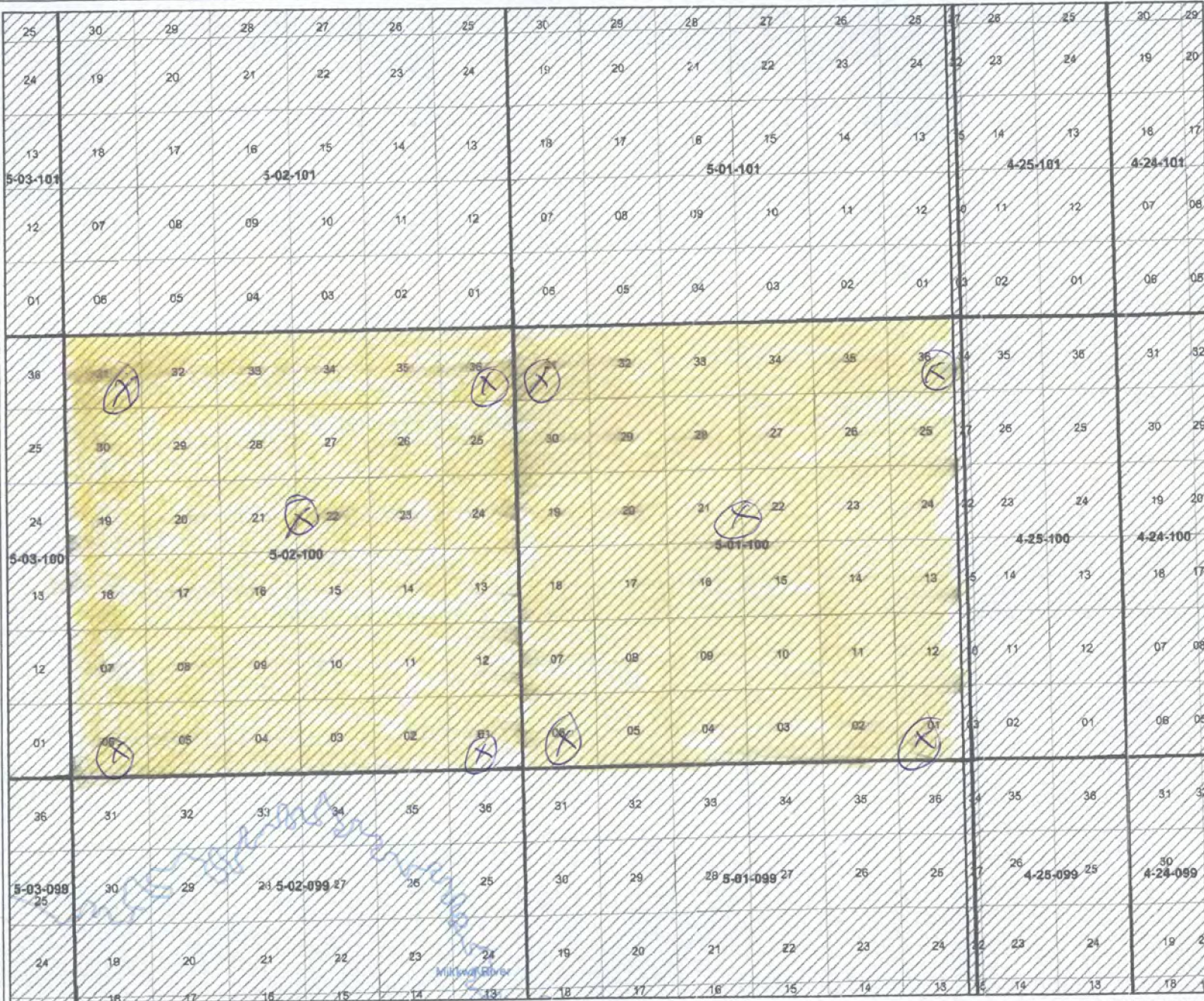

4.

Sample Taken from SITE

January 26, 2009

Map center: 57°41' N, 114°7' W

DISCLAIMER: Information presented on this map originates from various sources and is for general use only. Please be advised that some information may have been added, amended and deleted since this map was created.

Base Data Provided by Spatial Data Warehouse Ltd. Copyright of Government of Alberta.



## Certificate of Analysis

Work Order: TO110001

To: **COD SGS Minerals**  
COD SGS Minerals  
1885 Leslie St  
Toronto  
ON M3B 2M3

Date: May 21, 2010

P.O. No. : MEL CALAHASEN  
Project No. : -  
No. Of Samples : 3  
Date Submitted : Apr 28, 2010  
Report Comprises : Pages 1 to 7  
(Inclusive of Cover Sheet)

**Distribution of unused material:**

Discard after 90 days:

Certified By

  
Gavin McGill  
Operations Manager

*SGS Minerals Services (Toronto) is accredited by Standards Council of Canada (SCC) and conforms to the requirements of ISO/IEC 17025 for specific tests as indicated on the scope of accreditation to be found at <http://www.scc.ca/en/programs/lab/mineral.shtml>*

Report Footer: L.N.R. = Listed not received I.S. = Insufficient Sample  
n.a. = Not applicable -- = No result  
\*INF = Composition of this sample makes detection impossible by this method  
M after a result denotes ppb to ppm conversion, % denotes ppm to % conversion  
Methods marked with an asterisk (e.g. \*NAA08V) were subcontracted  
Methods marked with the @ symbol (e.g. @AAS21E) denote accredited tests

This document is issued by the Company under its General Conditions of Service accessible at [http://www.sgs.com/terms\\_and\\_conditions.htm](http://www.sgs.com/terms_and_conditions.htm). Attention is drawn to the limitation of liability, indemnification and jurisdiction issues defined therein.

**WARNING:** The sample(s) to which the findings recorded herein (the "Findings") relate was (were) drawn and / or provided by the Client or by a third party acting at the Client's direction. The Findings constitute no warranty of the sample's representativity of the goods and strictly relate to the sample(s). The Company accepts no liability with regard to the origin or source from which the sample(s) is/are said to be extracted. The findings report on the samples provided by the client and are not intended for commercial or contractual settlement purposes. Any unauthorized alteration, forgery or falsification of the content or appearance of this document is unlawful and offenders may be prosecuted to the fullest extent of the law.



Final : TO110001 Order: MEL CALAHASEN

Page 2 of 7

Element Method Det.Lim. Units	WtKg WGH79 0.001 kg	Au FAI323 5 ppb	Al @ICM90A 0.01 %	Ba @ICM90A 0.5 ppm	Be @ICM90A 5 ppm	Ca @ICM90A 0.1 %	Cr @ICM90A 10 ppm	Cu @ICM90A 5 ppm	Fe @ICM90A 0.01 %	K @ICM90A 0.1 %
EXHIBIT #1	0.170	<5	7.77	1740	<5	3.2	30	11	8.65	2.1
EXHIBIT #3	0.080	<5	0.73	160	<5	>35	20	<5	0.45	0.2
EXHIBIT #5	0.122	<5	4.01	258	<5	20.4	50	<5	3.55	2.0
*Rep EXHIBIT #1		<5								
*Rep EXHIBIT #5			4.08	258	<5	20.5	50	<5	3.61	2.0

This document is issued by the Company under its General Conditions of Service accessible at [http://www.sgs.com/terms\\_and\\_conditions.htm](http://www.sgs.com/terms_and_conditions.htm). Attention is drawn to the limitation of liability, indemnification and jurisdiction issues defined therein.

**WARNING:** The sample(s) to which the findings recorded herein (the "Findings") relate was (were) drawn and / or provided by the Client or by a third party acting at the Client's direction. The Findings constitute no warranty of the sample's representativity of the goods and strictly relate to the sample(s). The Company accepts no liability with regard to the origin or source from which the sample(s) is/are said to be extracted. The findings report on the samples provided by the client and are not intended for commercial or contractual settlement purposes. Any unauthorized alteration, forgery or falsification of the content or appearance of this document is unlawful and offenders may be prosecuted to the fullest extent of the law.





Final : TO110001 Order: MEL CALAHASEN

Page 3 of 7

Element	Li	Mg	Mn	Ni	P	Sc	Sr	Ti	V	Zn
Method	@ICM90A	@ICM90A	@ICM90A	@ICM90A	@ICM90A	@ICM90A	@ICM90A	@ICM90A	@ICM90A	@ICM90A
Det.Lim.	10	0.01	10	5	0.01	5	0.1	0.01	5	5
Units	ppm	%	ppm	ppm	%	ppm	ppm	%	ppm	ppm
EXHIBIT #1	80	1.10	1240	14	0.20	23	340	0.93	90	151
EXHIBIT #3	<10	0.85	270	9	0.03	<5	305	0.04	19	5
EXHIBIT #5	20	0.89	1750	18	0.03	8	79.0	0.24	50	26
*Rep EXHIBIT #5	20	0.90	1770	23	0.03	8	78.9	0.24	50	28

This document is issued by the Company under its General Conditions of Service accessible at [http://www.sgs.com/terms\\_and\\_conditions.htm](http://www.sgs.com/terms_and_conditions.htm). Attention is drawn to the limitation of liability, indemnification and jurisdiction issues defined therein.

**WARNING:** The sample(s) to which the findings recorded herein (the "Findings") relate was (were) drawn and / or provided by the Client or by a third party acting at the Client's direction. The Findings constitute no warranty of the sample's representativity of the goods and strictly relate to the sample(s). The Company accepts no liability with regard to the origin or source from which the sample(s) is/are said to be extracted. The findings report on the samples provided by the client and are not intended for commercial or contractual settlement purposes. Any unauthorized alteration, forgery or falsification of the content or appearance of this document is unlawful and offenders may be prosecuted to the fullest extent of the law.



Final : TO110001 Order: MEL CALAHASEN

Page 4 of 7

Element	Ag	As	Bi	Cd	Ce	Co	Cs	Dy	Er	Eu
Method	@ICM90A	@ICM90A	@ICM90A	@ICM90A	@ICM90A	@ICM90A	@ICM90A	@ICM90A	@ICM90A	@ICM90A
Det.Lim.	1	5	0.1	0.2	0.1	0.5	0.1	0.05	0.05	0.05
Units	ppm	ppm	ppm	ppm	ppm	ppm	ppm	ppm	ppm	ppm
EXHIBIT #1	<1	<5	0.1	0.6	80.4	19.5	7.4	7.66	4.10	3.77
EXHIBIT #3	<1	<5	<0.1	<0.2	7.8	2.0	0.9	0.74	0.42	0.21
EXHIBIT #5	<1	<5	0.2	<0.2	47.9	15.1	2.2	3.38	1.81	0.86
*Rep EXHIBIT #5	<1	<5	0.2	<0.2	48.1	15.5	2.3	3.42	1.89	0.83

This document is issued by the Company under its General Conditions of Service accessible at [http://www.sgs.com/terms\\_and\\_conditions.htm](http://www.sgs.com/terms_and_conditions.htm). Attention is drawn to the limitation of liability, indemnification and jurisdiction issues defined therein.

**WARNING:** The sample(s) to which the findings recorded herein (the "Findings") relate was (were) drawn and / or provided by the Client or by a third party acting at the Client's direction. The Findings constitute no warranty of the sample's representativity of the goods and strictly relate to the sample(s). The Company accepts no liability with regard to the origin or source from which the sample(s) is/are said to be extracted. The findings report on the samples provided by the client and are not intended for commercial or contractual settlement purposes. Any unauthorized alteration, forgery or falsification of the content or appearance of this document is unlawful and offenders may be prosecuted to the fullest extent of the law.



Final : TO110001 Order: MEL CALAHASEN

Page 5 of 7

Element	Ga	Gd	Ge	Hf	Ho	In	La	Lu	Mo	Nb
Method	@ICM90A	@ICM90A	@ICM90A	@ICM90A	@ICM90A	@ICM90A	@ICM90A	@ICM90A	@ICM90A	@ICM90A
Det.Lim.	1	0.05	1	1	0.05	0.2	0.1	0.05	2	1
Units	ppm	ppm	ppm	ppm	ppm	ppm	ppm	ppm	ppm	ppm
EXHIBIT #1	30	8.57	2	14	1.48	<0.2	35.9	0.57	3	16
EXHIBIT #3	3	0.68	<1	<1	0.15	<0.2	4.0	0.09	2	2
EXHIBIT #5	13	3.67	<1	3	0.71	<0.2	23.9	0.26	<2	7
*Rep EXHIBIT #5	13	3.70	1	3	0.69	<0.2	24.2	0.29	<2	7

This document is issued by the Company under its General Conditions of Service accessible at [http://www.sgs.com/terms\\_and\\_conditions.htm](http://www.sgs.com/terms_and_conditions.htm). Attention is drawn to the limitation of liability, indemnification and jurisdiction issues defined therein.

**WARNING:** The sample(s) to which the findings recorded herein (the "Findings") relate was (were) drawn and / or provided by the Client or by a third party acting at the Client's direction. The Findings constitute no warranty of the sample's representativity of the goods and strictly relate to the sample(s). The Company accepts no liability with regard to the origin or source from which the sample(s) is/are said to be extracted. The findings report on the samples provided by the client and are not intended for commercial or contractual settlement purposes. Any unauthorized alteration, forgery or falsification of the content or appearance of this document is unlawful and offenders may be prosecuted to the fullest extent of the law.



Final : TO110001 Order: MEL CALAHASEN

Page 6 of 7

Element	Nd	Pb	Pr	Rb	Sb	Sm	Sn	Ta	Tb	Th
Method	@ICM90A	@ICM90A	@ICM90A	@ICM90A	@ICM90A	@ICM90A	@ICM90A	@ICM90A	@ICM90A	@ICM90A
Det.Lim.	0.1	5	0.05	0.2	0.1	0.1	1	0.5	0.05	0.1
Units	ppm	ppm	ppm	ppm	ppm	ppm	ppm	ppm	ppm	ppm
EXHIBIT #1	48.0	13	11.0	66.0	0.2	10.4	<1	0.9	1.30	1.2
EXHIBIT #3	4.0	<5	1.04	13.0	0.2	0.9	<1	<0.5	0.11	1.1
EXHIBIT #5	21.0	8	5.71	88.6	0.9	4.2	2	0.6	0.58	9.0
*Rep EXHIBIT #5	21.3	8	5.73	88.8	1.0	4.3	2	0.6	0.58	8.7

This document is issued by the Company under its General Conditions of Service accessible at [http://www.sgs.com/terms\\_and\\_conditions.htm](http://www.sgs.com/terms_and_conditions.htm). Attention is drawn to the limitation of liability, indemnification and jurisdiction issues defined therein.

**WARNING:** The sample(s) to which the findings recorded herein (the "Findings") relate was (were) drawn and / or provided by the Client or by a third party acting at the Client's direction. The Findings constitute no warranty of the sample's representativity of the goods and strictly relate to the sample(s). The Company accepts no liability with regard to the origin or source from which the sample(s) is/are said to be extracted. The findings report on the samples provided by the client and are not intended for commercial or contractual settlement purposes. Any unauthorized alteration, forgery or falsification of the content or appearance of this document is unlawful and offenders may be prosecuted to the fullest extent of the law.



Final : TO110001 Order: MEL CALAHASEN

Page 7 of 7

Element	Tl	Tm	U	W	Y	Yb	Zr
Method	@ICM90A	@ICM90A	@ICM90A	@ICM90A	@ICM90A	@ICM90A	@ICM90A
Det.Lim.	0.5	0.05	0.05	1	0.5	0.1	0.5
Units	ppm	ppm	ppm	ppm	ppm	ppm	ppm
EXHIBIT #1	<0.5	0.55	0.98	1	39.1	3.7	607
EXHIBIT #3	<0.5	0.06	1.08	<1	4.7	0.4	20.8
EXHIBIT #5	<0.5	0.27	2.17	2	22.2	1.6	90.0
*Rep EXHIBIT #5	<0.5	0.25	2.11	2	22.5	1.6	90.2

This document is issued by the Company under its General Conditions of Service accessible at [http://www.sgs.com/terms\\_and\\_conditions.htm](http://www.sgs.com/terms_and_conditions.htm). Attention is drawn to the limitation of liability, indemnification and jurisdiction issues defined therein.

**WARNING:** The sample(s) to which the findings recorded herein (the "Findings") relate was (were) drawn and / or provided by the Client or by a third party acting at the Client's direction. The Findings constitute no warranty of the sample's representativity of the goods and strictly relate to the sample(s). The Company accepts no liability with regard to the origin or source from which the sample(s) is/are said to be extracted. The findings report on the samples provided by the client and are not intended for commercial or contractual settlement purposes. Any unauthorized alteration, forgery or falsification of the content or appearance of this document is unlawful and offenders may be prosecuted to the fullest extent of the law.

861-2828  
 403-457-2855

Page: 1/1



**Loring Laboratories(Alberta) Ltd.**

828 Beaverdam Road N.E.,  
 Calgary Alberta T2K 0W7  
 Tel: 403-274-3777 Fax: 403-275-6541  
 loringlabs@shaw.net

TO: DIVERSE EQUITIES INC.  
 Box 61144 Kensington P.O.  
 Calgary, Alberta T2N 4S8

File No : 93084

Date: May 13, 2010

Attn: Stan Wright

**30 ELEMENT ICP ANALYSIS**

p. 12.

Sample No.	Ag ppm	Al %	As ppm	Au ppb	B ppm	Ba ppm	Bi ppm	Ca %	Cd ppm	Co ppm	Cr ppm	Cu ppm	Fe %	K %	La ppm	Mg %	Mn ppm	Mo ppm	Na %	N ppm	P %	Pb ppm	Sb ppm	Sr ppm	Th ppm	Ti %	U ppm	V ppm	W ppm	Zn ppm
Sample-1	1.7	8.74	2	<5	2083	1152	<1	1.81	<1	11	102	6	3.85	2.57	44	1.43	654	3	2.01	11	0.08	13	1	369	12	0.26	<1	71	<1	98

From: 4032750541

MAY-14-2009 13:26

0.500 gram sample is total digested with HF, HNO3, HCL.  
 Au-30 gram Fire Assay with AA finish  
 Ag-0.500 gram HNO3 digestion only.  
 Received Date: May 11/2010

Certified by [Redacted]

March 5<sup>th</sup> 2012

STATEMENT OF PROJECT WORK TO DATE

Jan 2009

Applied for Metallic and Industrial Permits:

9309030452

9309030453

9309030454

9309030455

July – August 2009

Spent 10 Days at site

Transporting equipment , camping Gear , and crew to site

Setting up base camp for crew of 7 men

Exploring Site

GPS coordinates Located and logged

Collecting Topical samples only

Load Out equipment samples and crew from site

Restoring camping site to original condition/

May 2010

Sent Topical Samples to Assay Laboratories for Testing

June –July 2010

Consultant Hired to Plan next phases of Exploration and Prepare for Project work to move forward

September 2010

Labour Crew went back to site to collect more topical Samples(5 Days)

November / December 2011

A Road has been cut from Peerless Lake into Pannay River

Two Bridges have been repaired.

Equipment for Minning and Development of site was taken into site and set up for further Exploration

Additional Exploration to take place in June / July 2012

No Exploration has taken place recently as of Flooding in all the areas.

If you require any further Assistance please contact me at 780-999-6110

Yours Sincerely,

Roland Calahasen

[rscal@live.ca](mailto:rscal@live.ca)

CREEGold Inc.

17 elbow Place

St. Albert, Alberta

T8N 6X3



Page 10



# Metallic and Industrial Minerals

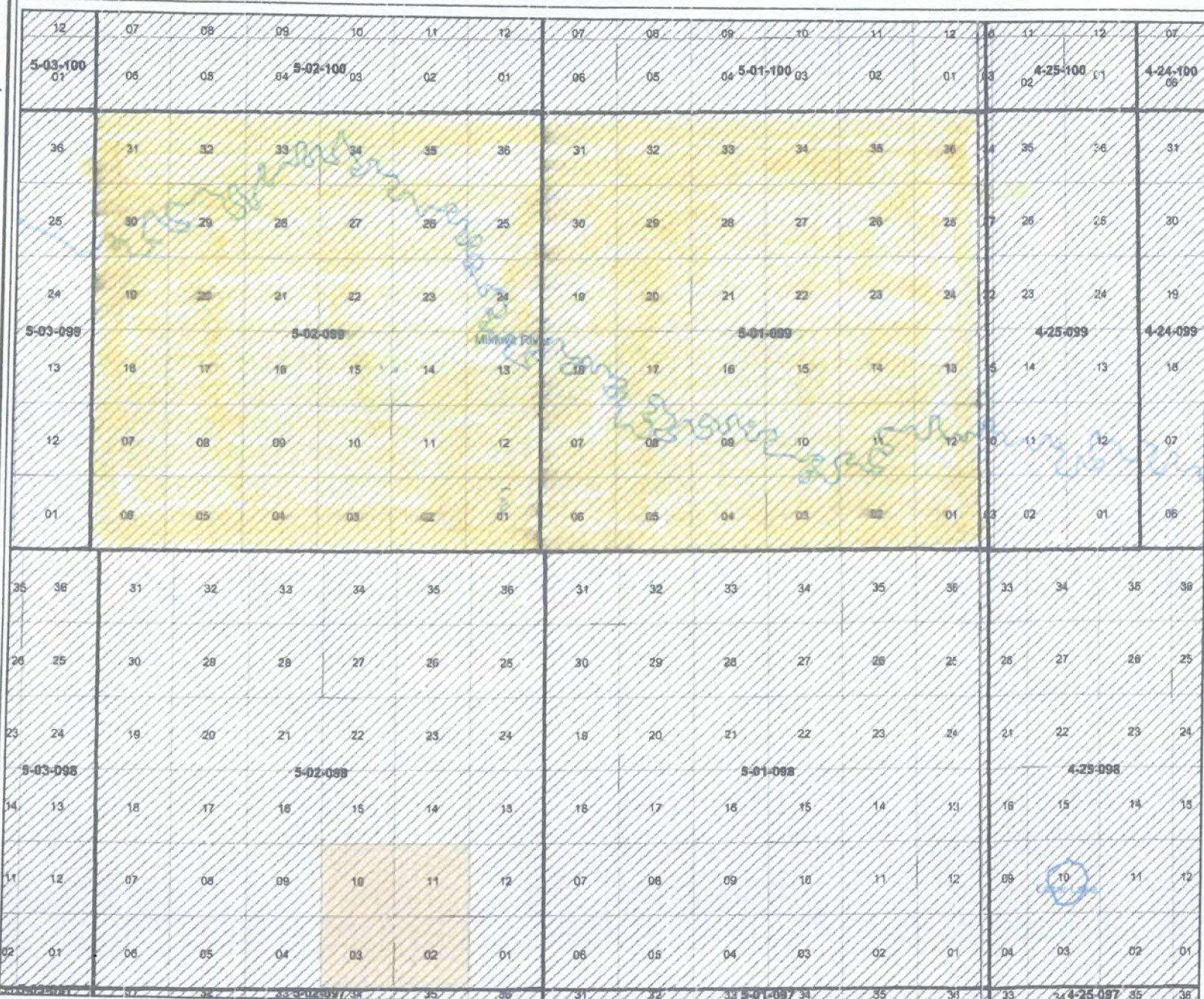

## Legend

- Alberta Boundary
- Meridian
- Township
- Section
- Major River
- Major Lake
- Major Road
- 30 Day Pending
- Reserved/Withdrawn - Restrictions
- No Surface Access - Restrictions
- Subject To - Restrictions
- Other - Restrictions
- Municipality
- Special Lease - 037
- Phosphate Exploration - 069
- Permit - 093
- Other - 042
- Natural Gas Storage - 036
- Lease - 094
- Application Special Lease - A37
- Application Phosphate Exploration - A69
- Application Permit - A93
- Application Other - A42
- Application Natural Gas Storage - A36
- Application Lease - A94
- Mineral Ownership Undetermined
- Minerals Not Owned by the Alberta Crown**
- Parks and Protected Areas
- National Park

January 26, 2009

DISCLAIMER: Information presented on this map originates from various sources and is for general use only. Please be advised that some information may have been added, amended or deleted since this map was created.

Base Data Provided by Spatial Data Warehouse Ltd. Copyright of Government of Alberta.

Map center: 57°33' N, 114°8' W

# Metallic and Industrial Minerals

Page 11



### Legend

- Alberta Boundary
- Meridian
- Township
- Section
- Major River
- Major Lake
- Major Road
- 30 Day Pending
- Reserved/Withdrawn - Restrictions
- No Surface Access - Restrictions
- Subject To - Restrictions
- Other - Restrictions
- Municipality
- Special Lease - 037
- Phosphate Exploration - 069
- Permit - 093
- Other - 042
- Natural Gas Storage - 036
- Lease - 094
- Application Special Lease - A37
- Application Phosphate Exploration - A69
- Application Permit - A93
- Application Other - A42
- Application Natural Gas Storage - A36
- Application Lease - A94
- Mineral Ownership Undetermined
- Minerals Not Owned by the Alberta Crown**
- Parks and Protected Areas
- National Park

January 26, 2009

DISCLAIMER: Information presented on this map originates from various sources and is for general information only. Please be advised that some information may have been added, amended or deleted since this map was created.

Base Data Provided by Spatial Data Warehouse Ltd. Copyright of Government of Alberta.

Map center: 57°41' N, 114°7' W

PART C



# Metallic and Industrial Minerals

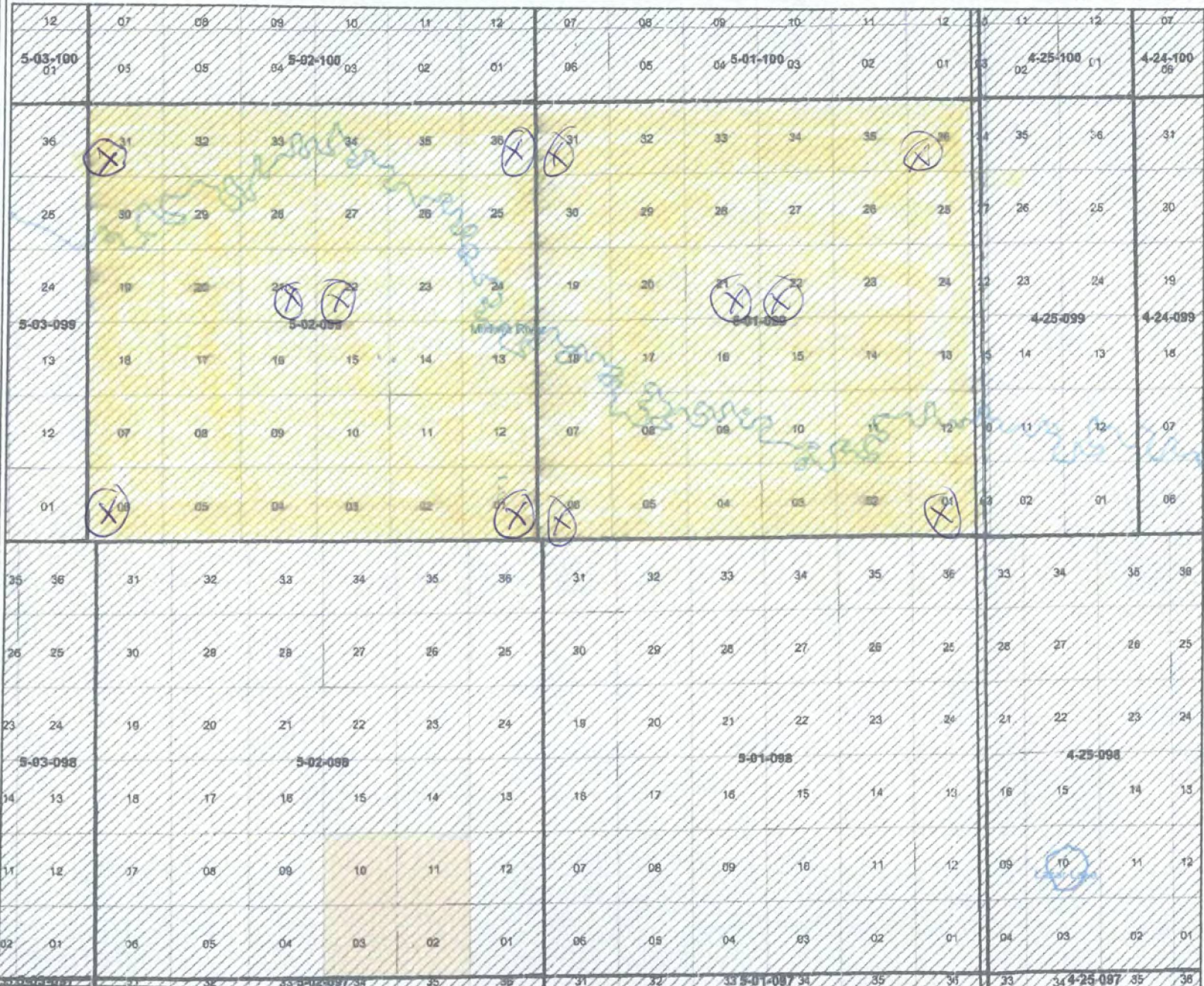

- ### Legend
- Alberta Boundary
  - Meridian
  - Township
  - Section
  - Major River
  - Major Lake
  - Major Road
  - 30 Day Pending
  - Reserved/Withdrawn - Restrictions
  - No Surface Access - Restrictions
  - Subject To - Restrictions
  - Other - Restrictions
  - Municipality
  - Special Lease - 037
  - Phosphate Exploration - 069
  - Permit - 093
  - Other - 042
  - Natural Gas Storage - 036
  - Lease - 094
  - Application Special Lease - A37
  - Application Phosphate Exploration - A69
  - Application Permit - A93
  - Application Other - A42
  - Application Natural Gas Storage - A36
  - Application Lease - A94
  - Mineral Ownership Undetermined
  - Minerals Not Owned by the Alberta Crown**
  - Parks and Protected Areas
  - National Park
- SAMPLE TAKEN FROM SITE

14.

January 26, 2009

DISCLAIMER: Information presented on this map originates from various sources and is for general use only. Please be advised that some information may have been added, amended and deleted since this map was created.

Base Data Provided by Spatial Data Warehouse Ltd. Copyright of Government of Alberta.

Map center: 57°33' N, 114°8' W



# Metallic and Industrial Minerals

## Legend

- Alberta Boundary
  - Meridian
  - Township
  - Section
  - Major River
  - Major Lake
  - Major Road
  - 30 Day Pending
  - Reserved/Withdrawn - Restrictions
  - No Surface Access - Restrictions
  - Subject To - Restrictions
  - Other - Restrictions
  - Municipality
  - Special Lease - 037
  - Phosphate Exploration - 069
  - Permit - 093
  - Other - 042
  - Natural Gas Storage - 036
  - Lease - 094
  - Application Special Lease - A37
  - Application Phosphate Exploration - A69
  - Application Permit - A93
  - Application Other - A42
  - Application Natural Gas Storage - A36
  - Application Lease - A94
  - Mineral Ownership Undetermined
- Minerals Not Owned by the Alberta Crown
- Parks and Protected Areas
  - National Park

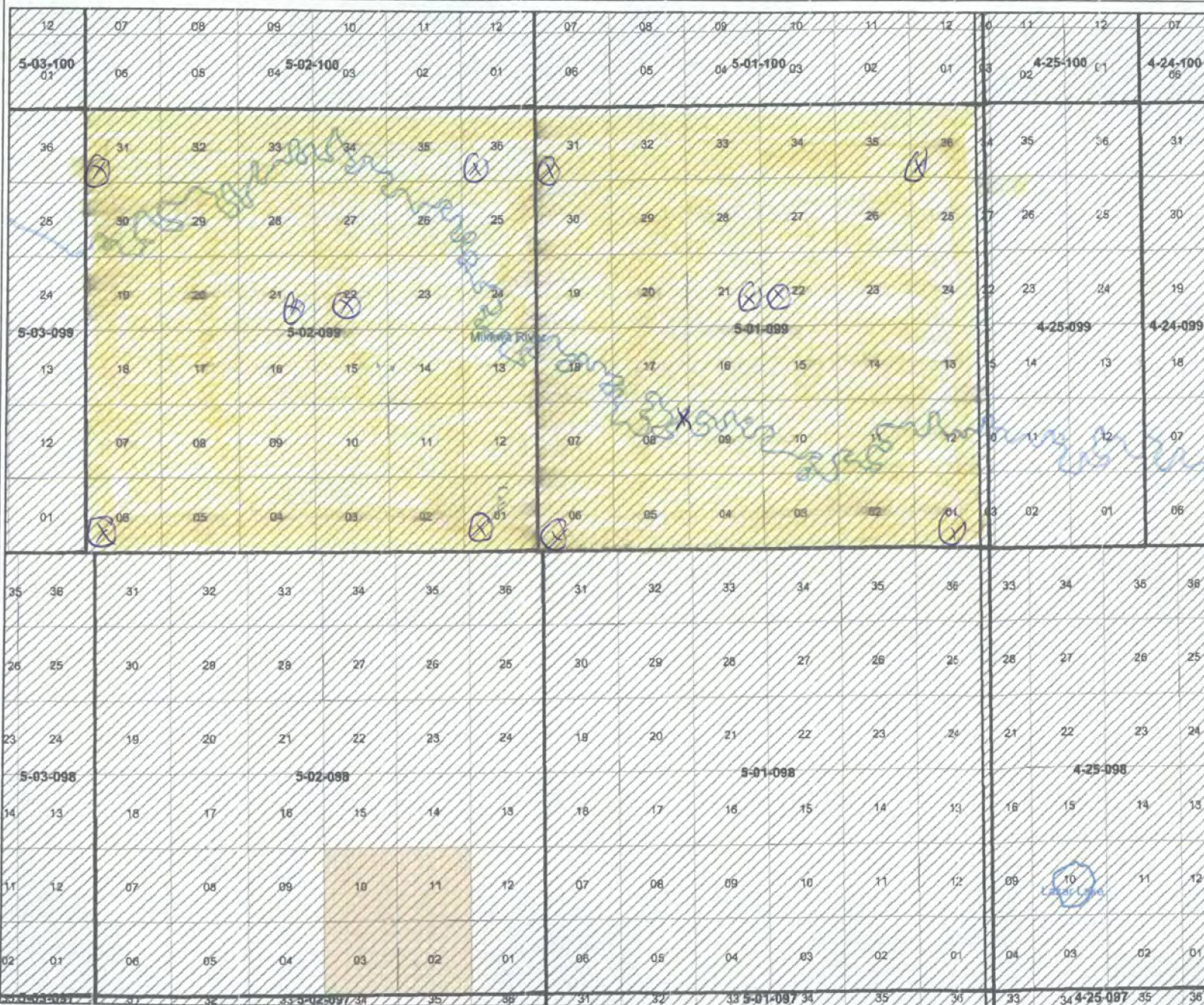

15.

January 26, 2009

DISCLAIMER: Information presented on this map originates from various sources and is for general use only. Please be advised that some information may have been added, amended and deleted since this map was created.

Base Data Provided by Spatial Data Warehouse Ltd. Copyright of Government of Alberta.

Map center: 57°33' N, 114°8' W