

MAR 19770020: DIXONVILLE

Received date: Dec 31, 1977

Public release date: Jan 01, 1979

DISCLAIMER

By accessing and using the Alberta Energy website to download or otherwise obtain a scanned mineral assessment report, you ("User") agree to be bound by the following terms and conditions:

- a) Each scanned mineral assessment report that is downloaded or otherwise obtained from Alberta Energy is provided "AS IS", with no warranties or representations of any kind whatsoever from Her Majesty the Queen in Right of Alberta, as represented by the Minister of Energy ("Minister"), expressed or implied, including, but not limited to, no warranties or other representations from the Minister, regarding the content, accuracy, reliability, use or results from the use of or the integrity, completeness, quality or legibility of each such scanned mineral assessment report;
- b) To the fullest extent permitted by applicable laws, the Minister hereby expressly disclaims, and is released from, liability and responsibility for all warranties and conditions, expressed or implied, in relation to each scanned mineral assessment report shown or displayed on the Alberta Energy website including but not limited to warranties as to the satisfactory quality of or the fitness of the scanned mineral assessment report for a particular purpose and warranties as to the non-infringement or other non-violation of the proprietary rights held by any third party in respect of the scanned mineral assessment report;
- c) To the fullest extent permitted by applicable law, the Minister, and the Minister's employees and agents, exclude and disclaim liability to the User for losses and damages of whatsoever nature and howsoever arising including, without limitation, any direct, indirect, special, consequential, punitive or incidental damages, loss of use, loss of data, loss caused by a virus, loss of income or profit, claims of third parties, even if Alberta Energy have been advised of the possibility of such damages or losses, arising out of or in connection with the use of the Alberta Energy website, including the accessing or downloading of the scanned mineral assessment report and the use for any purpose of the scanned mineral assessment report so downloaded or retrieved.
- d) User agrees to indemnify and hold harmless the Minister, and the Minister's employees and agents against and from any and all third party claims, losses, liabilities, demands, actions or proceedings related to the downloading, distribution, transmissions, storage, redistribution, reproduction or exploitation of each scanned mineral assessment report obtained by the User from Alberta Energy.

(27)

1976-77 Exploration Report on Permits 6896080003-4

These two permit areas were prospected jointly.

They were traversed at regular intervals east to west with one-half mile spacings.

Nothing of any interest was observed. Four draws or coulees, trending N.W. - S.E., were carefully prospected, with no favourable results. Only one sample was taken, which assayed 15% Al_2O_3 which is not uncommon in the shale in this area.

We propose to drop these two Permits.

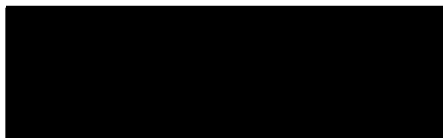

C. C. Bevan

ECONOMIC MINERALS
FILE REPORT NO.
ALN-AF-002(1)
ALN-AF-003(1)

19770020

QUARTZ MINERAL EXPLORATION PERMIT NO. 6876080003

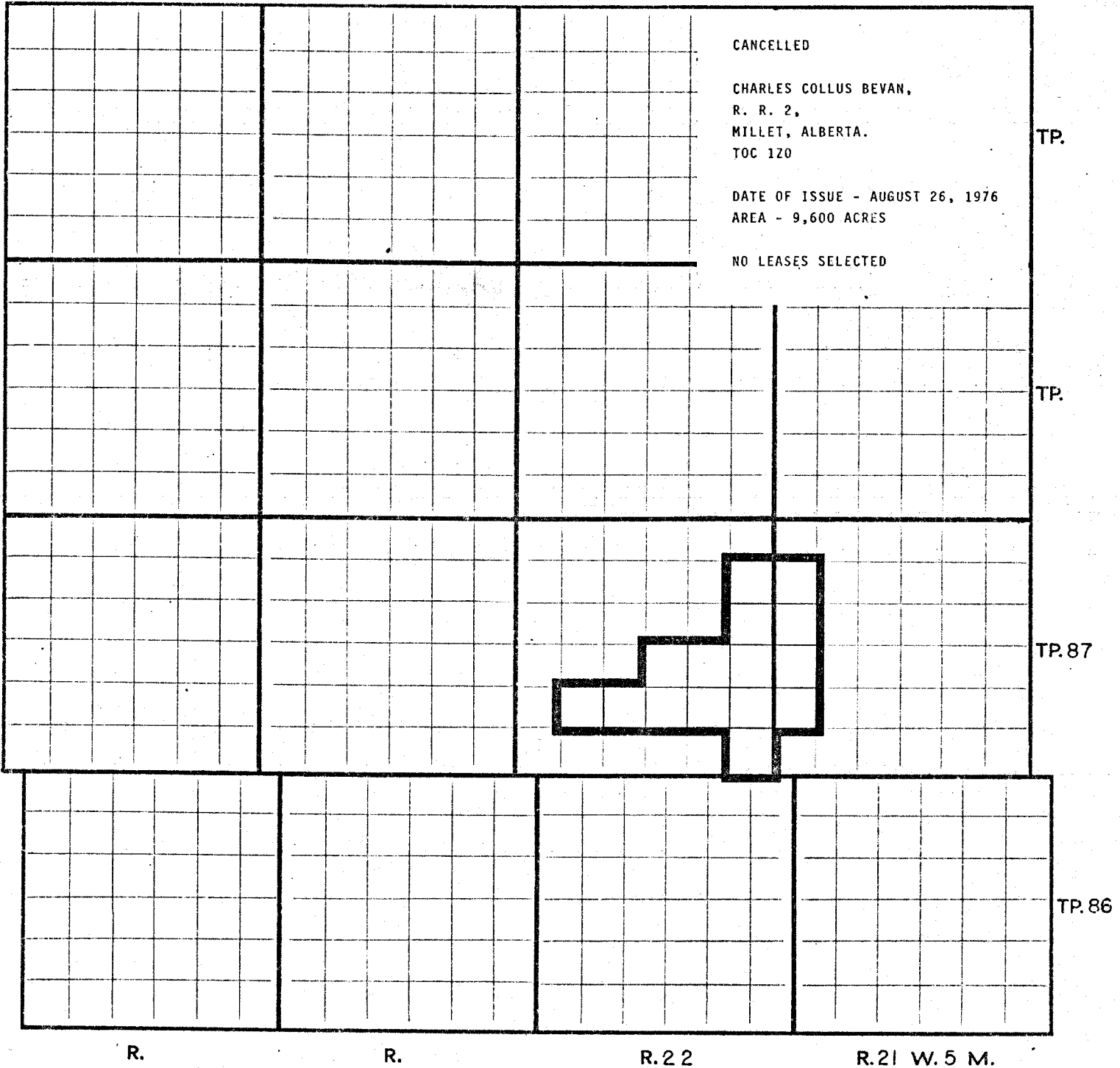

19770020.

QUARTZ MINERAL EXPLORATION PERMIT NO. 6876080004

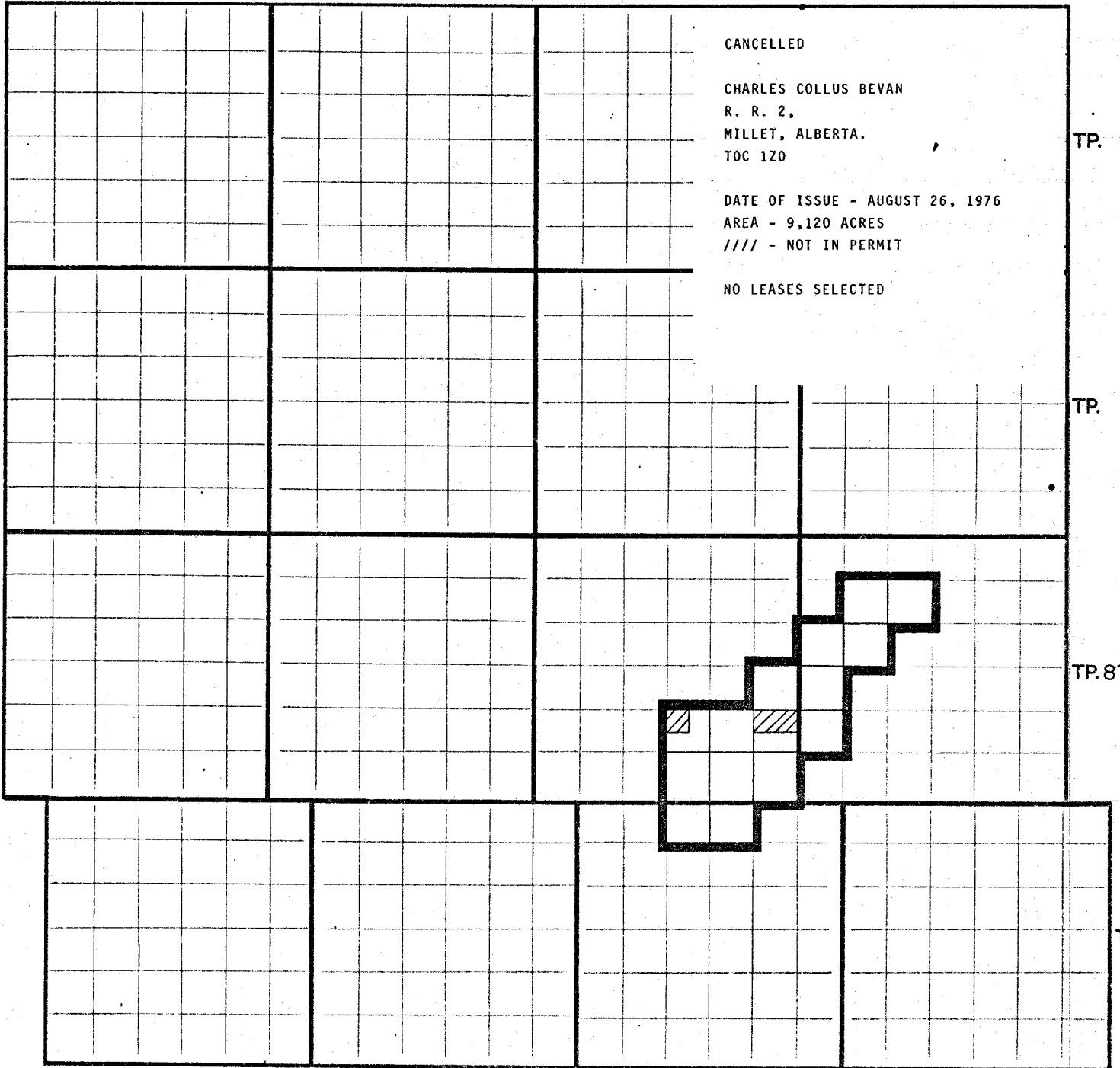

CANCELLED

CHARLES COLLUS BEVAN
R. R. 2,
MILLET, ALBERTA.
TOC 120

DATE OF ISSUE - AUGUST 26, 1976
AREA - 9,120 ACRES
/// - NOT IN PERMIT

NO LEASES SELECTED

TP.

TP.

TP.87

TP.86

R.

R.

R.23

R.22 W.5 M.

QUARTZ MINERAL EXPLORATION
 PERMIT NO'S. 197 AND 198 SHOWN THUS
 PERMIT APPLICATIONS MARKED
 DRILL SITES MARKED
 PERMIT APPLS. APPROVED
 NO'S. 6876080003 AND 6876080004
 MAP 2A

SCALE 1" = 1 MILE C.C. BEVAN

ORIGINAL MAP ON PERMIT 198



TP. 88

TP. 87

TP. 86

24 HOLES DRILLED TO 8' TO 10' ON SEC 4-5-8-9; TP 87, R.23 AND SEC 32, 33, TP 86, R.23. ALL RETURN NIL VALUE MARKED N ALL HOLES RETURNED 1' TO 5' MUCK AND 5' TO 9' SILT TO FINE SAND. 1 HOLE NEAR CENTRE OF SEC 32, TP 86, R.23 AND LOCATED 2600' S AND 22' W OF NE CORNER OF SEC RETURNED 1' SILTY OVERBURDEN, 3' AL. CLAY, EST. 15% AL₂O₃, 3" MARL AND 4' AL. CLAY. SEE DETAIL MAP OF SEC 30.
 DEEPER HOLES RECOMMENDED FOR SEC 30 AND E 1/2 31. SEE MAP 1A FOR PERMIT NO. 197 DETAILS. SEC. 1-2-11-12 ARE FAVORABLE GROUND.

5 PITS ON SEC 28, TP 87, R.22. RETURNED 6" OB, 6" AL. CLAY THAT ASSAYED 15% AL₂O₃, 55% OF SI, 3 TO 6% FE, LOW ALK'S. AND NA.

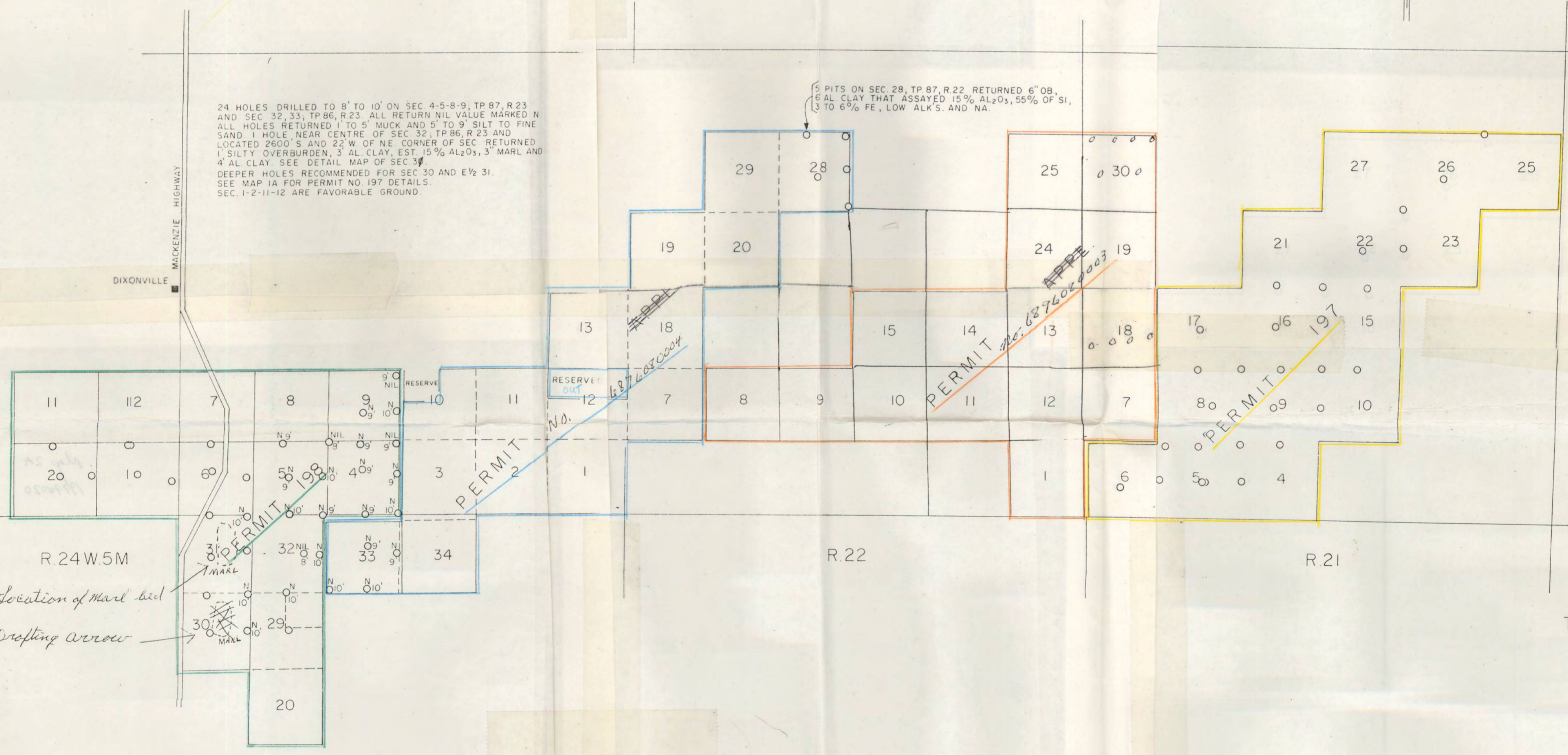

Location of Marl bed
 Drafting Arrow