

MAR 19700020: LA BUTTE CREEK

Received date: Dec 31, 1970

Public release date: Jan 01, 1972

DISCLAIMER

By accessing and using the Alberta Energy website to download or otherwise obtain a scanned mineral assessment report, you ("User") agree to be bound by the following terms and conditions:

- a) Each scanned mineral assessment report that is downloaded or otherwise obtained from Alberta Energy is provided "AS IS", with no warranties or representations of any kind whatsoever from Her Majesty the Queen in Right of Alberta, as represented by the Minister of Energy ("Minister"), expressed or implied, including, but not limited to, no warranties or other representations from the Minister, regarding the content, accuracy, reliability, use or results from the use of or the integrity, completeness, quality or legibility of each such scanned mineral assessment report;
- b) To the fullest extent permitted by applicable laws, the Minister hereby expressly disclaims, and is released from, liability and responsibility for all warranties and conditions, expressed or implied, in relation to each scanned mineral assessment report shown or displayed on the Alberta Energy website including but not limited to warranties as to the satisfactory quality of or the fitness of the scanned mineral assessment report for a particular purpose and warranties as to the non-infringement or other non-violation of the proprietary rights held by any third party in respect of the scanned mineral assessment report;
- c) To the fullest extent permitted by applicable law, the Minister, and the Minister's employees and agents, exclude and disclaim liability to the User for losses and damages of whatsoever nature and howsoever arising including, without limitation, any direct, indirect, special, consequential, punitive or incidental damages, loss of use, loss of data, loss caused by a virus, loss of income or profit, claims of third parties, even if Alberta Energy have been advised of the possibility of such damages or losses, arising out of or in connection with the use of the Alberta Energy website, including the accessing or downloading of the scanned mineral assessment report and the use for any purpose of the scanned mineral assessment report so downloaded or retrieved.
- d) User agrees to indemnify and hold harmless the Minister, and the Minister's employees and agents against and from any and all third party claims, losses, liabilities, demands, actions or proceedings related to the downloading, distribution, transmissions, storage, redistribution, reproduction or exploitation of each scanned mineral assessment report obtained by the User from Alberta Energy.



LARIAT OIL & GAS LTD.

143950
144240

ROOM 38, HOLLINSWORTH BUILDING

301 - 8TH AVENUE S.W.

CALGARY 2, ALBERTA

ECONOMIC MINERALS

FILE REPORT No.

U-AF-098(2)

September 21st, 1970.

Director of Minerals,
Department of Mines and Minerals,
Government of the Province of Alberta,
EDMONTON, Alberta.

Re: Quartz Mineral Permit No's. 144 and 146

Dear Sir:

I wish to surrender the subject quartz mineral permits and obtain refund of the \$2,000. deposit.

Permit No. 144 was filed on by R. E. Alexander on September 30th, 1969 and transferred to Lariat Oil & Gas Ltd. on April 9th, 1970. Permit No. 146 was filed on by Fiesta Oil and Gas Ltd. on November 10th, 1969 and transferred to Lariat Oil & Gas Ltd. on April 9th, 1970.

Lariat Oil & Gas Ltd. hired G. V. Lloyd Exploration Ltd. to conduct a preliminary survey of the properties during the summer of 1970. This comprised outcrop examination, and a ground magnetometer and geochemical program. The field crew consisted of four men headed by a professional prospector. Two weeks were spent doing the program. No time breakdown has been given me, but it is apparent that the majority of the time was spent on Permit No. 144.

The magnetometer results are shown in the enclosed reports.

The rock specimen taken near magnetometer station BL + 40S on Permit No. 144 is a coarse grained granite comprising mainly pink feldspar and quartz and exhibiting a very faint gneissosity. The chief mafic mineral is chlorite. The rock contains abundant hair line fractures having a hematite stain.

..... 2

The geochemical results of the stream sediment samples taken from Permit No. 144 at the locations shown on the enclosed map are as follows: - *(Map No. 1)*

<u>Sample No.</u>	<u>Concentration - ppm</u>				
	<u>Cu</u>	<u>Zn</u>	<u>Pb</u>	<u>Ni</u>	<u>Co</u>
1	13	76	18	25	14
2	12	58	22	25	14
3	18	78	24	31	18
4	14	71	22	27	14
5	14	74	22	27	13
6	12	63	18	21	10
7	12	66	18	21	10
8	16	78	24	29	13
9	22	74	28	35	16
10	14	76	24	27	16
11	20	84	24	31	16

These samples were analysed under the supervision of G. Anselmo, Tri-Con Exploration Surveys Ltd., 1405 Hunter St., North Vancouver, B.C.

The expenditures incurred in the examination amounted to \$5,130.47. I enclose a statutory declaration and a copy of the invoices with supporting receipts from G. V. Lloyd Exploration Ltd. for \$5,094.47. Mr. Anselmo has advised me by telephone that the geochemical analyses will cost \$36.00, but an invoice has not as yet been sent. I have not included our office overhead which I would estimate to be in the order of \$500.00.

I hope this meets with your satisfaction.

Yours truly ✓



Don J. Turner, P. Eng.,
Vice-President & General Manager,
Lariat Oil & Gas Ltd.

Encl.

G. V. LLOYD EXPLORATION LTD.

ALBERTA HAIL INSURANCE BUILDING
703 FIFTH STREET S.W.
CALGARY 2, ALBERTA

PHONE 262-3605
AREA CODE 403

August 25, 1970.

Mr. D. Turner,
Lariat Oil and Gas Ltd.,
38 Hollingsworth Bldg.,
Calgary, Alberta.

Dear Mr. Turner: Re: Geochemical Sampling Program

Attached, herewith is a sketch map showing the sampled localities No. 1 to 11 (inclusive) where stream sediments were collected during our recent ground magnetic survey in the area.

May we have your instructions regarding these samples.

Yours very truly,

G. V. LLOYD EXPLORATION LTD.,

GVL/rp
Encl.

G. V. Lloyd, President.

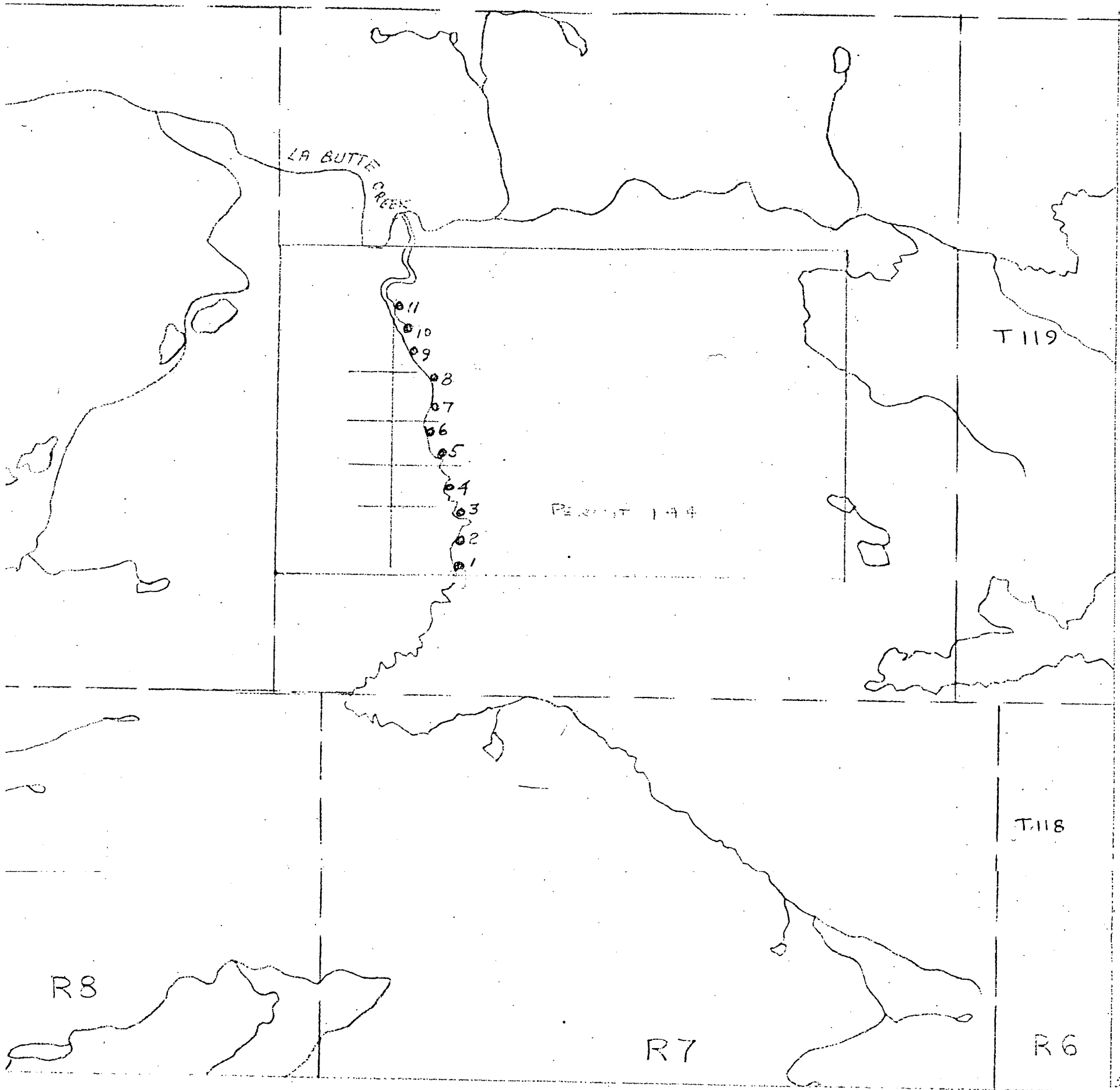

● STREAM SEDIMENT
SAMPLE - JUNE 1970

↑
N
1" = 1 Mile

G.V. LLOYD EXPLORATION LTD
CALGARY

19700020
Map No. 1 (2)

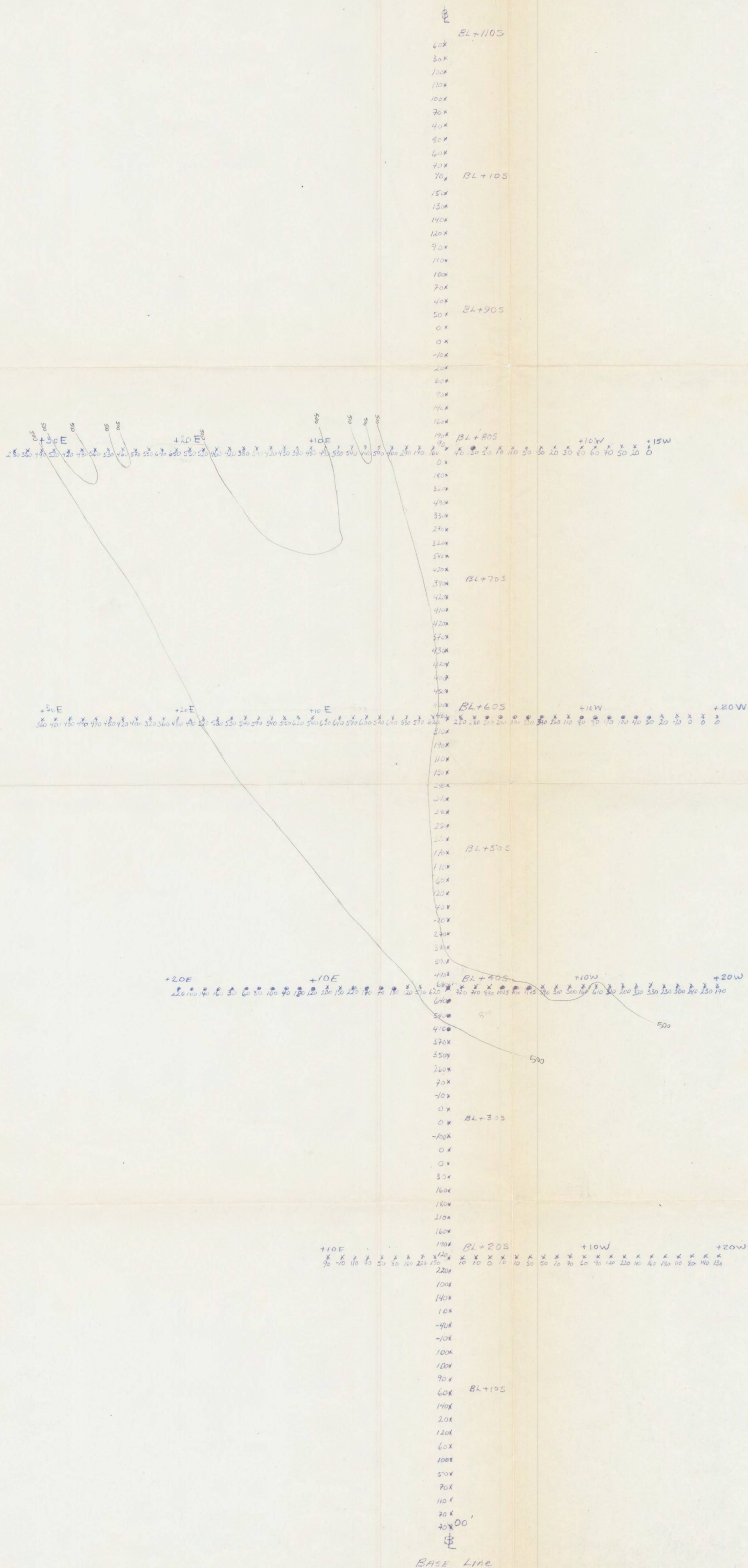
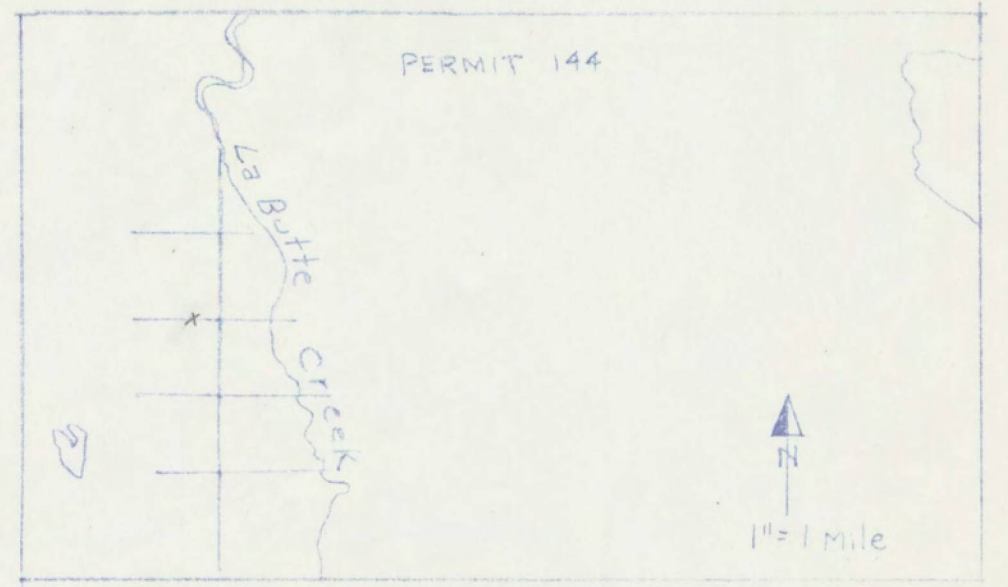

LEGEND
 Station - x
 Outcrop - •
 Instrument - Sharpe MF-2 Fluxgate
 Magnetic intensities in Gammas

MAP NO. 1 (1)
MAGNETIC INTENSITY MAP
PERMIT NO. 144
LA BUTTE CREEK AREA
ALBERTA
 PREPARED FOR
LARIAT OIL AND GAS LTD.

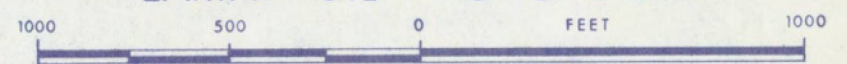

Values by J. YOUNG Interval _____
 Interpretation by _____ Datum _____
 Drawn by M. TORONTOW Date AUGUST 1970

G.V. LLOYD EXPLORATION LTD.

17900020
 Map No. 1(1)

BASE Line