

# MAR 19690063: NAMUR LAKE

Received date: Dec 31, 1969

Public release date: Jan 01, 1971

## **DISCLAIMER**

By accessing and using the Alberta Energy website to download or otherwise obtain a scanned mineral assessment report, you ("User") agree to be bound by the following terms and conditions:

- a) Each scanned mineral assessment report that is downloaded or otherwise obtained from Alberta Energy is provided "AS IS", with no warranties or representations of any kind whatsoever from Her Majesty the Queen in Right of Alberta, as represented by the Minister of Energy ("Minister"), expressed or implied, including, but not limited to, no warranties or other representations from the Minister, regarding the content, accuracy, reliability, use or results from the use of or the integrity, completeness, quality or legibility of each such scanned mineral assessment report;
- b) To the fullest extent permitted by applicable laws, the Minister hereby expressly disclaims, and is released from, liability and responsibility for all warranties and conditions, expressed or implied, in relation to each scanned mineral assessment report shown or displayed on the Alberta Energy website including but not limited to warranties as to the satisfactory quality of or the fitness of the scanned mineral assessment report for a particular purpose and warranties as to the non-infringement or other non-violation of the proprietary rights held by any third party in respect of the scanned mineral assessment report;
- c) To the fullest extent permitted by applicable law, the Minister, and the Minister's employees and agents, exclude and disclaim liability to the User for losses and damages of whatsoever nature and howsoever arising including, without limitation, any direct, indirect, special, consequential, punitive or incidental damages, loss of use, loss of data, loss caused by a virus, loss of income or profit, claims of third parties, even if Alberta Energy have been advised of the possibility of such damages or losses, arising out of or in connection with the use of the Alberta Energy website, including the accessing or downloading of the scanned mineral assessment report and the use for any purpose of the scanned mineral assessment report so downloaded or retrieved.
- d) User agrees to indemnify and hold harmless the Minister, and the Minister's employees and agents against and from any and all third party claims, losses, liabilities, demands, actions or proceedings related to the downloading, distribution, transmissions, storage, redistribution, reproduction or exploitation of each scanned mineral assessment report obtained by the User from Alberta Energy.

ECONOMIC MINERALS

FILE REPORT No.

S-AF-092(1)

S-AF-093(1)

FINAL REPORT

ALBERTA SULPHUR PROSPECTING PERMITS 92 & 93

(NAMUR)

Prepared by:

CANADIAN SUPERIOR OIL LTD.

JANUARY, 1969

TABLE OF CONTENTS

	Page
LOCATION .....	1
ACCESSIBILITY .....	1
TOPOGRAPHY .....	1
GEOLOGY .....	1
EXPLORATION .....	3

- 1

FINAL REPORT

ALBERTA SULPHUR PROSPECTING PERMITS 92 & 93 (NAMUR)

LOCATION:

Sulphur Prospecting Permits 92 & 93 (Namur) are located in northeastern Alberta, bounded by Namur Lake to the east and Legend Lake to the west. The permit areas comprise 119,885 acres within Townships 95, 96, 97 and 98, Ranges 17 & 18 west of the 4th meridian.

ACCESSIBILITY:

The area is accessible from Ft. McKay by road and by bush trail for the final 50 miles.

TOPOGRAPHY:

The acreage varies in elevation from 2700' in the northeast corner of the block to 2100' in the southwest corner. The area is generally flat with the exception of the southwest corner which is hilly.

GEOLOGY:

The Namur permit area lies in the east flank of the Alberta syncline with the beds striking in a northwesterly direction and dipping to the southwest.

The stratigraphic sequence is summarized in the following table:

GENERALIZED STRATIGRAPHIC SECTION

<u>AGE</u>	<u>FORMATION</u>	<u>LITHOLOGY</u>	<u>THICKNESS</u>
Pleistocene	Glacial Till		
-----Erosional Unconformity-----			
Cretaceous	Viking Joli Fou McMurray	Deltaic & Marine Sandstone & Shale	1000'
-----Erosional Unconformity-----			
Devonian	Beaverhill Lk.	Limestone & Shale	200'
	Slave Point	Limestone, Argillaceous & Anhydrite	400'
	Ft. Vermilion	Shale	50'
	Watt Mtn.	Shale & Siltstone	50'
	Muskeg	Shale & Anhydrite	50'
	Winnipegosis	Shale & Dolomite	700'
	Elk Point		100'
PreDevonian		Granite Wash	400'
PreCambrian		Granite	

EXPLORATION:

Sulphur Prospecting Permits 92 & 93 (Namur) were granted to Canadian Superior Oil Ltd. (50%) and Amerada Petroleum Corporation (50%) on January 11, 1968. A seismic survey over the permit areas was commenced on December 29, 1967 and completed on January 28, 1968.

In order to evaluate the sulphur potential of the permits three sets of grab samples to a depth of 45 feet were taken from seven randomly spaced shot holes in the seismic program. The grab samples were analysed for sulphur content and the results--expressed as per cent by weight of sulphur--are tabulated below:

Sample No.	% Sulphur by weight
1	2.66
2	4.23
3	1.84
4	1.42
5	2.69
6	1.96
7	11.49

Enclosed is a map outlining the permits and showing location of samples. The sulphur sample analyses and distribution indicate a non-economic sulphur prospect area and consequently permits 92 & 93 are being surrendered.

---

 H. J. CAINE

Registered Professional Geologist

RWT/lmg

SULPHUR PROSPECTING PERMIT No. 92

CANCELLED

AMERADA PETROLEUM CORPORATION, and  
CANADIAN SUPERIOR OIL LTD.,  
% CANADIAN SUPERIOR OIL LTD.,  
703 - 6th AVENUE S.W.,  
CALGARY, ALBERTA

DATE OF ISSUE - JANUARY 11, 1968  
AREA - 59,885 ACRES

NO LEASES SELECTED

*E 000 P1*

TP. 98

TP. 97

TP. 96

R.18

R.17

R.16 W. 4 M.

*84417  
SE*

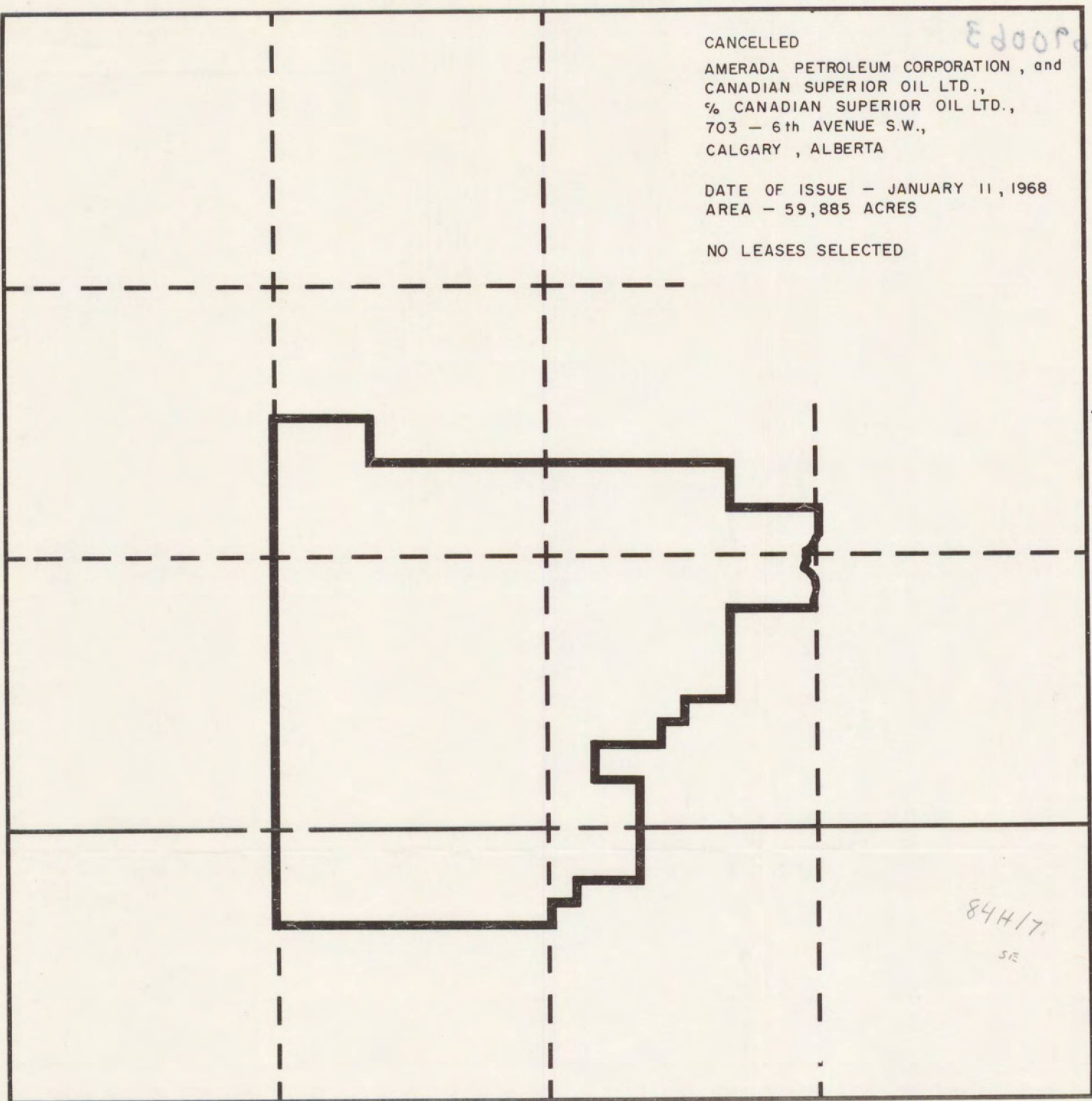





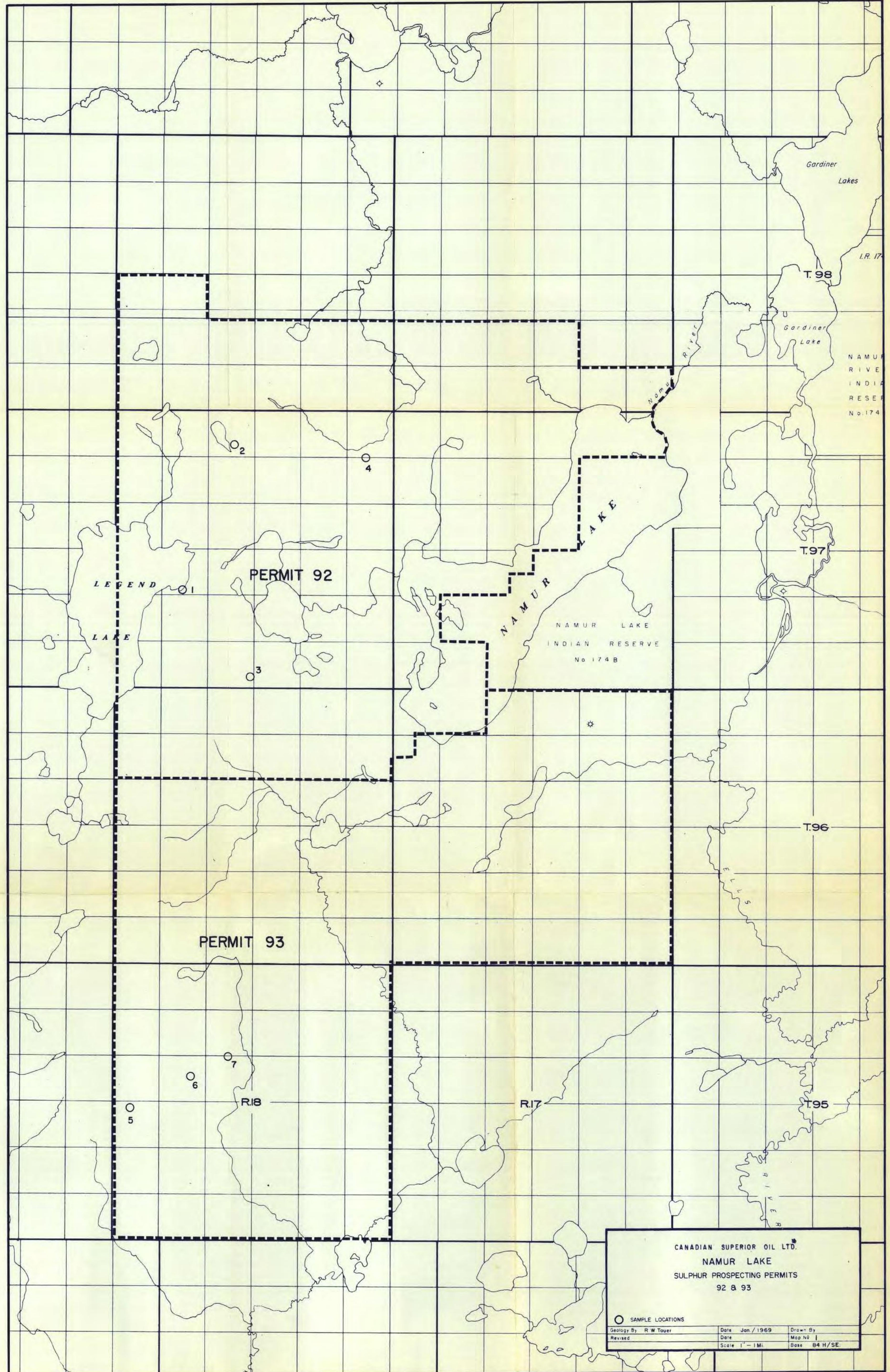

LEFEND  
LAKE

PERMIT 92

PERMIT 93

NAMUR  
LAKE

NAMUR LAKE  
INDIAN RESERVE  
No 174B

Gardiner  
Lakes

Gardiner  
Lake

T.97

T.96

T.95

NAMUR  
RIVER

NAMUR  
RIVER

CANADIAN SUPERIOR OIL LTD.  
NAMUR LAKE  
SULPHUR PROSPECTING PERMITS  
92 & 93

○ SAMPLE LOCATIONS

Geology By R.W. Tower	Date Jan / 1969	Drawn By
Revised	Date	Map No
	Scale 1" = 1 MI.	Base 84 H/SE.