

# MAR 19690057: NORTHERN ALBERTA

Received date: Dec 31, 1969

Public release date: Jan 01, 1971

## **DISCLAIMER**

By accessing and using the Alberta Energy website to download or otherwise obtain a scanned mineral assessment report, you ("User") agree to be bound by the following terms and conditions:

- a) Each scanned mineral assessment report that is downloaded or otherwise obtained from Alberta Energy is provided "AS IS", with no warranties or representations of any kind whatsoever from Her Majesty the Queen in Right of Alberta, as represented by the Minister of Energy ("Minister"), expressed or implied, including, but not limited to, no warranties or other representations from the Minister, regarding the content, accuracy, reliability, use or results from the use of or the integrity, completeness, quality or legibility of each such scanned mineral assessment report;
- b) To the fullest extent permitted by applicable laws, the Minister hereby expressly disclaims, and is released from, liability and responsibility for all warranties and conditions, expressed or implied, in relation to each scanned mineral assessment report shown or displayed on the Alberta Energy website including but not limited to warranties as to the satisfactory quality of or the fitness of the scanned mineral assessment report for a particular purpose and warranties as to the non-infringement or other non-violation of the proprietary rights held by any third party in respect of the scanned mineral assessment report;
- c) To the fullest extent permitted by applicable law, the Minister, and the Minister's employees and agents, exclude and disclaim liability to the User for losses and damages of whatsoever nature and howsoever arising including, without limitation, any direct, indirect, special, consequential, punitive or incidental damages, loss of use, loss of data, loss caused by a virus, loss of income or profit, claims of third parties, even if Alberta Energy have been advised of the possibility of such damages or losses, arising out of or in connection with the use of the Alberta Energy website, including the accessing or downloading of the scanned mineral assessment report and the use for any purpose of the scanned mineral assessment report so downloaded or retrieved.
- d) User agrees to indemnify and hold harmless the Minister, and the Minister's employees and agents against and from any and all third party claims, losses, liabilities, demands, actions or proceedings related to the downloading, distribution, transmissions, storage, redistribution, reproduction or exploitation of each scanned mineral assessment report obtained by the User from Alberta Energy.

ECONOMIC MINERALS

FILE REPORT No.

S-AF-064(1)

FINAL REPORT ON SULPHUR EXPLORATION  
SULPHUR PROSPECTING PERMIT NO. 64  
TWP. 108, 109, RGE. 2, 3 W5M

---

Sulphur Prospecting Permit No. 64 (39,680 acres) was acquired by Texaco Exploration on December 18, 1967 and renewed for six months on December 18, 1968. Exploration on the Permit was conducted during January 1969 and consisted of one hundred fifty twelve foot deep auger holes drilled at 1,000 foot intervals along existing trails and seismic lines. Two samples were taken from each hole and a qualitative test for sulphur and semi-quantitative test for water soluble sulphate were made on each sample. No sulphur was detected in any of the 300 samples and sulphate contents were too variable to be diagnostic. It has been decided to surrender Permit No. 64.

TEXACO EXPLORATION COMPANY



W. H. Rimmer, Chief Geologist

TD/dl

Calgary, Alberta,  
April 29, 1969.

FINAL REPORT ON SULPHUR EXPLORATION  
SULPHUR PROSPECTING PERMIT NO. 64  
TWP. 108, 109, RGE. 2, 3 W5M

---

Sulphur Prospecting Permit No. 64 (39,680 acres) was acquired by Texaco Exploration on December 18, 1967 and renewed for six months on December 18, 1968. Exploration on the Permit was conducted during January 1969 and consisted of one hundred fifty twelve foot deep auger holes drilled at 1,000-foot intervals along existing trails and seismic lines. Two samples were taken from each hole and a qualitative test for sulphur and semi-quantitative test for water soluble sulphate were made on each sample. No sulphur was detected in any of the 300 samples and sulphate contents were too variable to be diagnostic. It has been decided to surrender Permit No. 64.

TEXACO EXPLORATION COMPANY



TD/dl

W. H. Rimmer, Chief Geologist

Calgary, Alberta,  
April 29, 1969.

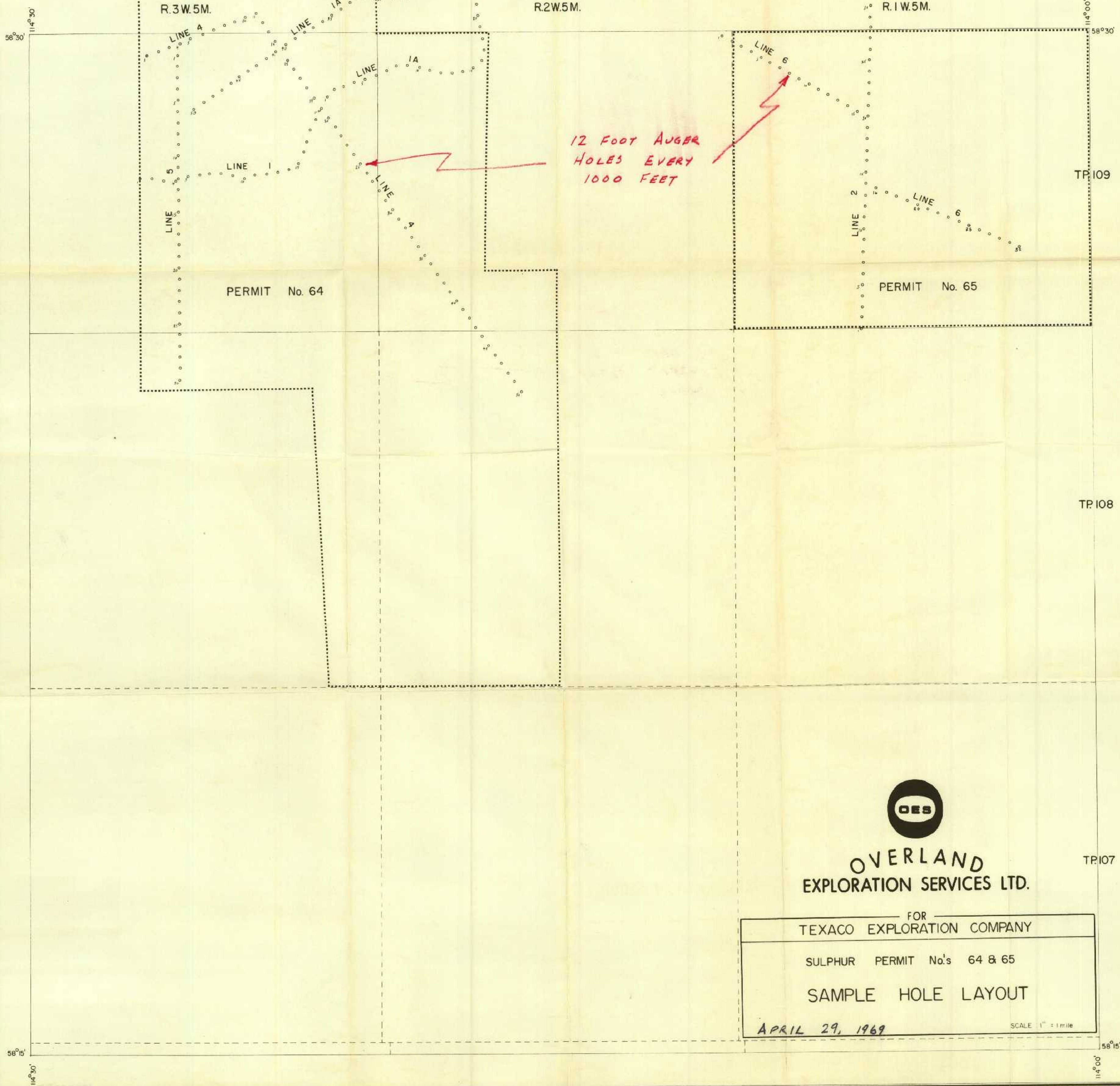

OVERLAND  
EXPLORATION SERVICES LTD.

FOR  
TEXACO EXPLORATION COMPANY

---

SULPHUR PERMIT No's 64 & 65

SAMPLE HOLE LAYOUT

APRIL 29, 1969

SCALE 1" = 1 mile

# SULPHUR PROSPECTING PERMIT NO. 64

TEXACO EXPLORATION COMPANY,  
600 - 6th AVENUE S.W.,  
CALGARY, ALBERTA.

DATE OF ISSUE — DECEMBER 18, 1967  
AREA — 39,680 ACRES.

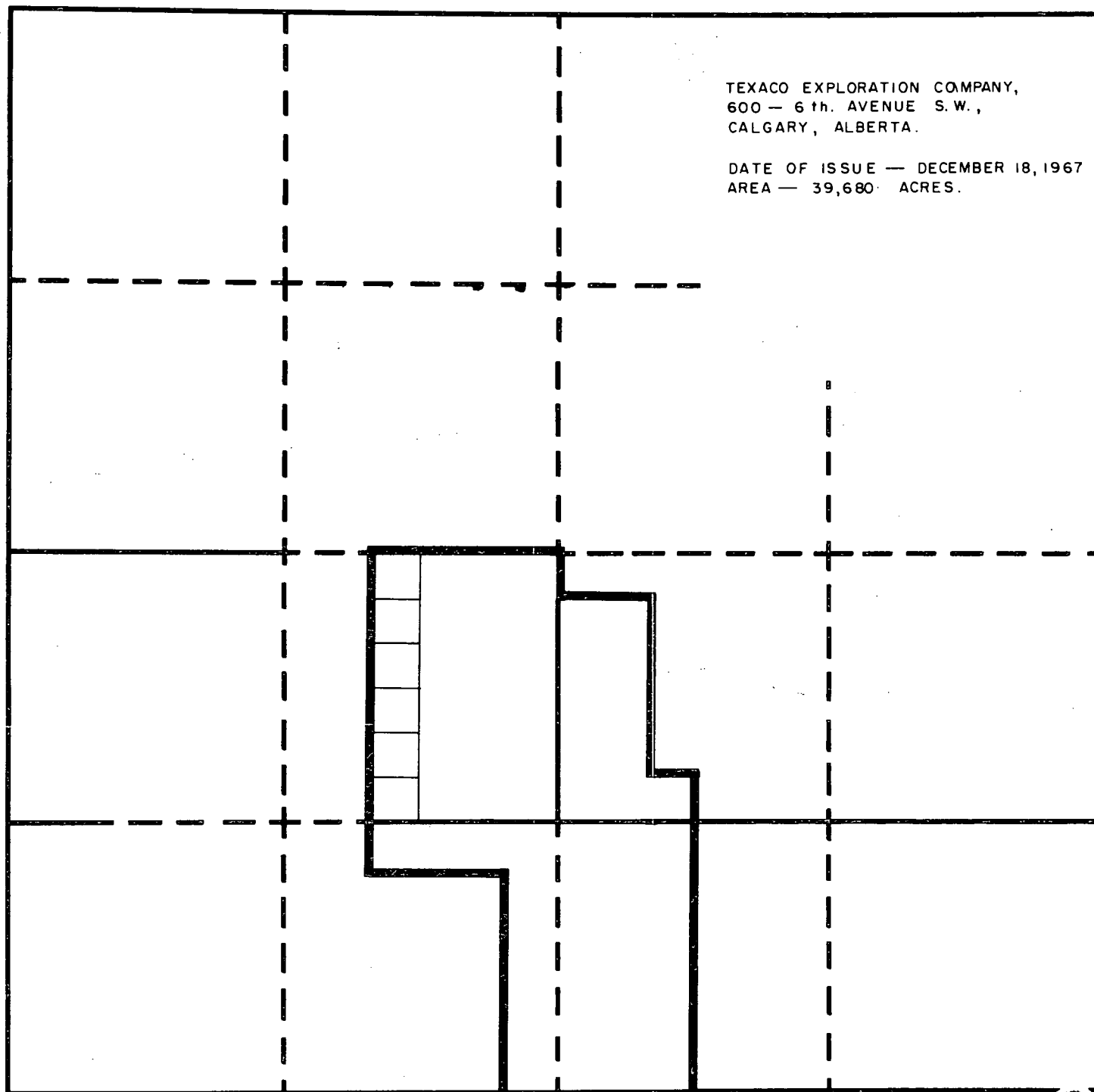

R. 3

R. 2

R. 1 W. 5 M.

TP. 109

TP. 108

845/8