

MAR 19680146: NORTHERN ALBERTA

Received date: Dec 31, 1968

Public release date: Jan 01, 1970

DISCLAIMER

By accessing and using the Alberta Energy website to download or otherwise obtain a scanned mineral assessment report, you ("User") agree to be bound by the following terms and conditions:

- a) Each scanned mineral assessment report that is downloaded or otherwise obtained from Alberta Energy is provided "AS IS", with no warranties or representations of any kind whatsoever from Her Majesty the Queen in Right of Alberta, as represented by the Minister of Energy ("Minister"), expressed or implied, including, but not limited to, no warranties or other representations from the Minister, regarding the content, accuracy, reliability, use or results from the use of or the integrity, completeness, quality or legibility of each such scanned mineral assessment report;
- b) To the fullest extent permitted by applicable laws, the Minister hereby expressly disclaims, and is released from, liability and responsibility for all warranties and conditions, expressed or implied, in relation to each scanned mineral assessment report shown or displayed on the Alberta Energy website including but not limited to warranties as to the satisfactory quality of or the fitness of the scanned mineral assessment report for a particular purpose and warranties as to the non-infringement or other non-violation of the proprietary rights held by any third party in respect of the scanned mineral assessment report;
- c) To the fullest extent permitted by applicable law, the Minister, and the Minister's employees and agents, exclude and disclaim liability to the User for losses and damages of whatsoever nature and howsoever arising including, without limitation, any direct, indirect, special, consequential, punitive or incidental damages, loss of use, loss of data, loss caused by a virus, loss of income or profit, claims of third parties, even if Alberta Energy have been advised of the possibility of such damages or losses, arising out of or in connection with the use of the Alberta Energy website, including the accessing or downloading of the scanned mineral assessment report and the use for any purpose of the scanned mineral assessment report so downloaded or retrieved.
- d) User agrees to indemnify and hold harmless the Minister, and the Minister's employees and agents against and from any and all third party claims, losses, liabilities, demands, actions or proceedings related to the downloading, distribution, transmissions, storage, redistribution, reproduction or exploitation of each scanned mineral assessment report obtained by the User from Alberta Energy.

19680146

REPORT ON FIELD EXAMINATION

GEORGE LONN

SULPHUR PERMITS NOS. 179 AND 180

NORTHERN ALBERTA

THIS REPORT HAS BEEN PREPARED
FOR THE EXCLUSIVE USE OF:

George Lonn

COPY NO:..... 3

EARNSCLOUGH

LINEN BOND

40% FIBRE CONTENT - CANADA



ECONOMIC MINERALS

FILE REPORT No.

S-AF-179(1)
S-AF-180(1)

REPORT ON FIELD EXAMINATION

GEORGE LONN

SULPHUR PERMITS NOS. 179 AND 180

NORTHERN ALBERTA

Prepared For

George Lonn

November, 1968

J. C. SPROULE AND ASSOCIATES LTD.

OIL AND GAS ENGINEERING AND GEOLOGICAL CONSULTANTS

REPORT ON FIELD EXAMINATION

GEORGE LONN

SULPHUR PERMITS NOS. 179 AND 180

NORTHERN ALBERTA

The field work on these Permits has been carried out at the request of Mr. George Lonn. The request made was for as abbreviated a field operation as is practical so long as the sulphur prospects are adequately checked.

The field work was conducted by U. Mayr. The sample locations representing surface samples from Permits Nos. 179 and 180 are given on the accompanying Figure 1 and the related analyses by Chemical and Geological Laboratories Ltd. constitute Appendix I attached hereto.

With reference to these results, it will be observed that one of the samples (179-2) from Permit No. 179 analyzed 20.84 percent sulphur, and the other (179-1) only a trace of sulphur. The material penetrated was muskeg and this is normally high in sulphur in lake or depressional areas where sulphur is known. Although one good value was obtained, the muskeg areas in this Permit are very small and hence are unlikely to contain occurrences of native sulphur in sufficient quantities to justify further exploratory activity.

Four samples were taken from Sulphur Permit No. 180 and these also consist of muskeg debris. Analyses of these samples varied from trace to 33.93 percent sulphur content. In view of the general positive nature of these results and since Permit No. 180 is well endowed with large muskeg areas, additional exploratory activity is warranted. In order to fulfill this phase of exploration, it is suggested that the southern two-thirds of the Permit be retained for the time being. The area recommended for retention is shown on the attached Figure 1.

Under the circumstances, we recommend that Sulphur Prospecting Permit No. 179 be abandoned and that the return of the deposit be requested.

Sulphur Prospecting Permit No. 180 should be retained in part, as above described, and some effort should be made to initiate, or at least activate, additional exploratory activity on this Permit, if not personally, then by another party.

We will be pleased to submit an estimate of the cost of conducting an adequate exploration sampling program over the area recommended for retention at such time as a complete analysis of costs and performance of the past season's operations have been completed.



H.B. Lyall, P. Geol.

J.C. Sproule, P. Geol.

1009 Fourth Avenue S.W.,
Calgary 2, Alberta.
November 14, 1968.
HBL:JCS:ldl

CHEMICAL & GEOLOGICAL LABORATORIES LTD.

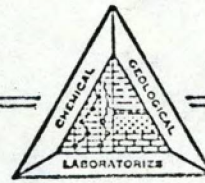
14240-115 AVENUE, EDMONTON, ALBERTA



Date Reported: October 11, 1968

Laboratory Report Number: C68-4157

J. C. SPROULE & ASSOCIATES LTD.

Kind of Sample: Soil

Date Received: October 3, 1968

<u>SAMPLE NUMBER</u>	<u>DEPTH IN FEET</u>	<u>ELEMENTAL SULFUR</u>	
		<u>(% by Weight on Dry Sample)</u>	<u>(% by Weight on Wet Sample)</u>
179-1	-	Trace	Trace
179-2	-	20.84	5.03
180-1	-	33.93	8.02
180-2	-	8.77	2.01
180-3	-	Trace	Trace
180-4	-	11.37	2.87

SULPHUR PROSPECTING PERMIT No. 179

GEORGE LONN,
██████████,
TORONTO, ONTARIO

DATE OF ISSUE - FEBRUARY 27, 1968
AREA - 19,840 ACRES

R. 12

R. 11

R. 10 W. 5 M.

TP. 101

84 G/
12+13
NW

TP. 100

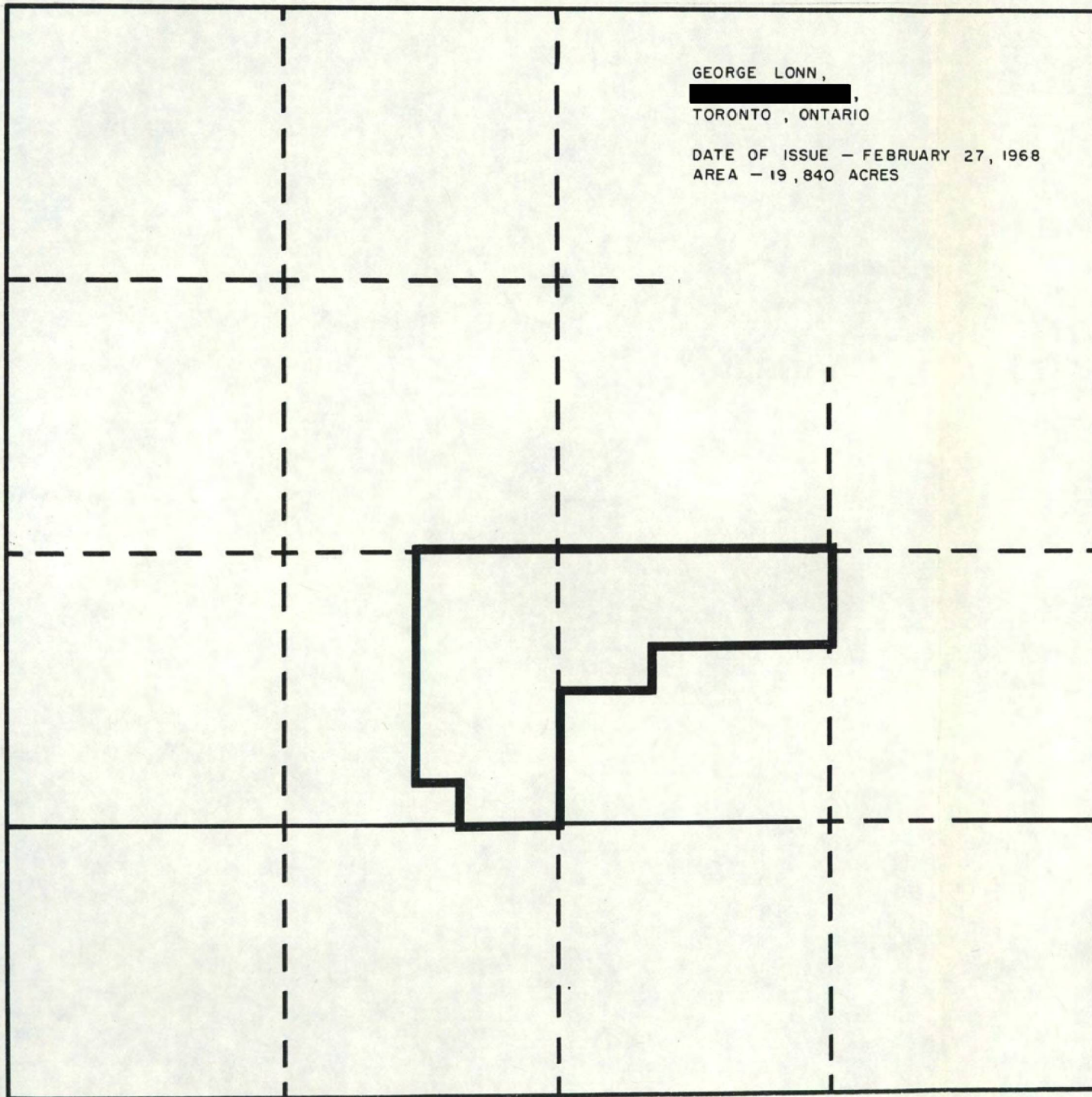

SULPHUR PROSPECTING PERMIT No. 180

GEORGE MAXWELL PEACOCK,

EDMONTON, ALBERTA.

DATE OF ISSUE — FEBRUARY 27, 1968

AREA — 19,840 ACRES.

84K/1

SE

TP. 106

TP. 105

R. 13

R. 12 W. 5 M

R.13 W.5

116°00'

T. 106

58° 10'

T. 105

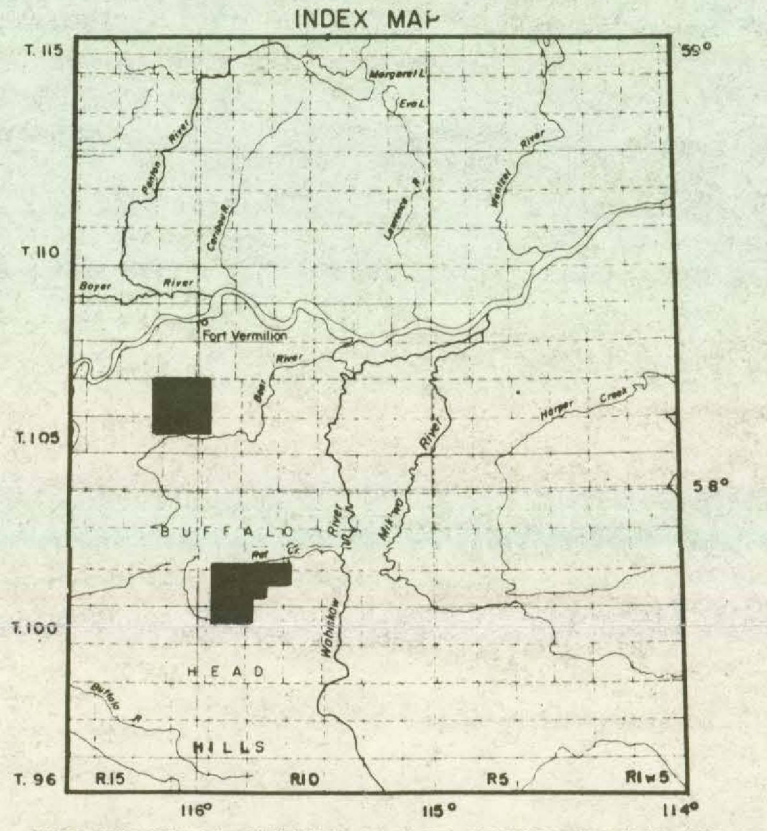

LEGEND

- SURFICIAL DEPOSITS**
- Muskeg
- PHOTOLOGICAL SYMBOLS**
- Scarp
- Alignment interpreted to indicate faulting or fracturing in bedrock
- Alignment of probable geological significance
- Slump
- AREA 1, 2 etc.
- Sulphur prospecting permit outline
- Sample Location
- Outline of area recommended for retention

R. 12

115° 45'

R. 11 W.5

T. 101

57° 45'

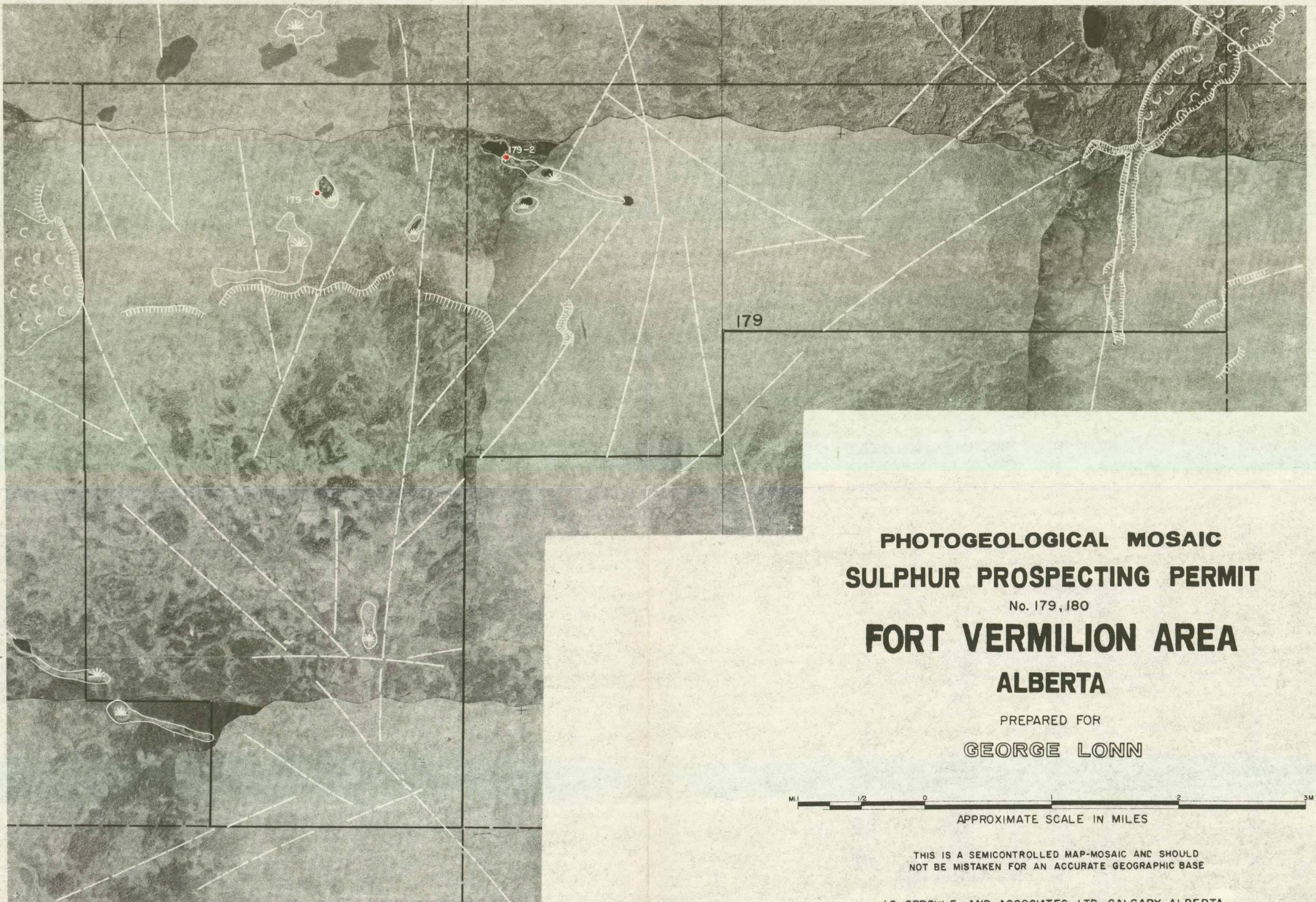

PHOTOLOGICAL MOSAIC
SULPHUR PROSPECTING PERMIT
 No. 179, 180
FORT VERMILION AREA
ALBERTA

PREPARED FOR
GEORGE LONN

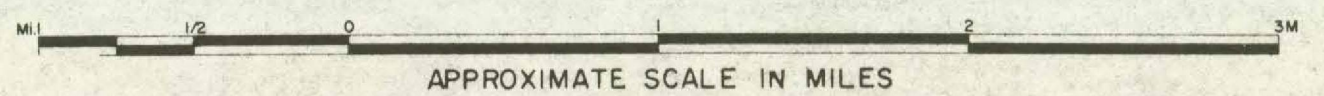

THIS IS A SEMICONTROLLED MAP-MOSAIC AND SHOULD NOT BE MISTAKEN FOR AN ACCURATE GEOGRAPHIC BASE

J.C. SPOULE AND ASSOCIATES LTD. CALGARY, ALBERTA

NOVEMBER 1968

17680146
 Figure 1