

MAR 19680140: NORTHERN ALBERTA

Received date: Dec 31, 1968

Public release date: Jan 01, 1970

DISCLAIMER

By accessing and using the Alberta Energy website to download or otherwise obtain a scanned mineral assessment report, you ("User") agree to be bound by the following terms and conditions:

- a) Each scanned mineral assessment report that is downloaded or otherwise obtained from Alberta Energy is provided "AS IS", with no warranties or representations of any kind whatsoever from Her Majesty the Queen in Right of Alberta, as represented by the Minister of Energy ("Minister"), expressed or implied, including, but not limited to, no warranties or other representations from the Minister, regarding the content, accuracy, reliability, use or results from the use of or the integrity, completeness, quality or legibility of each such scanned mineral assessment report;
- b) To the fullest extent permitted by applicable laws, the Minister hereby expressly disclaims, and is released from, liability and responsibility for all warranties and conditions, expressed or implied, in relation to each scanned mineral assessment report shown or displayed on the Alberta Energy website including but not limited to warranties as to the satisfactory quality of or the fitness of the scanned mineral assessment report for a particular purpose and warranties as to the non-infringement or other non-violation of the proprietary rights held by any third party in respect of the scanned mineral assessment report;
- c) To the fullest extent permitted by applicable law, the Minister, and the Minister's employees and agents, exclude and disclaim liability to the User for losses and damages of whatsoever nature and howsoever arising including, without limitation, any direct, indirect, special, consequential, punitive or incidental damages, loss of use, loss of data, loss caused by a virus, loss of income or profit, claims of third parties, even if Alberta Energy have been advised of the possibility of such damages or losses, arising out of or in connection with the use of the Alberta Energy website, including the accessing or downloading of the scanned mineral assessment report and the use for any purpose of the scanned mineral assessment report so downloaded or retrieved.
- d) User agrees to indemnify and hold harmless the Minister, and the Minister's employees and agents against and from any and all third party claims, losses, liabilities, demands, actions or proceedings related to the downloading, distribution, transmissions, storage, redistribution, reproduction or exploitation of each scanned mineral assessment report obtained by the User from Alberta Energy.

19680140

REPORT ON FIELD EXAMINATION

DEREK L. HOPE

SULPHUR PROSPECTING PERMIT NO. 175

NORTHERN ALBERTA

THIS REPORT HAS BEEN PREPARED
FOR THE EXCLUSIVE USE OF:

Derek L. Hope

COPY NO:.....4.....



EARNSCLIFFE

LINEN BOND

—100% RAG CONTENT—CANADA—

ECONOMIC MINERALS
FILE REPORT No.
S-AF-175(1)

REPORT ON FIELD EXAMINATION
DEREK L. HOPE
SULPHUR PROSPECTING PERMIT NO. 175
NORTHERN ALBERTA

Prepared For
Derek L. Hope
November, 1968

J. C. SPROULE AND ASSOCIATES LTD.
OIL AND GAS ENGINEERING AND GEOLOGICAL CONSULTANTS

REPORT ON FIELD EXAMINATION

DEREK L. HOPE

SULPHUR PROSPECTING PERMIT NO. 175

NORTHERN ALBERTA

The field work on this Permit has been carried out at the request of Mr. W.J. Yoxall acting for Mr. Derek L. Hope. The work was authorized under our letter agreement of August 8, 1968, and the request made was that J.C. Sproule and Associates Ltd. should make a photogeological study of the Permit and collect representative near-surface samples as described in the pertinent paragraph of our August 8th letter. We quote:

"In the first place we have been authorized to proceed initially with a photogeological study of the Permit itself with related geological data which should leave us in a position to present on a photogeological mosaic areas that are likely to contain concentrations of native sulphur. This report would summarize the general prospects in the area with particular respect to those areas indicated on the photomosaics that are worthy of a field geological survey. The next step will be to make use of our geological party (which is already in the field) to study the areas indicated on the photogeological study."

The field work has been conducted by Mr. N. Soul. The field notes describing the samples taken are as follows. We quote:

"Permit No. 175

Area No. 1

Hole No. 1 - N.W. 31-107-15 W. 5 M. Depth, 8 feet.

<u>Sample No.</u>	<u>Depth</u> Ft.	<u>Sulphur</u> %	<u>Sample</u>
175-1-1	4	12.36	Muskeg and lacustrine
175-1-1	8	3.71	Alluvium(?)

Area No. 2

Hole No. 1 - S.E. 29-107-15 W. 5 M. Depth, 8 feet.

<u>Sample No.</u>	<u>Depth</u> Ft.	<u>Sulphur</u> %	<u>Sample</u>
175-2-1	4	Trace	Clay
175-2-1	8	Trace	Clay

Area No. 4

Hole No. 1 - N.W. 33-107-15 W. 5 M. Depth, 8 feet.

<u>Sample No.</u>	<u>Depth</u> Ft.	<u>Sulphur</u> %	<u>Sample</u>
175-4-1	4	16.40	Muskeg and lacustrine
175-4-1	8	Trace	Greenish grey clay

Area No. 5

Hole No. 1 - S.W. 34-107-15 W. 5 M. Depth, 8 feet.

<u>Sample No.</u>	<u>Depth</u> Ft.	<u>Sulphur</u> %	<u>Sample</u>
175-5-1	4	3.18	Muskeg and lacustrine
175-5-1	8	32.16	Sandy clay, <u>sulphurous</u> <u>odour.</u>

Area No. 6

Hole No. 1 N.E. 35-107-15 W. 5 M. Depth, 8 feet.

<u>Sample No.</u>	<u>Depth</u> Ft.	<u>Sulphur</u> %	<u>Sample</u>
175-6-1	4	5.15	Sandy clay
175-6-1	8	Trace	Grey clay

Area No. 7

Hole No. 1 - N.E. 18-107-15 W. 5 M. Depth, 7 feet.

<u>Sample No.</u>	<u>Depth</u> Ft.	<u>Sulphur</u> %	<u>Sample</u>
175-7-1	4	Trace	Dry mud
175-7-1	7	Trace	Dry mud."

The sample locations are given on the accompanying Figure 1 and the related analyses by Chemical and Geological Laboratories Ltd. constitute Appendix I attached hereto.

With reference to these results, it will be observed that samples taken from areas in the northern portion of the subject Permit show sulphur percentages from a trace up to 32.16 percent. The material penetrated was clay, muskeg debris and alluvium.

In view of the results of this preliminary field investigation, we recommend that the portion of the subject Permit, shown on the attached photo-mosaic, be renewed and that a more thorough geological evaluation program be carried out over it. This program should include additional drilling in those areas that show the presence of sulphur, and also the sampling of new untested areas within the Permit. We have the airborne equipment necessary to conduct such studies at minimum cost and would be willing to recommend an exploration program. It is doubtful that such work could be conducted this year, because of the weather conditions. That being the case, it is suggested that you attempt to obtain a postponement of your first-year obligations to enable you to complete your first-year assessment work.

We will be pleased to submit an estimate of the cost of conducting an adequate exploration sampling program over the area recommended for retention at such time as a complete analysis of costs and performance of the past season's operations have been completed.

V.A. Farley *✓*

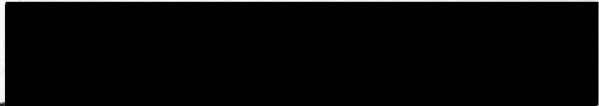

J.C. Sproule, P. Geol.

1009 Fourth Avenue S.W.,
Calgary 2, Alberta.
November 21, 1968.
VAF:JCS:ld1

CHEMICAL & GEOLOGICAL LABORATORIES LTD.

APPENDIX I

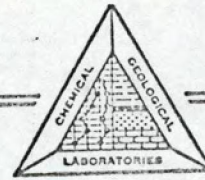
14240-115 AVENUE, EDMONTON, ALBERTA



Date Reported: October 11, 1968

Laboratory Report Number: C68-4168

J. C. SPROULE & ASSOCIATES LTD.

Kind of Sample: Soil

Date Received: October 3, 1968

SAMPLE NUMBER	DEPTH IN FEET	ELEMENTAL SULFUR	
		<u>(% by Weight on Dry Sample)</u>	<u>(% by Weight on Wet Sample)</u>
175-6-1	8	Trace Only	Trace Only

CHEMICAL & GEOLOGICAL LABORATORIES LTD.

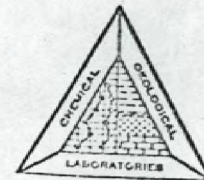

OPERATOR: J. C. SPROULE AND ASSOCIATES LTD.

REPORT NUMBER: C68-4069

DATE SAMPLED: ---

DATE RECEIVED September 18, 1968

DATE REPORTED September 27, 1968

Kind of Sample: Soil for Sulphur Analysis.

LABORATORY NUMBER	SAMPLE NUMBER	DEPTH (Feet)	SULPHUR	
			(% by Weight) Dry Sample	(% by Weight) Wet Sample
C68-4069-1	175-1-1	8	3.71	0.61
C68-4069-2	175-2-1	8	Trace	Trace
C68-4069-3	175-4-1	8	Trace	Trace
C68-4069-4	175-5-1	8	32.16	10.09
C68-4069-5	175-7-1	7	Trace	Trace

CHEMICAL & GEOLOGICAL LABORATORIES LTD.

14240-115 AVENUE, EDMONTON, ALBERTA



Date Reported: October 29, 1968

Laboratory Report Number: C68- 4213-3

J. C. SPROULE & ASSOCIATES LTD.

Kind of Sample: Soil

Date Received: October 18, 1968

<u>SAMPLE NUMBER</u>	<u>DEPTH IN FEET</u>	<u>ELEMENTAL SULFUR (% by Weight on Dry Sample)</u>
175-1-1	4	12.36
175-2-1	4	Trace
175-4-1	4	16.40
175-5-1	4	3.18
175-7-1	4	Trace
175-6-1	4	5.15



SULPHUR PROSPECTING PERMIT No. 175

DEREK LESLIE HOPE,
██████████
CALGARY, ALBERTA.

DATE OF ISSUE — FEBRUARY 21, 1968
AREA — 19,840 ACRES.

84K/8
SE

TP. 107

TP. 106

R. 15

R. 14 W. 5 M.

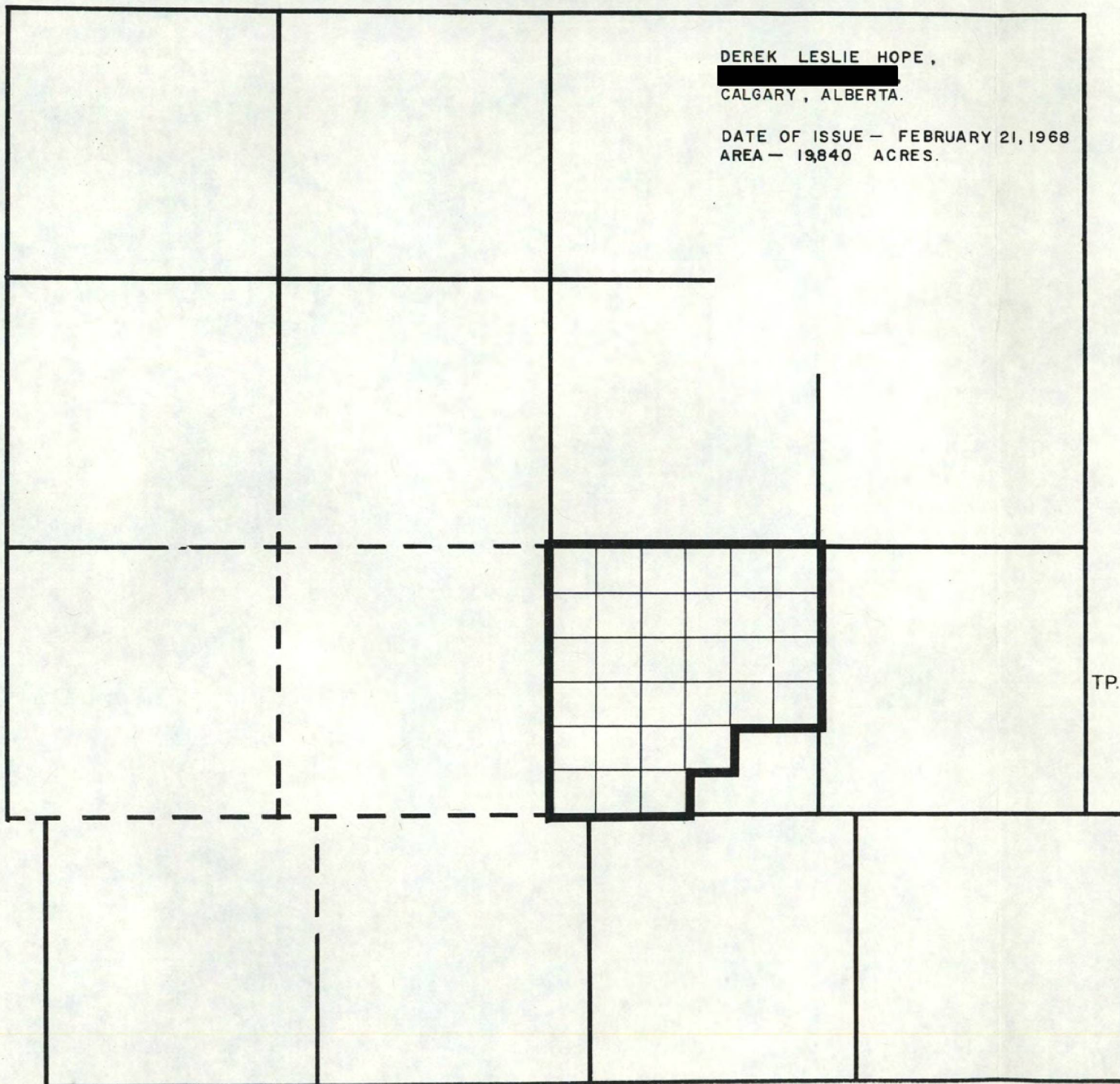

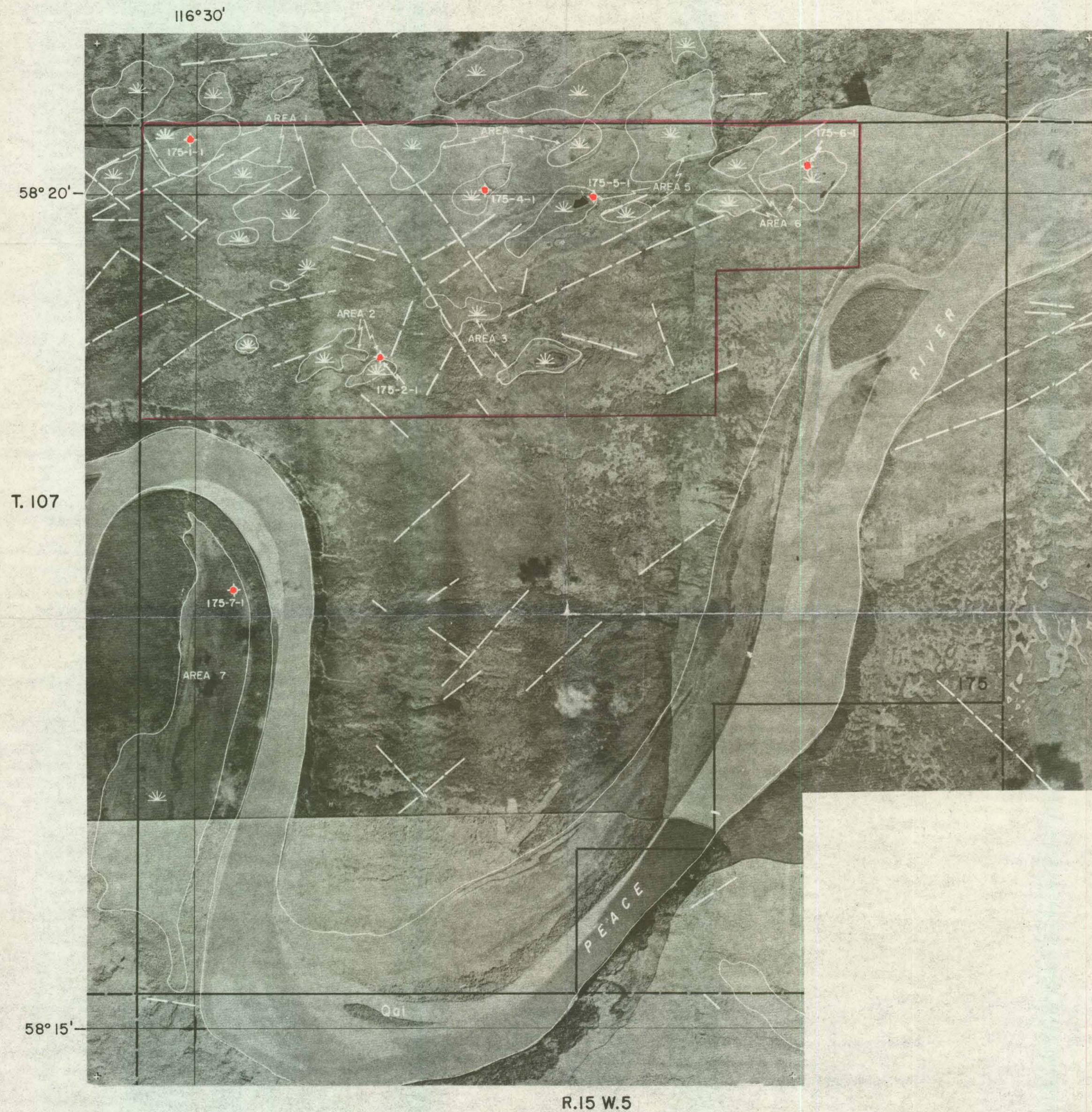

- LEGEND**
- SURFICIAL DEPOSITS**
- Qal Alluvium
 - ☼ Muskeg
- PHOTOGEOLOGICAL SYMBOLS**
- Alignment interpreted to indicate faulting or fracturing in bedrock
 - AREA 1, 2 etc. Areas of interest discussed in report
 - 175 Sulphur prospecting permit outline
 - ◆ Sample Location
 - Area Recommended for Retention

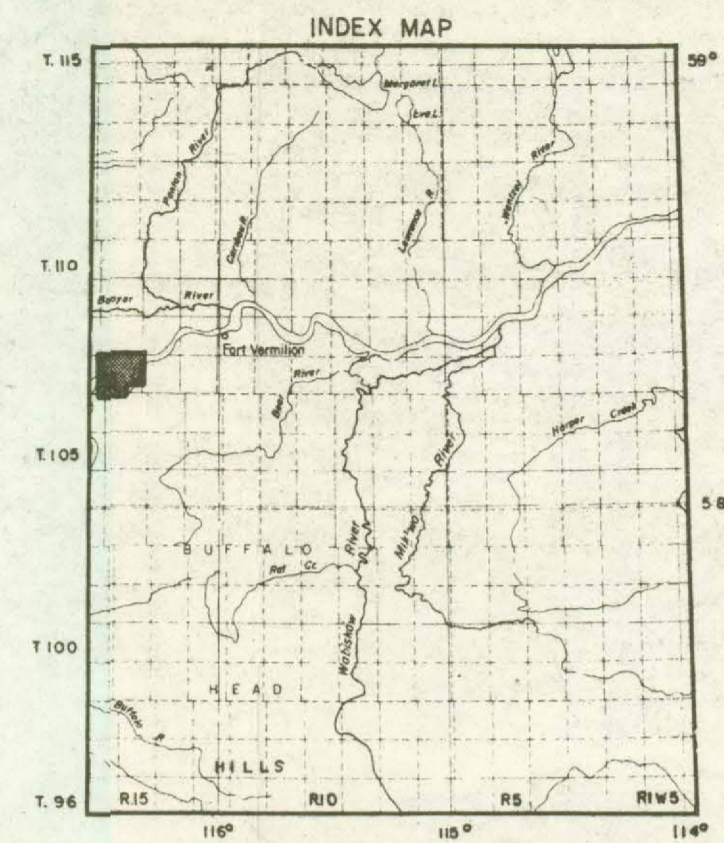

REPRODUCTION OF THIS ILLUSTRATION, OR ANY OF THE INFORMATION ON IT, IN ANY FORM IS PROHIBITED WITHOUT THE WRITTEN AUTHORITY OF J.C. SPROULE AND ASSOCIATES LTD.

**PHOTOGEOLOGICAL MOSAIC
SULPHUR PROSPECTING PERMIT
No. 175
FORT VERMILION AREA
ALBERTA**

PREPARED FOR
DEREK L. HOPE



APPROXIMATE SCALE IN MILES

THIS IS A SEMICONTROLLED MAP-MOSAIC AND SHOULD
NOT BE MISTAKEN FOR AN ACCURATE GEOGRAPHIC BASE

J.C. SPROULE AND ASSOCIATES LTD. CALGARY, ALBERTA