

# MAR 19680126: FORT VERMILION

Received date: Dec 31, 1968

Public release date: Jan 01, 1970

## **DISCLAIMER**

By accessing and using the Alberta Energy website to download or otherwise obtain a scanned mineral assessment report, you ("User") agree to be bound by the following terms and conditions:

- a) Each scanned mineral assessment report that is downloaded or otherwise obtained from Alberta Energy is provided "AS IS", with no warranties or representations of any kind whatsoever from Her Majesty the Queen in Right of Alberta, as represented by the Minister of Energy ("Minister"), expressed or implied, including, but not limited to, no warranties or other representations from the Minister, regarding the content, accuracy, reliability, use or results from the use of or the integrity, completeness, quality or legibility of each such scanned mineral assessment report;
- b) To the fullest extent permitted by applicable laws, the Minister hereby expressly disclaims, and is released from, liability and responsibility for all warranties and conditions, expressed or implied, in relation to each scanned mineral assessment report shown or displayed on the Alberta Energy website including but not limited to warranties as to the satisfactory quality of or the fitness of the scanned mineral assessment report for a particular purpose and warranties as to the non-infringement or other non-violation of the proprietary rights held by any third party in respect of the scanned mineral assessment report;
- c) To the fullest extent permitted by applicable law, the Minister, and the Minister's employees and agents, exclude and disclaim liability to the User for losses and damages of whatsoever nature and howsoever arising including, without limitation, any direct, indirect, special, consequential, punitive or incidental damages, loss of use, loss of data, loss caused by a virus, loss of income or profit, claims of third parties, even if Alberta Energy have been advised of the possibility of such damages or losses, arising out of or in connection with the use of the Alberta Energy website, including the accessing or downloading of the scanned mineral assessment report and the use for any purpose of the scanned mineral assessment report so downloaded or retrieved.
- d) User agrees to indemnify and hold harmless the Minister, and the Minister's employees and agents against and from any and all third party claims, losses, liabilities, demands, actions or proceedings related to the downloading, distribution, transmissions, storage, redistribution, reproduction or exploitation of each scanned mineral assessment report obtained by the User from Alberta Energy.

GALLUP EXPLORATION AND SERVICES LTD.

43 WESTVIEW DRIVE S.W.  
CALGARY - ALBERTA

May 21, 1968

TELEPHONE  
2 4 2 - 5 6 2 8

Government of the Province of Alberta,  
Department of Mines & Resources,  
Administration Building,  
Edmonton, Alberta

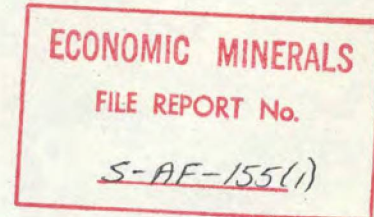

Attention: Mr. J. W. Patrick

Dear Sirs :                    Re: Sulphur Prospect Permits No. 153, 154 & 155  
   Milo Building Company Limited,  
   5359 Calgary Trail, Edmonton, Alberta

The above Permits were acquired to support a prospecting program designed to investigate the nature and value of sulphur occurrences associated with warm sulphurous springs and other sulphur staining in the Fort Vermilion area.

Initially, it was hoped or considered that the source of the sulphur might be the Middle Devonian Elk Point Evaporites. Such a situation would imply a vast source reaching surface along fault fractures with the resultant accumulation covered only by a mantle of drift.

Re-evaluation however, indicates that these sulphurous springs are only seepages of connate sulphurous waters from the Grosmont reef which is here covered, at most, by a thin mantle of glacial material and Cretaceous shales. In deeper valleys, the reef is exposed. Vermilion Chutes are rapids due to the outcrop of the reef in the bed of the Peace River. These seeps are ancient and there may have been some local concentration of sulphur by glacial and recent ground waters, giving misleading high assays. For the most part, the sulphur is contaminated with Cretaceous shales, detritus and glacial material resulting in generally low assays.

With such meagre source and considering the methods of concentration, there can be no resulting sulphur deposits of economic importance. This is particularly true in the face of the vast amounts of sulphur being developed and produced by the petroleum industry.

On the basis of the above, there is no foreseeable market for this sulphur and there is no merit in continuing and/or attempting further development.

Respectfully submitted,

GALLUP EXPLORATION AND SERVICES LTD.



W. B. Gallup, P. Geol.

19680126

# SULPHUR PROSPECTING PERMIT No. 153

MILO BUILDING CO. LTD.,  
5359 CALGARY TRAIL  
EDMONTON, ALBERTA

DATE OF ISSUE - FEBRUARY 7, 1968  
AREA - 39,680 ACRES

TP. 109

84J/5  
SW

TP. 108

TP. 107

R. 12

R. 11

R. 10 W. 5 M.

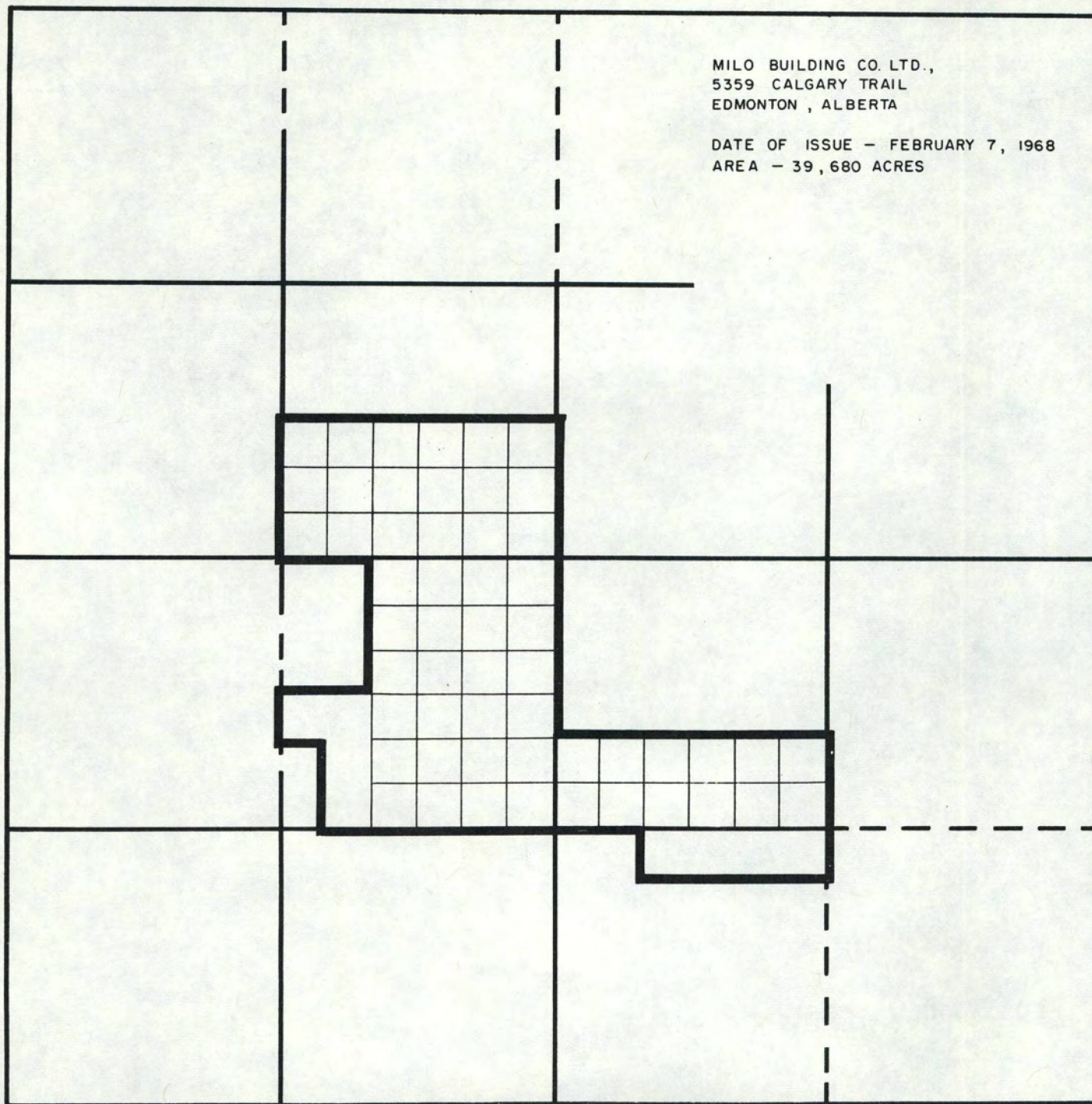

# SULPHUR PROSPECTING PERMIT No. 154

MILO BUILDING CO. LTD.,  
5359 CALGARY TRAIL  
EDMONTON, ALBERTA

DATE OF ISSUE - FEBRUARY 7, 1968  
AREA - 39,680 ACRES

TP. 114

845/14  
NW

TP. 113

TP. 112

R. 9

R. 8

R. 7 W. 5 M.

# SULPHUR PROSPECTING PERMIT No. 155

MILO BUILDING CO. LTD.,  
5359 CALGARY TRAIL  
EDMONTON , ALBERTA

DATE OF ISSUE - FEBRUARY 7, 1968  
AREA - 39,680 ACRES

TP 100

846/10  
NE

TP. 99

R 5

R. 4

R 3 W 5 M