

# MAR 19680062: BIRCH HILLS

Received date: Dec 31, 1968

Public release date: Jan 01, 1970

## **DISCLAIMER**

By accessing and using the Alberta Energy website to download or otherwise obtain a scanned mineral assessment report, you ("User") agree to be bound by the following terms and conditions:

- a) Each scanned mineral assessment report that is downloaded or otherwise obtained from Alberta Energy is provided "AS IS", with no warranties or representations of any kind whatsoever from Her Majesty the Queen in Right of Alberta, as represented by the Minister of Energy ("Minister"), expressed or implied, including, but not limited to, no warranties or other representations from the Minister, regarding the content, accuracy, reliability, use or results from the use of or the integrity, completeness, quality or legibility of each such scanned mineral assessment report;
- b) To the fullest extent permitted by applicable laws, the Minister hereby expressly disclaims, and is released from, liability and responsibility for all warranties and conditions, expressed or implied, in relation to each scanned mineral assessment report shown or displayed on the Alberta Energy website including but not limited to warranties as to the satisfactory quality of or the fitness of the scanned mineral assessment report for a particular purpose and warranties as to the non-infringement or other non-violation of the proprietary rights held by any third party in respect of the scanned mineral assessment report;
- c) To the fullest extent permitted by applicable law, the Minister, and the Minister's employees and agents, exclude and disclaim liability to the User for losses and damages of whatsoever nature and howsoever arising including, without limitation, any direct, indirect, special, consequential, punitive or incidental damages, loss of use, loss of data, loss caused by a virus, loss of income or profit, claims of third parties, even if Alberta Energy have been advised of the possibility of such damages or losses, arising out of or in connection with the use of the Alberta Energy website, including the accessing or downloading of the scanned mineral assessment report and the use for any purpose of the scanned mineral assessment report so downloaded or retrieved.
- d) User agrees to indemnify and hold harmless the Minister, and the Minister's employees and agents against and from any and all third party claims, losses, liabilities, demands, actions or proceedings related to the downloading, distribution, transmissions, storage, redistribution, reproduction or exploitation of each scanned mineral assessment report obtained by the User from Alberta Energy.

SHELL CANADA LIMITED  
REPORT ON  
SULPHUR PROSPECTING PERMIT NO. 68  
BIRCH HILLS AREA, ALBERTA

---

ECONOMIC MINERALS

FILE REPORT No.

S-AF-068(1)

In accordance with the terms of the Agreement dated December 18, 1967, we submit the following report on the exploratory examination carried out during the 1967-68 winter season on the subject permit.

LOCATION:

Sulphur Prospecting Permit No. 68, containing 97,230 acres, is located in Northeastern Alberta, Townships 103 & 104, Ranges 23 & 24 West 4th Meridian.

FIELD OPERATIONS:

Seismic field party 5, operating for Shell Canada Limited, carried out the drilling of 504 seismic shot holes over the permit area during December 1967 and January 1968. The holes, which are spaced 200 feet apart, were drilled to a maximum depth of 60 feet by truck mounted 3-1/2 inch auger drills. Enclosure No. 1 shows the location of the auger holes drilled.

Drillers logs were later examined for indications of sulphur. No sulphur was reported.



O.L. Slind  
District Geologist  
Northern Plains District  
Southern Division Exploration

November 1968

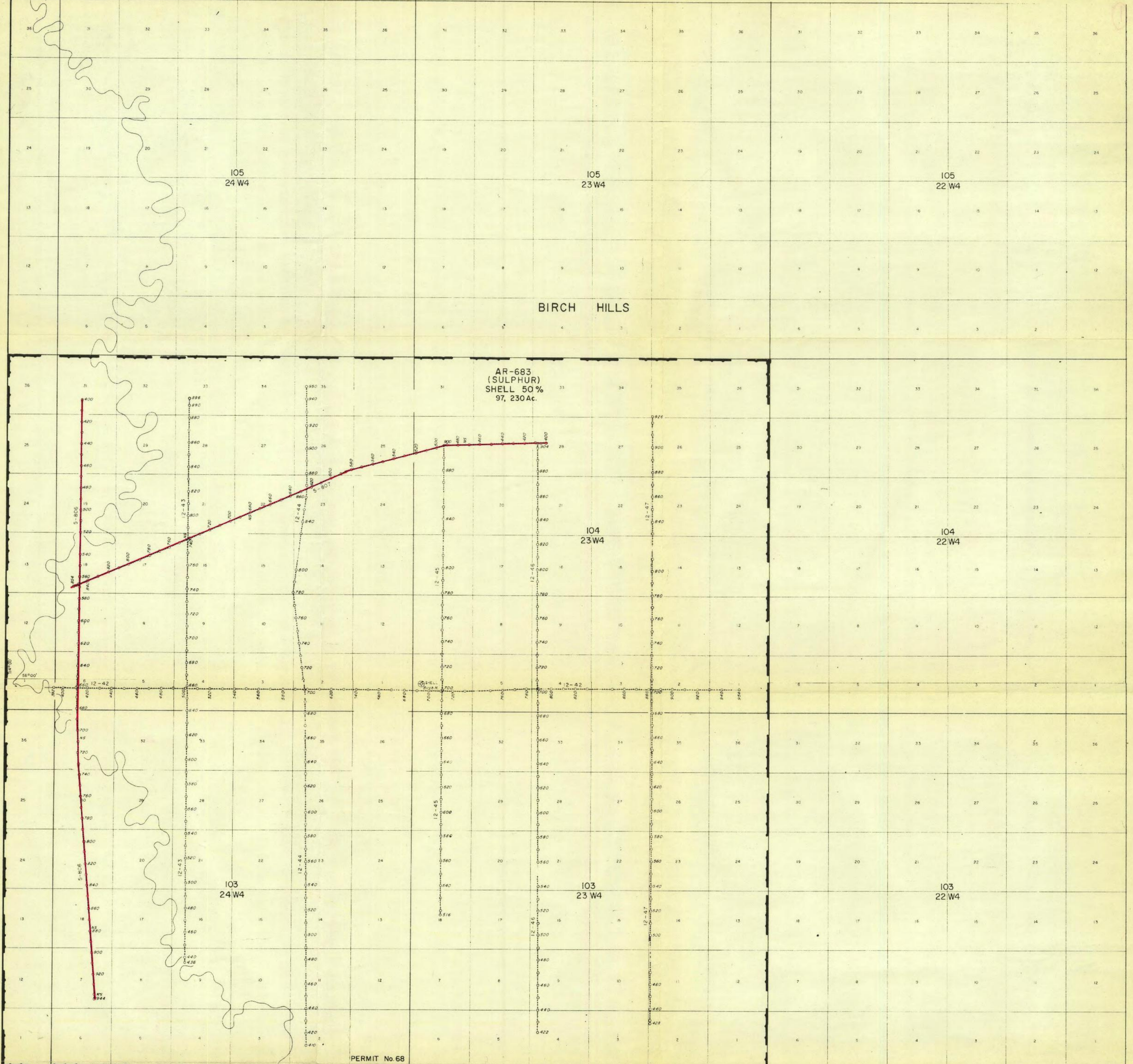

BIRCH HILLS

AR-683  
(SULPHUR)  
SHELL 50%  
97, 230Ac.

PERMIT No. 68

LEGEND

— SEISMIC SHOT HOLE DRILLING EXAMINED FOR SULPHUR

SHELL CANADA LIMITED		EXPLORATION AND PRODUCTION DEPARTMENT	SOUTHERN EXPLORATION DIVISION
BIRCH HILLS AREA			
SULPHUR PROSPECTING PERMIT No. 68			
Party : 5		Datum :	
Interpreter :		Elevation Corr. Velocity :	
Supervisor :		Filter Base ( Corr = 0 ) :	
Date : OCTOBER, 1968		Shot Depths (Ds) :	
Maps :		Wx Comp. :	
Contour Interval :		Load Factor Corr. :	
Wavefront Title & Function :		Grade Key :	
Map Scale : 1"=4000'		Enclosure No. : 1	
To Accompany Report on Sulphur Prospecting Permit No. 68			

# SULPHUR PROSPECTING PERMIT NO 68

SHELL CANADA LIMITED, and  
GREAT PLAINS DEVELOPMENT COMPANY  
OF CANADA, LTD.,  
% SHELL CANADA LIMITED,  
P.O. BOX 100,  
CALGARY, ALBERTA.

DATE OF ISSUE — DECEMBER 18, 1967  
AREA — 97,230 ACRES.

FIFTH MERIDIAN

TP. 104

84/1/4

TP. 103

84/4/13

R. 1 W. 5 M.

R. 25

R. 24

R. 23 W. 4 M.