

MAR 19680060: YATES RIVER

Received date: Dec 31, 1968

Public release date: Jan 01, 1970

DISCLAIMER

By accessing and using the Alberta Energy website to download or otherwise obtain a scanned mineral assessment report, you ("User") agree to be bound by the following terms and conditions:

- a) Each scanned mineral assessment report that is downloaded or otherwise obtained from Alberta Energy is provided "AS IS", with no warranties or representations of any kind whatsoever from Her Majesty the Queen in Right of Alberta, as represented by the Minister of Energy ("Minister"), expressed or implied, including, but not limited to, no warranties or other representations from the Minister, regarding the content, accuracy, reliability, use or results from the use of or the integrity, completeness, quality or legibility of each such scanned mineral assessment report;
- b) To the fullest extent permitted by applicable laws, the Minister hereby expressly disclaims, and is released from, liability and responsibility for all warranties and conditions, expressed or implied, in relation to each scanned mineral assessment report shown or displayed on the Alberta Energy website including but not limited to warranties as to the satisfactory quality of or the fitness of the scanned mineral assessment report for a particular purpose and warranties as to the non-infringement or other non-violation of the proprietary rights held by any third party in respect of the scanned mineral assessment report;
- c) To the fullest extent permitted by applicable law, the Minister, and the Minister's employees and agents, exclude and disclaim liability to the User for losses and damages of whatsoever nature and howsoever arising including, without limitation, any direct, indirect, special, consequential, punitive or incidental damages, loss of use, loss of data, loss caused by a virus, loss of income or profit, claims of third parties, even if Alberta Energy have been advised of the possibility of such damages or losses, arising out of or in connection with the use of the Alberta Energy website, including the accessing or downloading of the scanned mineral assessment report and the use for any purpose of the scanned mineral assessment report so downloaded or retrieved.
- d) User agrees to indemnify and hold harmless the Minister, and the Minister's employees and agents against and from any and all third party claims, losses, liabilities, demands, actions or proceedings related to the downloading, distribution, transmissions, storage, redistribution, reproduction or exploitation of each scanned mineral assessment report obtained by the User from Alberta Energy.

SHELL CANADA LIMITED
REPORT ON
SULPHUR PROSPECTING PERMIT NO. 66
YATES RIVER AREA, ALBERTA

ECONOMIC MINERALS
FILE REPORT No.

S-AF-066(1)

In accordance with the terms of the Agreement dated December 18, 1967, we submit the following report on the exploratory examination carried out during the 1967-68 winter season on the subject permit.

LOCATION:

Sulphur Prospecting Permit No. 66, containing 99,840 acres is located in Northern Alberta, Townships 119 & 120, Ranges 8 to 10, West 5th Meridian.

FIELD OPERATIONS:

Seismic field party 5, operating for Shell Canada Limited, carried out the drilling of 1443 seismic shot holes over the permit area during January 1968. The holes, which are spaced 300 feet apart, were drilled to a maximum depth of 60 feet by truck mounted 3-1/2 inch auger drills. Enclosure No. 1 shows the location of auger holes drilled.

The drillers logs were later examined for indications of sulphur. No sulphur was reported.

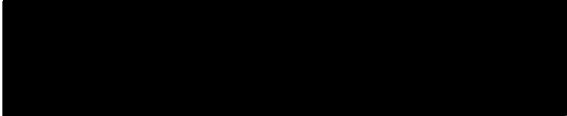
O.L. Slind
District Geologist
Northern Plains District
Southern Division Exploration

November 1968

SULPHUR PROSPECTING PERMIT NO. 66

WESTERN DECALTA PETROLEUM LIMITED,
630 — 6th AVENUE S.W.,
CALGARY, ALBERTA.

DATE OF ISSUE — DECEMBER 18, 1967
AREA — 99,840 ACRES.

TP.120

840/576

TP.119

R.10

R. 9

R. 8 W. 5 M.

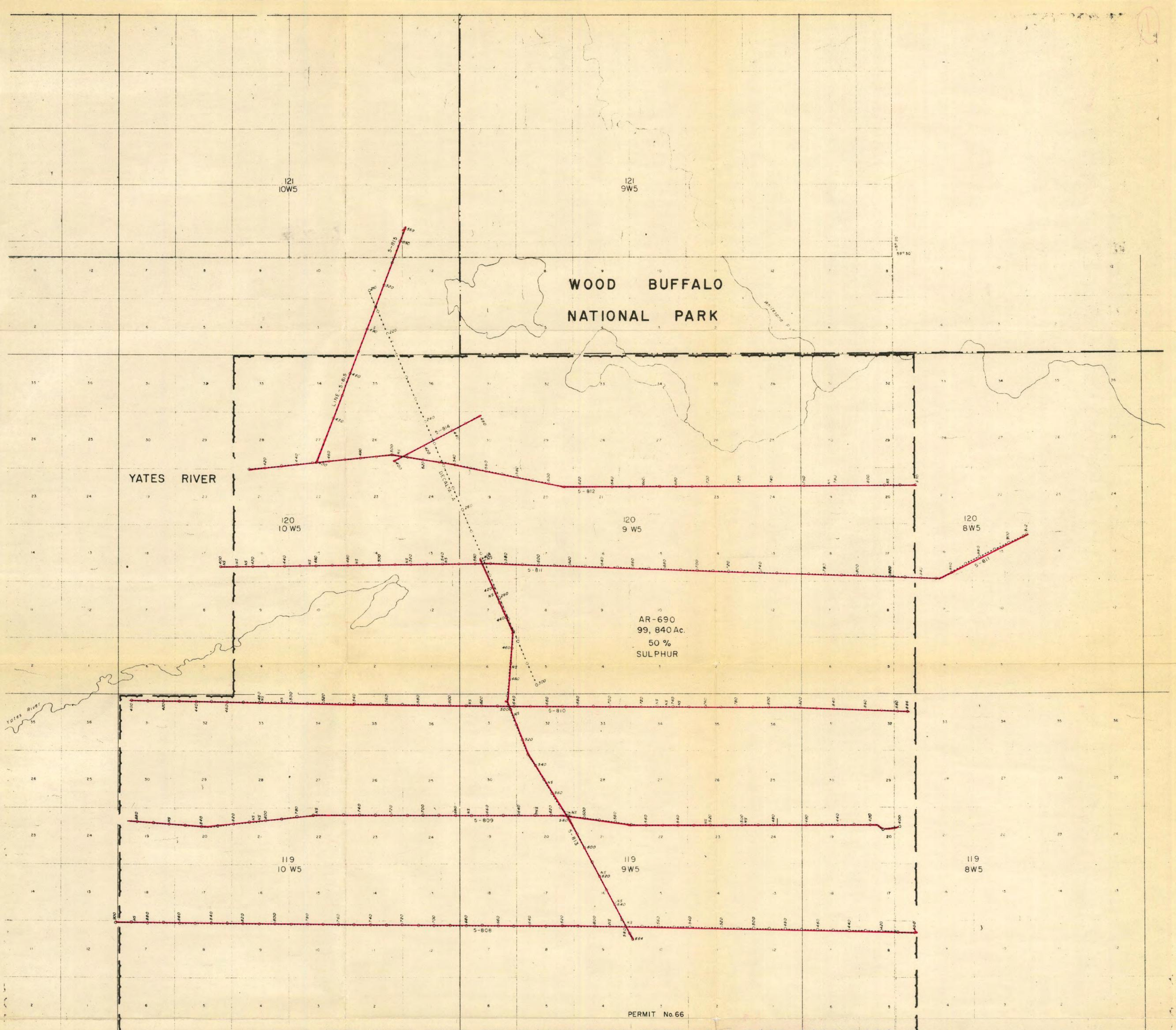

LEGEND

— SEISMIC SHOT HOLE DRILLING EXAMINED FOR SULPHUR

SHELL CANADA LIMITED		EXPLORATION AND PRODUCTION DEPARTMENT		SOUTHERN EXPLORATION DIVISION	
YATES RIVER AREA					
SULPHUR PROSPECTING PERMIT No.66					
Party : 5			Datum :		
Interpreter :			Elevation Corr Velocity :		
Supervisor :			Filter Base (Corr = 0) :		
Date : OCTOBER, 1968			Shot Depths (Ds) :		
Maps :			Wx Comp. :		
Contour Interval :					
Wavefront Title					
B Function :			Load Factor Corr. :		
Map Scale : 1" = 4000'			Grade Key :		
Enclosure No. : 1					
To Accompany Report on Sulphur Prospecting Permit No.66					