

MAR 19640006: SWIFT CREEK

Received date: Dec 31, 1964

Public release date: Jan 01, 1966

DISCLAIMER

By accessing and using the Alberta Energy website to download or otherwise obtain a scanned mineral assessment report, you ("User") agree to be bound by the following terms and conditions:

- a) Each scanned mineral assessment report that is downloaded or otherwise obtained from Alberta Energy is provided "AS IS", with no warranties or representations of any kind whatsoever from Her Majesty the Queen in Right of Alberta, as represented by the Minister of Energy ("Minister"), expressed or implied, including, but not limited to, no warranties or other representations from the Minister, regarding the content, accuracy, reliability, use or results from the use of or the integrity, completeness, quality or legibility of each such scanned mineral assessment report;
- b) To the fullest extent permitted by applicable laws, the Minister hereby expressly disclaims, and is released from, liability and responsibility for all warranties and conditions, expressed or implied, in relation to each scanned mineral assessment report shown or displayed on the Alberta Energy website including but not limited to warranties as to the satisfactory quality of or the fitness of the scanned mineral assessment report for a particular purpose and warranties as to the non-infringement or other non-violation of the proprietary rights held by any third party in respect of the scanned mineral assessment report;
- c) To the fullest extent permitted by applicable law, the Minister, and the Minister's employees and agents, exclude and disclaim liability to the User for losses and damages of whatsoever nature and howsoever arising including, without limitation, any direct, indirect, special, consequential, punitive or incidental damages, loss of use, loss of data, loss caused by a virus, loss of income or profit, claims of third parties, even if Alberta Energy have been advised of the possibility of such damages or losses, arising out of or in connection with the use of the Alberta Energy website, including the accessing or downloading of the scanned mineral assessment report and the use for any purpose of the scanned mineral assessment report so downloaded or retrieved.
- d) User agrees to indemnify and hold harmless the Minister, and the Minister's employees and agents against and from any and all third party claims, losses, liabilities, demands, actions or proceedings related to the downloading, distribution, transmissions, storage, redistribution, reproduction or exploitation of each scanned mineral assessment report obtained by the User from Alberta Energy.

19640006

ECONOMIC MINERALS
FILE REPORT No.
<u>FE-AF-026(10)</u>

IRON PROSPECTING PERMIT

NO. 26

FINAL REPORT

Edmonton, Alberta
May 15th, 1964

N. S. Edgar, P. Eng.

IRON ORE PROSPECTING PERMIT No. 26

FINAL REPORT

Description of Program:

Three test holes were drilled within this permit area. This work was done early in the year 1963.

A plan marked "Appendix A" is included with this report and shows location of these drill holes. Logs of these holes also accompany this report.

↳ Labeled as #1 (in plastic insert).

Discussion of Drilling Results:

Drilling indicated the presence of iron ore in limited areas and thicknesses. Within this permit area topography is rugged and local relief is such that the iron ore bed, where present, is usually covered by several hundred feet of overburden and is thus uneconomic.

A total of \$2,415.00 was spent on this Permit area, this sum includes drilling costs and costs of metallurgical test work.

Conclusion:

This permit area does not warrant further expenditures at this time and accordingly, it is recommended that it should be terminated.

Edmonton, Alberta
May 15, 1964

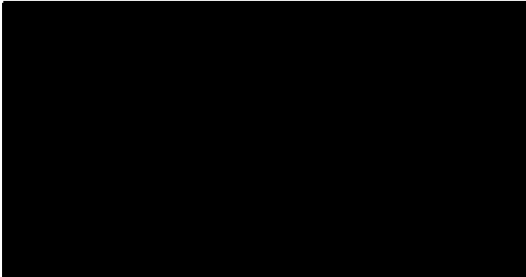

N. S. Edgar, P. Eng.

LOG OF DRILL HOLE NO. 63-1

Location: 2-4-87-2-W6M Elevation Top: 2607 Depth: 50' Page No. 1

Elevation: 2640 Inclination: 90° Date Completed: 14 February '63

Drill Core		Description	Samples		Description
From	To		From	To	
0'	5'	Tan coloured surface clay			
5'	12'	Glacial till			
12'		Bedrock 2628			
12'	33'	Grey clay shales			Lost circ. at 33', added 200' bran.
33'	39'	Rusty red oolitic iron ore			Sampled with riffle-box - much bran. in samples
39'	44'	Dark blue sandy clay shales Some oolitic frags (probably washings)			Ore definite from 33' - 39' (6') However, bottom cut off could be below 39'.
41'9"		2" hard blue shale band			
43'11"		2" hard band (no recovery)			
44'	50'	Soft grey clay shale			
		Bottom of hole at 50' elev. 2590			

Location: NE Corner 16-6-87-2W6 Elevation Top: 2613 Depth: 257' Page No. 1
 Elevation: 2850 Inclination: 90° Date Completed: 16 February '63

Drill Core		Description	Samples		Description
From	To		From	To	
0'	25'	Brown to rusty brown surface mantle			Ore zone is broken & shattered, unoxidized, 50% oolite density, hard. 237' to 247' is definitely ore zone
25'		<u>Bedrock.</u> Elev. 2825			
25'	103'	Soft grey clay shale, at 98'2" hard band			247' to 248.5' drill action suggests ore zone continues to this point, however no cuttings or core recovered for this section.
103'	186'	Grey clay shales with some harder beds at 140' very soft, losing water. at 148' hard, light brown shale at 186', 1/8" hard dark grey shale 1/2" brown coal			
186'	195'	Grey clay shale			
195'	237'	Hard, bedded, clay shale with occas. tiny rounded chert pebble at 197' oyster shell frag.			
237'		Top of ore elev. 2613			
237'	257'	Cored, <u>recovery</u> : 27% in ore section.			
248.5'	257'	Impure, soft silty sandstone grading to gritty clay shale. Bottom of hole at 257' elev. 2593			

Location: 5-33-87-3W6 Elevation Top: 2591 Depth: 140' Page No. 1

Elevation: 2675 Inclination: 90° Date Completed: 21 February 63

Drill Core		Description	Samples		Description
From	To		From	To	
0'	11'	Tan coloured surface clay			Cored, without recovery.
11'		Bedrock elev. 2664			Redrilled and sampled with riffle box.
11'	84'	Grey clay shale, some rust on fracture planes.			
84'		Top of zone elev. 2591			
84'	92'	Soft sand stone with thin beds of chamosite and some sparse oolites. NOT ORE GRADE.			
92'	96'	Dark grey, very fine grained sandstone, hard with chamosite frags.			
96'	99'	Dark, brown - black, very fine-grained sandstone, friable, some chamosite flakes.			
99'	101'	Dark soft uncemented sand			
101'	104'	Sandy clay, plastic			
104'	140"	Grey clay shale with thin harder beds.			
		Bottom of hole at 140'. Elev. 2535.			

DESCRIPTION

IN TOWNSHIP EIGHTY-SIX (86), RANGE TWO (2),
WEST OF THE SIXTH (6) MERIDIAN:

The North East quarter of
Section Nineteen (19), the
North West quarters of Sections
Twenty (20) and Twenty-eight
(28), Section Twenty-nine
(29), the East half of Section
Thirty (30) and Sections Thirty-
one (31), Thirty-two (32) and
Thirty-three (33);

AND

IN TOWNSHIP EIGHTY-SEVEN (87), RANGE TWO (2),
WEST OF THE SIXTH (6) MERIDIAN:

The South half and North West
quarter of Section Four (4),
Sections Five (5), Six (6) and
Seven (7), the South half of
Section Eight (8) and the
South West quarter of Section
Nine (9);

AND

IN TOWNSHIP EIGHTY-SIX (86), RANGE THREE (3),
WEST OF THE SIXTH (6) MERIDIAN:

The North West quarter of Section
Twenty-five (25), the North halves
of Sections Twenty-six (26) and
Twenty-seven (27) and Sections
Thirty-four (34), Thirty-five
(35) and Thirty-six (36);

AND

IN TOWNSHIP EIGHTY-SEVEN (87), RANGE THREE (3),
WEST OF THE SIXTH (6) MERIDIAN:

Sections Twelve (12) to Seventeen
(17) inclusive, Section Twenty (20),
the South half and North West
quarter of Section Twenty-one (21),
the South half of Section Twenty-
two (22), the South West quarter
of Section Twenty-three (23), the
West half of Section Twenty-eight
(28), Section Twenty-nine (29),
the North half of Section Thirty
(30), the South halves of Sections
Thirty-one (31) and Thirty-two (32)
and the South West quarter of
Section Thirty-three (33);

AND

IN TOWNSHIP EIGHTY-SEVEN (87), RANGE FOUR (4),
WEST OF THE SIXTH (6) MERIDIAN:

The North halves of Sections
Twenty-five (25) and Twenty-
six (26), Section Thirty-five
(35) and the South half and
North West quarter of Section
Thirty-six (36);

AND

IN TOWNSHIP EIGHTY-EIGHT (88), RANGE FOUR (4),
WEST OF THE SIXTH (6) MERIDIAN:

The West half of Section One
(1) and Section Two (2);

AND

What would be statutory road
allowances if the lands were
surveyed pursuant to The Alberta
Surveys Act, lying within the
outer limits of the above
described lands;

containing an area of Nineteen Thousand, Four Hundred
and Fifty-three (19,453) acres, more or less.

19640006

88TP.

TP.88

Appendix 'A'
1964 0006 #1
Drill Hole Locations

87TP.

TP.87

86TP.

TP.86

85TP.

TP.85

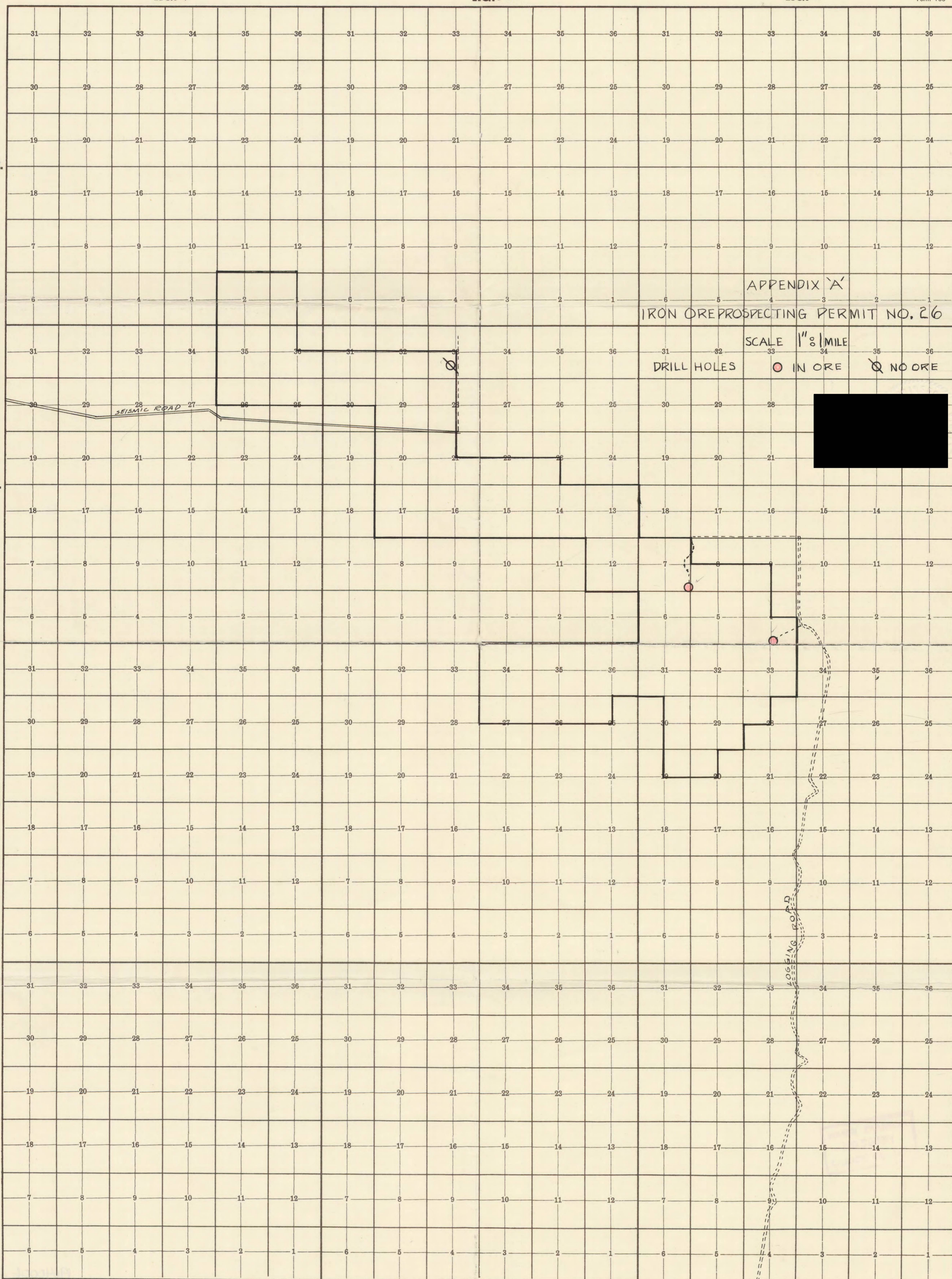

19640006