

# MAR 19570010: DEVIL'S HEAD

Received date: Dec 31, 1957

Public release date: Jan 01, 1959

## **DISCLAIMER**

By accessing and using the Alberta Energy website to download or otherwise obtain a scanned mineral assessment report, you ("User") agree to be bound by the following terms and conditions:

- a) Each scanned mineral assessment report that is downloaded or otherwise obtained from Alberta Energy is provided "AS IS", with no warranties or representations of any kind whatsoever from Her Majesty the Queen in Right of Alberta, as represented by the Minister of Energy ("Minister"), expressed or implied, including, but not limited to, no warranties or other representations from the Minister, regarding the content, accuracy, reliability, use or results from the use of or the integrity, completeness, quality or legibility of each such scanned mineral assessment report;
- b) To the fullest extent permitted by applicable laws, the Minister hereby expressly disclaims, and is released from, liability and responsibility for all warranties and conditions, expressed or implied, in relation to each scanned mineral assessment report shown or displayed on the Alberta Energy website including but not limited to warranties as to the satisfactory quality of or the fitness of the scanned mineral assessment report for a particular purpose and warranties as to the non-infringement or other non-violation of the proprietary rights held by any third party in respect of the scanned mineral assessment report;
- c) To the fullest extent permitted by applicable law, the Minister, and the Minister's employees and agents, exclude and disclaim liability to the User for losses and damages of whatsoever nature and howsoever arising including, without limitation, any direct, indirect, special, consequential, punitive or incidental damages, loss of use, loss of data, loss caused by a virus, loss of income or profit, claims of third parties, even if Alberta Energy have been advised of the possibility of such damages or losses, arising out of or in connection with the use of the Alberta Energy website, including the accessing or downloading of the scanned mineral assessment report and the use for any purpose of the scanned mineral assessment report so downloaded or retrieved.
- d) User agrees to indemnify and hold harmless the Minister, and the Minister's employees and agents against and from any and all third party claims, losses, liabilities, demands, actions or proceedings related to the downloading, distribution, transmissions, storage, redistribution, reproduction or exploitation of each scanned mineral assessment report obtained by the User from Alberta Energy.

Permit <sup>12</sup> - Exploration  
Report

ECONOMIC MINERALS
FILE REPORT No.
EE-AE-012(01)

1957000

DETAILS OF EXAMINATION

Examination of the lease up to the present time has shown only small deposits of iron ore.

Some drilling and trenching has been carried out in the lower regions and more drilling is to be done in the future.

Several trips were made out to the lease and much of the territory was covered, studying the formations and collecting samples for assaying.

During the balance of our permit we plan to make a survey using a ground magnetometer, as not much sight prospecting can be done during the winter months.

Attached hereto are sketches of approximate locations of drill holes and trenchings.

#12

SKETCH OF

TOWNSHIP No. 27 RANGE 9 WEST OF 5<sup>th</sup> MERIDIAN.

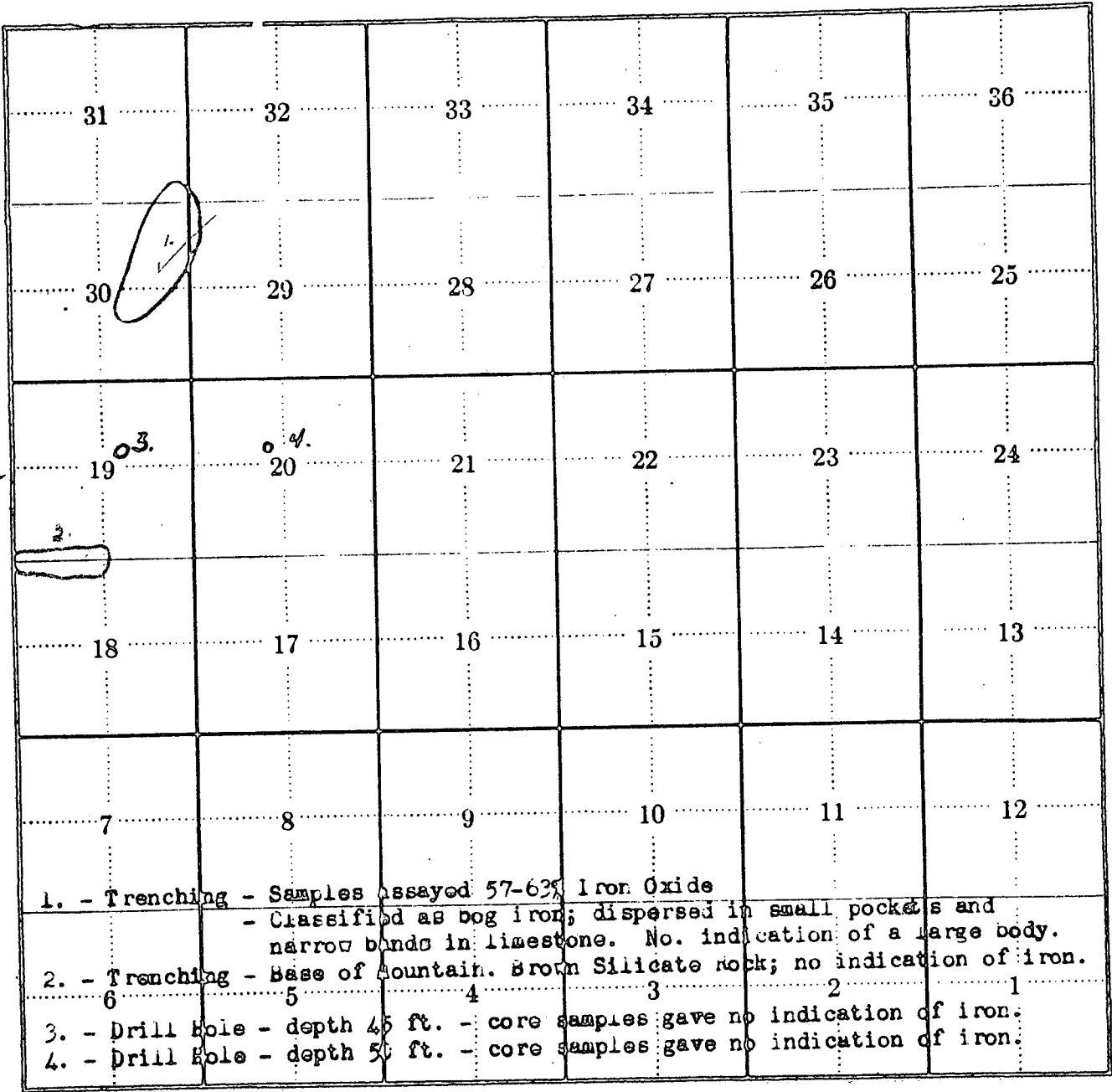

\*12

SKETCH OF  
TOWNSHIP No. 28 RANGE 10 WEST OF 5<sup>th</sup> MERIDIAN.

31	32	33	34	35	36
30	29	28	27	26	25
19	20	21	22	23	24
18	17	16	15	14	13
7	8	9	10	11	12
6	5	4	3	2	1

8 - Trenching - banded formation of green and brown silicate rock.  
 Samples assayed very low in iron.



- INDICATES AREAS FROM WHICH SAMPLES WERE TAKEN

### SKETCH OF

TOWNSHIP No. 27 RANGE 9 WEST OF 5th MERIDIAN.

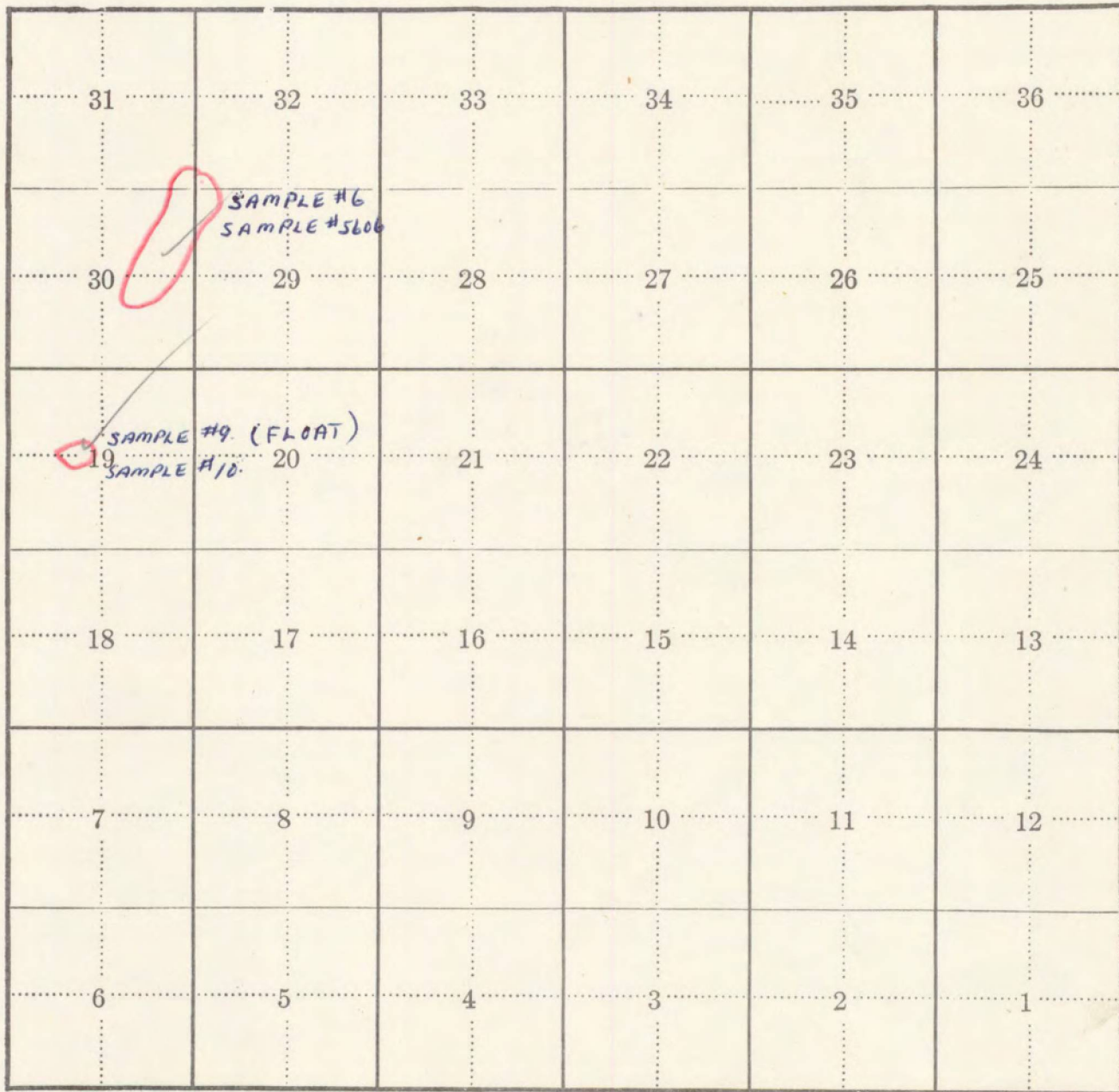

SAMPLES #6 & 5606 - HIGH ASSAYS, TAKEN FROM S. E. SLOPE OF DEVIL'S HEAD MT.  
 ELEVATION APPROXIMATELY 6,000 FT. - ACCESSIBLE ONLY ON FOOT  
 NO INDICATIONS OF A LARGE BODY.

0 -

INDICATES AREAS FROM WHICH SAMPLES WERE TAKEN

### SKETCH OF

TOWNSHIP No. 27 RANGE 10 WEST OF 5th MERIDIAN.

31	32	33	34	35	36 SAMPLE #7 (FLOAT)
30	29	28	27	26 SAMPLE #21 (FLOAT)	25
19	20	21	22	23 SAMPLE #3	24 SAMPLE #5657 (FLOAT)
18	17	16	15	14	13
7	8	9	10	11	12
6	5	4	3	2	1

○ - INDICATES AREAS FROM WHICH SAMPLES WERE TAKEN

SKETCH OF  
TOWNSHIP No. 28 RANGE 9 WEST OF 5th MERIDIAN.

31	32	33	34	35	36
○ 30 SAMPLE #5674	29	28	27	26	25
19	20	21	22	23	24
18	17	16	15	14	13
7	8	9	10	11	12
6	5	4	3	2	1

○ - INDICATES AREAS FROM WHICH SAMPLES WERE TAKEN

SKETCH OF  
 TOWNSHIP No. 28 RANGE 10 WEST OF 5th MERIDIAN.

31	32	33	34	35	36
30	29	28	27	26	25
19	20	21	22	23	24
18	17	16	15	14	13
7	8	9	10	11	12
6	5	4	3	2	1

*SAMPLE #8*  
*SAMPLE #16.*



MAGNETOMETER SURVEY

IRON PROSPECTING PERMIT #12

SKETCH OF

TOWNSHIP No. 27. RANGE 9. WEST OF 5th MERIDIAN.

31	32	33	34	35	36
30	29 20 19 18 17 16 15 14	28	27	26	25
19 11 10 9 8 7 6	20 13 12 5 4 3 2 1	21	22	23	24
18	17	16	15	14	13
7	8	9	10	11	12
6	5	4	3	2	1

19570010

# Provincial Institute of Technology and Art

PHONE



871550

EDUCATION BUILDING  
13TH AVENUE AND 10TH STREET N.W.  
CALGARY — ALBERTA

January 23, 1956

Ore Sample

Submitted by Perfection Machine Works Ltd.,

Laboratory Number 5606.

## Quantitative Analysis

Iron Oxide ( $\text{Fe}_2\text{O}_3$ ) ----- 63.64%

Yours truly,

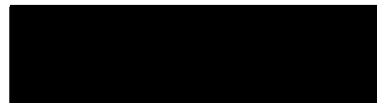

N. Safran, M.Sc.

NS/rb

# Provincial Institute of Technology and Art

PHONE



871559

EDUCATION BUILDING  
13TH AVENUE AND 10TH STREET N.W.  
CALGARY — ALBERTA

May 18, 1956

Ore Sample,

Submitted by Perfection Machine Works Ltd.,

Laboratory Number 5657

## Qualitative Analyses

Yellow section of ore.....chromium  
present

Light section of ore.....chromium  
present in  
smaller concentration

Yours truly,



N. Safran/sf

N. Safran, M. Sc.

# Provincial Institute of Technology and Art

PHONE



871559

EDUCATION BUILDING  
13TH AVENUE AND 10TH STREET N.W.  
CALGARY — ALBERTA

August 15th, 1956.

Ore Sample

Submitted by Perfection Machine Works Ltd.,

Laboratory Number 5674.

## Qualitative Tests

Chromium.....Trace

Manganese.....Negative

## Quantitative Tests

Silica,  $\text{SiO}_2$ .....88.60%

Iron Oxide,  $\text{Fe}_2\text{O}_3$ .....8.06%

Aluminum Oxide,  $\text{Al}_2\text{O}_3$ .....3.24%

Yours truly,



NS :m

N. Safran, M. Sc.

ORE SAMPLE #3

SUBMITTED BY R. RENN

QUANTITATIVE TEST

Iron ( $\text{Fe}_2\text{O}_3$ ) . . . . . 14.36%

August 24th, 1956.

A. Renn

ORE SAMPLE #6

R. RENN

QUANTITATIVE TEST

Iron ( $\text{Fe}_2\text{O}_3$ ) . . . . . 56.68%

August 24th, 1956.

A. Renn

SAMPLE #7

SUBMITTED BY R. RENN

QUALITATIVE TESTS

Iron ( $\text{Fe}_2\text{O}_3$ ) . . . . . Present  
in small amounts.

Copper . . . . . Present

August 30th, 1956

A. Renn

SAMPLE #8

SUBMITTED BY R. RENN

QUALITATIVE TESTS

Iron ( $\text{Fe}_2\text{O}_3$ ) . . . . .	Present in small amounts
Titanium . . . . .	Trace

September 6th, 1957

A. Renn



SAMPLE #9

SUBMITTED BY R. RENN

QUANTITATIVE TEST

Iron ( $\text{Fe}_2\text{O}_3$ ) . . . . . 16.32%

September 13th, 1956

A. Renn

SAMPLE # 10

SUBMITTED BY R. RENN

QUANTITATIVE TEST

Iron ( $\text{Fe}_2\text{O}_3$ ) . . . . .14.94%

October 29th, 1956.

A. Renn

SAMPLE #16

SUBMITTED BY R. RENN

QUALITATIVE TESTS

Chromium . . . . . Negative  
Iron . . . . . Present  
  in small amounts.

A. Renn

October 23rd, 1956.

SAMPLE #21

SUBMITTED BY R. RENN

QUANTITATIVE TEST

Iron ( $\text{Fe}_2\text{O}_3$ ) . . . . . 38.68%

January 3rd, 1957.

A. Renn

MAGNETOMETER SURVEY

IRON PROSPECTING PERMIT #12 - R. Renn

DATE OF SURVEY - AUGUST 25th, 1957.

<u>STATION</u>	<u>READINGS (in gammas)</u>
1.	418
2.	530
3.	530
4.	495
5.	502.5
6.	405
7.	485
8.	502.5
9.	450
10.	455
11.	447.5
12.	535.5
13.	540
14.	548.5
15.	534
16.	545
17.	562
18.	560.5
19.	557
20.	562.5

820/6

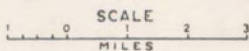

# IRON PROSPECTING PERMIT No. 12

REYNOLD RENN,  
% PERFECTION MACHINE WORKS LTD.  
34th AVENUE AND BLACKBURN ROAD,  
CALGARY, ALBERTA.

DATE OF ISSUE — JUNE 20, 1956.  
AREA — 20,000 ACRES.

TP. 29

TP 28

TP 27

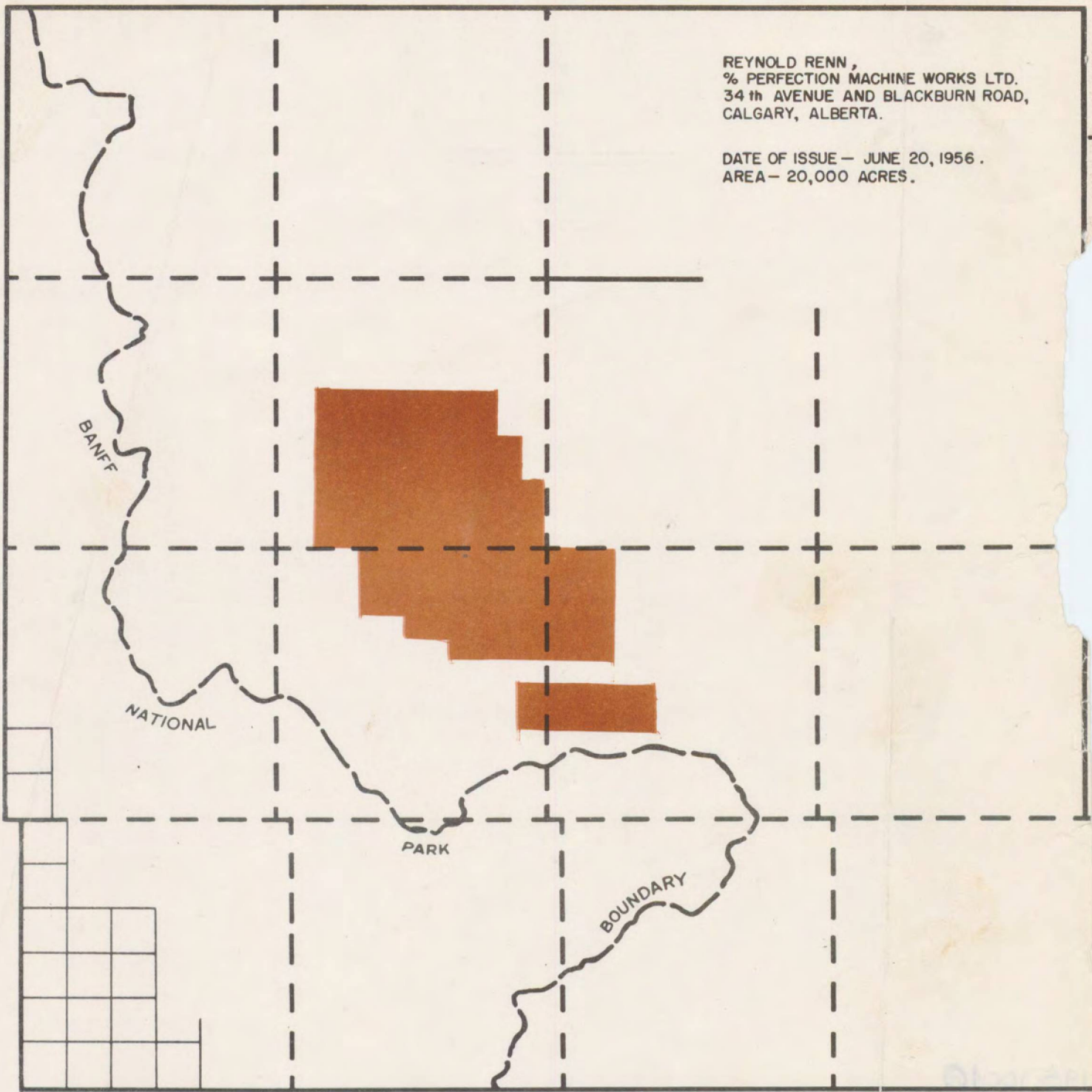

BANFF

NATIONAL

PARK

BOUNDARY

R. 11

R. 10

R. 9

R. 8 W. 5 M.